

U. S. Department of Agriculture
FOREST SERVICE

A-3
J. Stebbins

Chippewa NATIONAL FOREST
CORNERS OF THE PUBLIC SURVEY

T. 141 & 142 N R. 28 W 5th Mer.

----- 14 Corner common to Sections
-----, -----, 31, and 6-----

Corner consists of a By cap 1" pipe (not) in place
State condition good

Dimensions above ground 12" inches

Sketch grooves, letters, figures, or notches, on proper face or edge.

CARDINAL POSITION

DIAGONAL POSITION

--	--	--	--

--	--	--	--

N W S E NW SW SE NE

Mound of ----- is located -----

Pits are located -----

Sketch markings of Bearing Trees (or Rocks) in proper box and fill blanks below, giving bearings from Corner to Trees and Distances in Links.

<u>1/4 531</u>			
<u>B.T.</u>			

Species Elm -----

Diameter 14" -----

Bearing N 57° W -----

Distance 29.4 -----

Do you believe this to be a genuine Land Office Corner? Yes

If not, why? -----

David Rose J.
(Signature)

Nov. 25, 35
(Date)

Estimator
(Title)

A-3

UNITED STATES GEOLOGICAL SURVEY
BUREAU OF GEOGRAPHIC NAMES
WASHINGTON, D. C.

1918
1531
1536

Another 2" pipe next to G.L.D.
Corner again.

Give any further facts which will aid in finding the
chain distant.
from which this Corner bears S 57° E
side of tree
tree 14 inches diameter, on the S E
Metal Location Poster is on a Elm

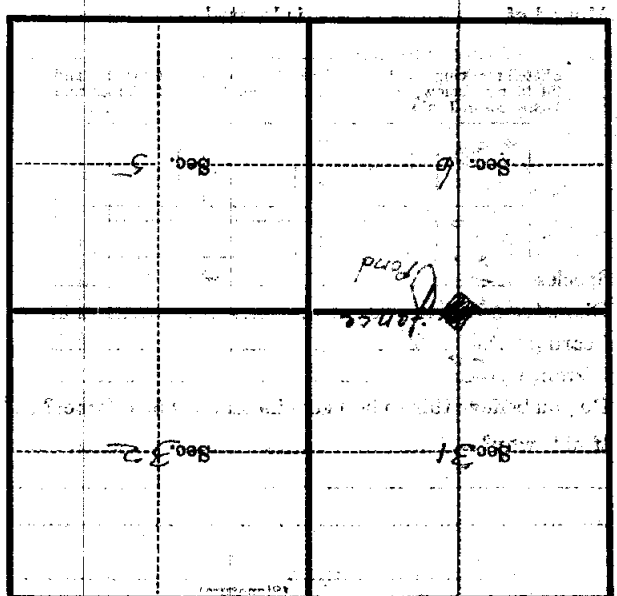

(Make sketch of topography near Corner)