

U. S. Department of Agriculture

FOREST SERVICE

Chip. Pat. NATIONAL FOREST

CORNERS OF THE PUBLIC SURVEY

T. 141 R. 29/28 5th Mer.

Section Corner common to Sections 25, 30, 36, and 31

Corner consists of a 2" Iron Pipe in place

State condition Bent over

Dimensions above ground 1 1/4 ft

Sketch grooves, letters, figures, or notches, on proper face or edge.

CARDINAL POSITION

DIAGONAL POSITION

N	W	S	E

NW	SW	SE	NE

Mound of is located

Pits are located

Sketch markings of Bearing Trees (or Rocks) in proper box and fill blanks below, giving bearings from Corner to Trees and Distances in Links.

Species

Diameter

Bearing

Distance

Do you believe this to be a genuine Land Office Corner? No

If not, why? G. L. O. corner believed first that under Road bed.

Signature: O. H. Johnson, Date: 3/21/35, Title: Eng

Section 36

Section 30

Range 4172 Road.

Corner in center of Corner again.

Give any further facts which will aid in finding this chains distant.

1.34

from which this Corner bears North

side of Harker's Road

inches diameter, on the South

Metal Location Poster is on a Telephone post

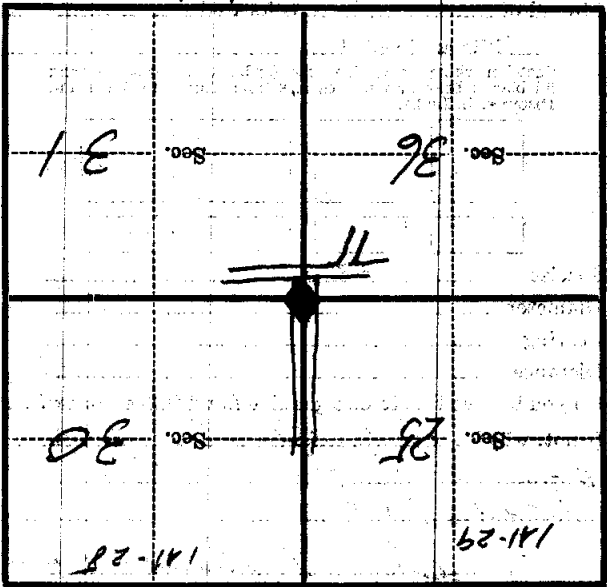

(Make sketch of topography near Corner)

T. 141 R. 29/28 S. 15 V-1 Mer.