

U. S. Department of Agriculture  
FOREST SERVICE

2-7,8

~~CHIPPEWA~~ NATIONAL FOREST

CORNERS OF THE PUBLIC SURVEY

T. 141 R. 27 5 Mer.

M.C. Corner common to Sections

, 32, and

Corner consists of a pipe (not) in place

State condition good

Dimensions above ground 24 inches

Sketch grooves, letters, figures, or notches, on proper face or edge.

CARDINAL POSITION

DIAGONAL POSITION

--	--	--	--

N W S E

--	--	--	--

NW SW SE NE

Mound of is located

Pits are located

Sketch markings of Bearing Trees (or Rocks) in proper box and fill blanks below, giving bearings from Corner to Trees and Distances in Links.

M.C.			
------	--	--	--

B.T.			
------	--	--	--

Species Cedar

Diameter 10"

Bearing SSW

Distance 20

Do you believe this to be a genuine Land Office Corner? NO

If not, why? County Corner

*RAYMOND T. DEFANT*  
RAYMOND T. DEFANT  
(Signature)

Jr. Engineer

(Title)

7-3-40

(Date)

Corner again.  
Corner between lake and curve in road

Give any further facts which will aid in finding this

chains distant.

20

from which this Corner bears

N 50 E

side of tree

tree 10 inches diameter, on the N

Metal Location Poster is on a Cedar

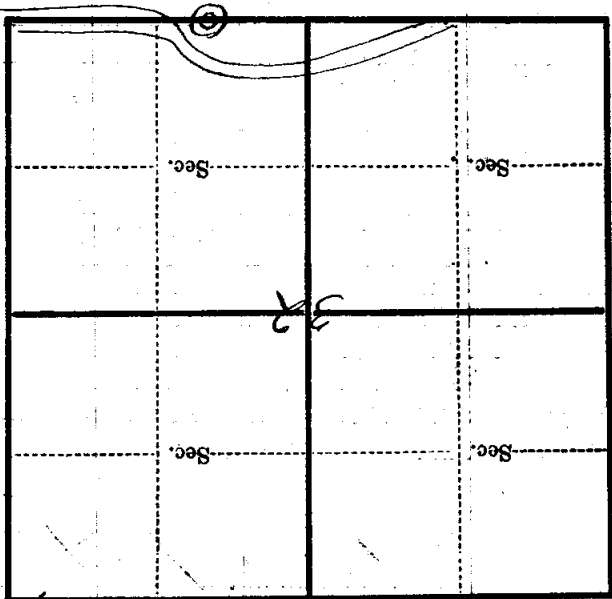

(Make sketch of topography near Corner)

Z-7,8

T. 141 R. 27 S. 5 Mer.