

U. S. Department of Agriculture
FOREST SERVICE

R-23

Chippewa NATIONAL FOREST

CORNERS OF THE PUBLIC SURVEY

T. 141 R. 27 S. 5 Mer.

1/4 Corner common to Sections
24, and 25

Corner consists of a pipe (not) in place
State condition good

Dimensions above ground 6 inches
Sketch grooves, letters, figures, or notches, on proper face or edge.

CARDINAL POSITION

DIAGONAL POSITION

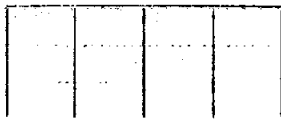

N W S E



NW SW SE NE

Mound of _____ is located _____

Pits are located _____

Sketch markings of Bearing Trees (or Rocks) in proper box and fill blanks below, giving bearings from Corner to Trees and Distances in Links.



Species _____

Diameter _____

Bearing _____

Distance _____

Do you believe this to be a genuine Land Office Corner? NO

If not, why? county corner

R. T. DeFaut

R. T. DeFaut
(Signature)

J. E.

(Title)

11-9-40

(Date)

Dotted lines for writing notes.

Corner again.

Give any further facts which will aid in finding this

chains distant.

.12

from which this Corner bears

SM

side of tree

tree 8 inches diameter, on the

SM

Metal Location Poster is on a

Ash

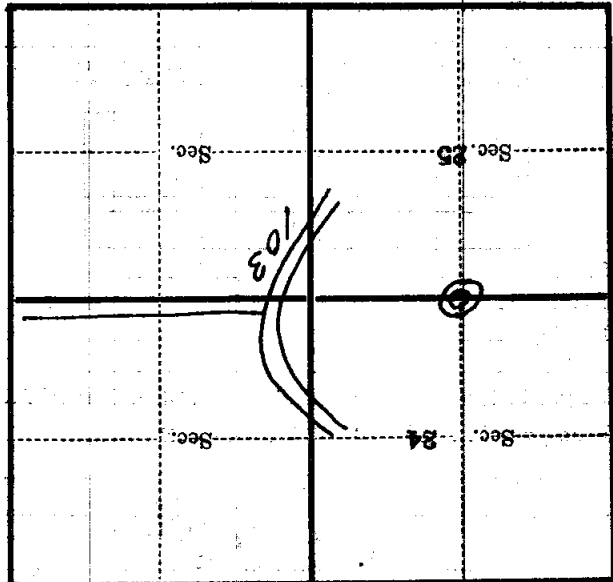

(Make sketch of topography near Corner)

R-23