

U. S. Department of Agriculture  
FOREST SERVICE

X-9

Chippewa NATIONAL FOREST

CORNERS OF THE PUBLIC SURVEY

T. 141 R. 26 5 Mer.

$\frac{1}{4}$  Corner common to Sections  
32, and 33

Corner consists of a post ~~tree~~ in place  
State condition poor

Dimensions above ground 30 inches

Sketch grooves, letters, figures, or notches, on proper face or edge.

CARDINAL POSITION

DIAGONAL POSITION

	S 32		S 33
N	$\frac{1}{4}$	S	$\frac{1}{4}$
W		E	

NW	SW	SE	NE

Mound of \_\_\_\_\_ is located \_\_\_\_\_

Pits are located \_\_\_\_\_

Sketch markings of Bearing Trees (or Rocks) in proper box and fill blanks below, giving bearings from Corner to Trees and Distances in Links.

Species \_\_\_\_\_

Diameter \_\_\_\_\_

Bearing \_\_\_\_\_

Distance \_\_\_\_\_

Do you believe this to be a genuine Land Office Corner? **NO**

If not, why? County Corner

*Raymond T. DeBant*  
RAYMOND T. DEBANT

(Signature)

Jr. Civil Engineer

(Title)

7-3-40

(Date)

Metal Location Poster is on a post  
 tree inches diameter, on the East  
 side of road  
 from which this Corner bears West  
 27 chains distant.  
 Give any further facts which will aid in finding this  
 Corner again.

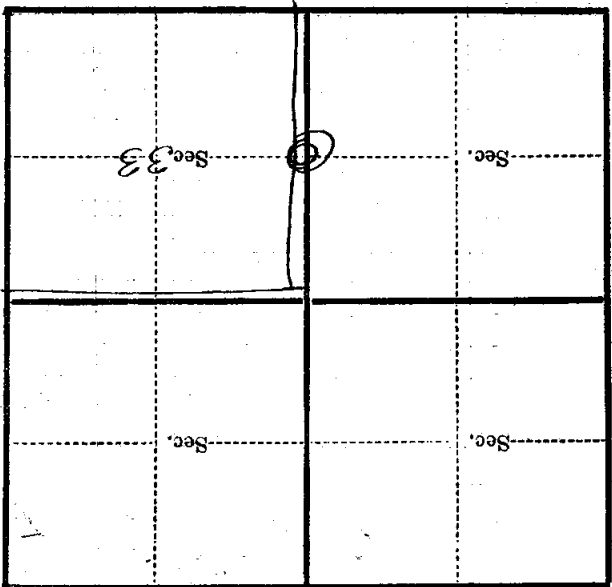

(Make sketch of topography near Corner)

U. S. Department of Agriculture  
FOREST SERVICE

X-9

Chippewa NATIONAL FOREST

CORNERS OF THE PUBLIC SURVEY

T. 141 R. 26 S. 5 Mer.

1/2 Corner common to Sections  
32, and 33

Corner consists of a post set in place  
State condition poor

Dimensions above ground 20 Inches  
Sketch grooves, letters, figures, or notches, on proper face or edge.  
CARDINAL POSITION DIAGONAL POSITION

	S 32 1/2		S 33 1/2				
N	W	S	E	NW	SW	SE	NE

Mound of \_\_\_\_\_ is located \_\_\_\_\_

Pits are located \_\_\_\_\_

Sketch markings of Bearing Trees (or Rocks) in proper box and fill blanks below, giving bearings from Corner to Trees and Distances in Links.

Species \_\_\_\_\_  
Diameter \_\_\_\_\_  
Bearing \_\_\_\_\_  
Distance \_\_\_\_\_

Do you believe this to be a genuine Land Office Corner? NO

If not, why? County Corner

*R. T. Devant*  
RAYMOND T. DEVANT  
(Signature)  
Jr. Civil Engineer

7-3-40

(Date)

(Title)

Metal Location Poster is on a **post**

tree **east** inches diameter, on the **road**

side of **road** from which this Corner bears **west**

**27** chains distant.

Give any further facts which will aid in finding this Corner again.

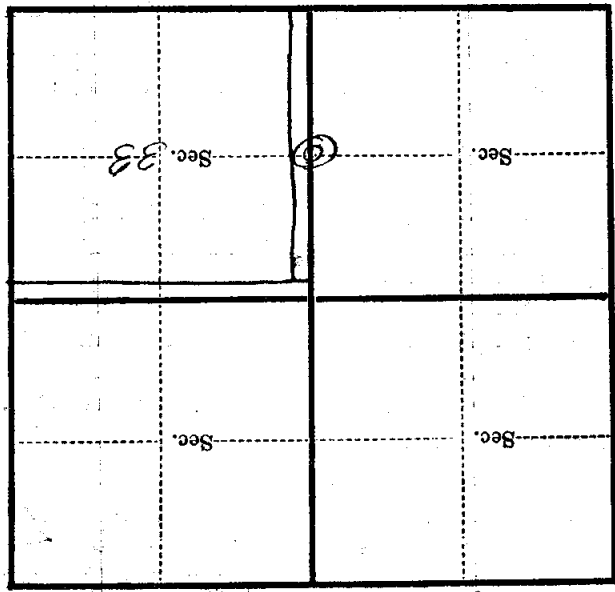

(Make sketch of topography near Corner)