

U. S. Department of Agriculture
FOREST SERVICE

47

CHIPPEWA NATIONAL FOREST

CORNERS OF THE PUBLIC SURVEY

T. 141 R. 25 5 Mer.
Center 1/2 Corner ~~XXXXXX~~ to Sections

17, and
Corner consists of a Iron Pipe ~~ONE~~ in place
State condition Very Good

Dimensions above ground 18" inches
Sketch grooves, letters, figures, or notches, on proper face or edge.
CARDINAL POSITION DIAGONAL POSITION

N	W	S	E

C	1/2	17	S
NW	SW	SE	NE

Mound of _____ is located _____

Pits are located _____

Sketch markings of Bearing Trees (or Rocks) in proper box and fill blanks below, giving bearings from Corner to Trees and Distances in Links.

Species No B. T.'s.

Diameter _____

Bearing _____

Distance _____

Do you believe this to be a genuine Land Office Corner? No.

If not, why? County Corner

Raymond T. DeFant

Raymond T. DeFant

(Signature)

1-23-40

(Date)

Jr. Civil Engineer

(Title)

Corner again.
 Give any further facts which will aid in finding this
 3.005
 from which this Corner bears
 side of
 tree 37 inches diameter, on the
 Metal Location Poster is on a Dead Tamarac

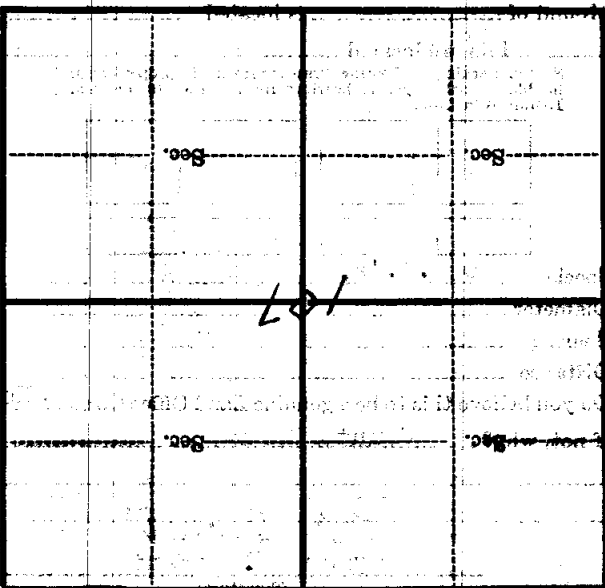

(Make sketch of topography near Corner)

L-7

CHIPPWA NATIONAL FOREST

CORNERS OF THE PUBLIC SURVEY

T. 141 R. 85 S. 8 Mer.

Center $\frac{1}{2}$

Corner ~~marked~~ to Sections

17, and

Corner consists of a Iron Pipe (in place)

State condition Very Good

Dimensions above ground 10" inches

Sketch grooves, letters, figures, or notches, on proper face or edge.

CARDINAL POSITION

DIAGONAL POSITION

N	W	S	E

0	$\frac{1}{2}$	17	8
NW	SW	SE	NE

Mound of _____ is located _____

Pits are located _____

Sketch markings of Bearing Trees (or Rocks) in proper box and fill blanks below, giving bearings from Corner to Trees and Distances in Links.

No B.T.'s.

Species _____

Diameter _____

Bearing _____

Distance _____

Do you believe this to be a genuine Land Office Corner? No.

If not, why? County Corner

Raymond T. DeFaut
Raymond T. DeFaut

1-25-40

Jr. Civil Engineer

(Date)

(Title)

CORNERS OF THE PUBLIC SURVEY

Corner again.

Give any further facts which will aid in finding this

corner distant

from which this corner bears

side of

tree 8 1/2 inches diameter, on the

Metal Location Poster is on a

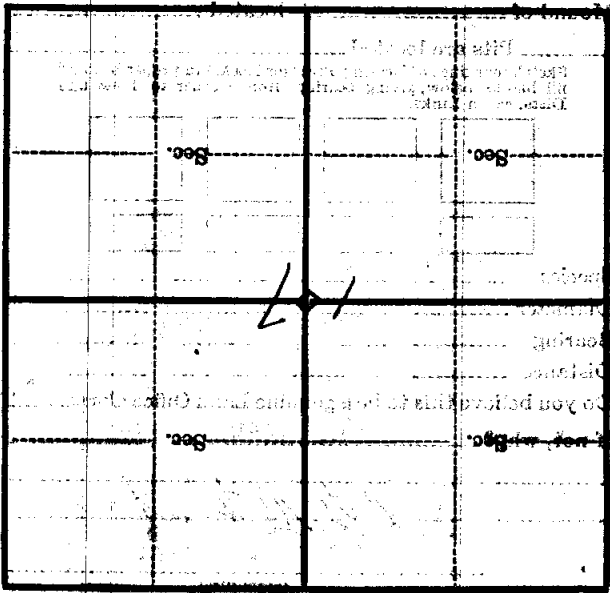

(Make sketch of topography near corner)