

U. S. Department of Agriculture
FOREST SERVICE

M-6

CHIPPENAW NATIONAL FOREST

CORNERS OF THE PUBLIC SURVEY

T. 141 R. 25 Mer. 5
SW 1/4 1/16 Corner common to Sections

17, and _____
Corner consists of a wooden post in place
State condition Rotten-Broken at ground.

Dimensions above ground 2 1/2 x 4 inches
Sketch grooves, letters, figures, or notches, on proper face or edge.
CARDINAL POSITION DIAGONAL POSITION

			T 141
N	W	S	E

NW	SW	SE	NE

Mound of _____ is located _____

Pits are located _____

Sketch markings of Bearing Trees (or Rocks) in proper box and fill blanks below, giving bearings from Corner to Trees and Distances in Links.

Species Balsam
Diameter 2 1/2
Bearing 7
Distance 5 Links

Do you believe this to be a genuine Land Office Corner? No.
If not, why? County Corner.

Raymond T. DeFant
Raymond T. DeFant

(Signature)
Jr. Civil Engineer

1-8-40
(Date)

CORNERS OF THE SECTION SURVAY
 SECTION 17
 T. 101 N. R. 20 E. Mer.

Metal Location Poster is on a
 inches diameter, on the
 side of
 from which this Corner bears
 Give any further facts which will aid in finding this
 Corner again

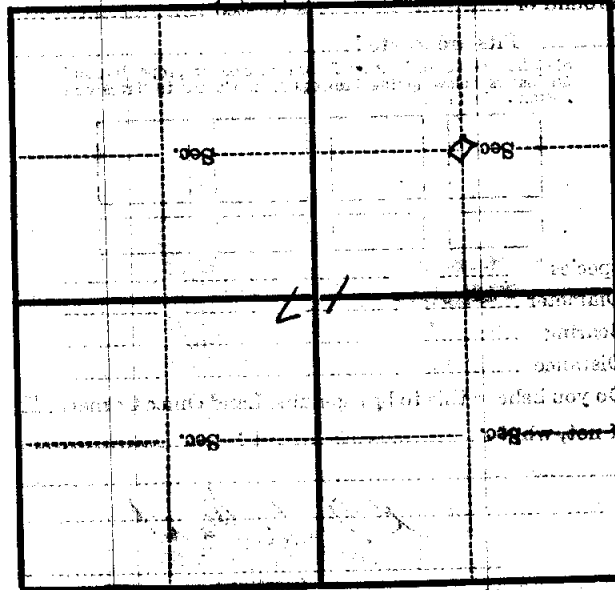

(Make sketch of topography near Corner)

U. S. Department of Agriculture
FOREST SERVICE

M6

CHIPPEWA NATIONAL FOREST

CORNERS OF THE PUBLIC SURVEY

T. 141 R. 25 Mer. 5
11 1/16 Corner common to Sections

17, and _____
Corner consists of a wooden post ~~in~~ in place
State condition Rotten-Broken at ground.

Dimensions above ground 24" X 4" inches
Sketch grooves, letters, figures, or notches, on proper face or edge.

CARDINAL POSITION

DIAGONAL POSITION

			T 141
N	W	S	E

NW	SW	SE	NE

Mound of _____ is located _____

Pits are located _____

Sketch markings of Bearing Trees (or Rocks) in proper box and fill blanks below, giving bearings from Corner to Trees and Distances in Links.

Species Balsam

Diameter 1 1/2 inches

Bearing W

Distance 5 Links

Do you believe this to be a genuine Land Office Corner? No.

If not, why? County Corner.

Raymond T. DeFant
Raymond T. DeFant

(Signature)

Jr. Civil Engineer

(Title)

1-8-40

(Date)

Corner again
 Right in corner of fence--Wired
 to fence post

Give any further facts which will aid in finding this
 chain detail.
 from which this Corner bears Right together.
 side of
 corner
 10" inches diameter, on the North
 Metal Location Poster is on a
 fence post

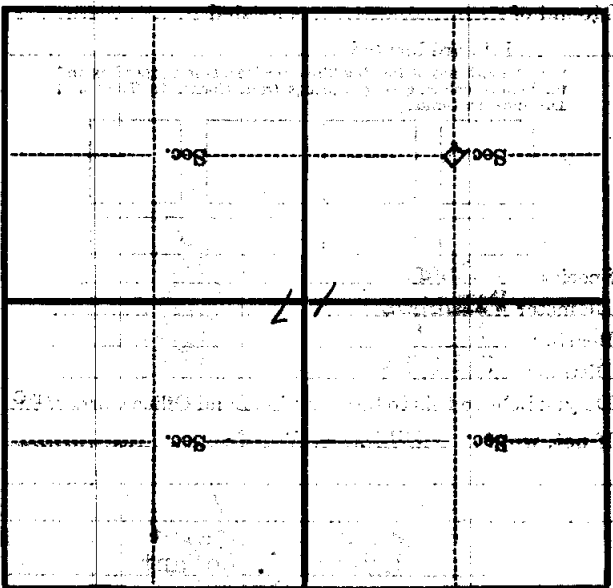

(Make sketch of topography near Corner)

Mer. W-2