

U. S. Department of Agriculture  
FOREST SERVICE

15

CHIPPEWA NATIONAL FOREST

CORNERS OF THE PUBLIC SURVEY

T. 141 R. 25 S. 5 Mer.

#14-1/16

Corner common to Sections

18, and 17

Corner consists of a post in place

State condition poor

Dimensions above ground level inches

Sketch grooves, letters, figures, or notches, on proper face or edge.

CARDINAL POSITION

DIAGONAL POSITION

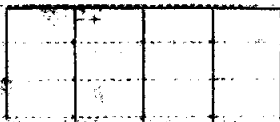
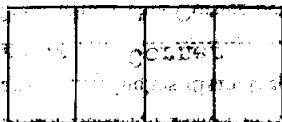

Mound of \_\_\_\_\_ is located \_\_\_\_\_

Pits are located \_\_\_\_\_

Sketch markings of Bearing Trees (or Rocks) in proper box and fill blanks below, giving bearings from Corner to Trees and Distances in Links.



Species None

Diameter \_\_\_\_\_

Bearing \_\_\_\_\_

Distance \_\_\_\_\_

Do you believe this to be a genuine Land Office Corner? No

If not, why? County Corner

*Raymond T. DeFaut*  
RAYMOND T. DEFANT

(Signature)

1-2-40

(Date)

Jr. Civil Engineer

(Title)

Post is level with grade of road

Corner again.

Give any further facts which will aid in finding this

chain distant.

from which this Corner bears East

side of Corner

tree inches diameter, on the

Metal Location Poster is on a post

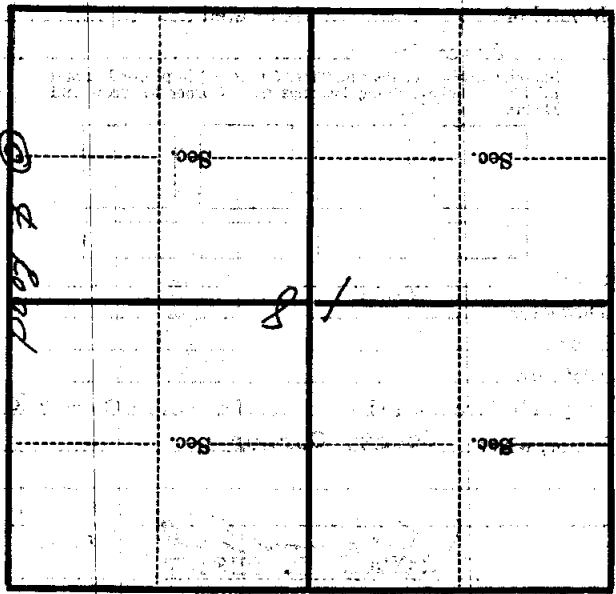

(Make sketch of topography near Corner)

Mer. M-5

Form 874-B—Revised May, 1918  
U. S. Department of Agriculture  
FOREST SERVICE

M-5

CHIPPENAW NATIONAL FOREST

CORNERS OF THE PUBLIC SURVEY

T. 141 R. 28 Mer.

24-1/2

Corner common to Sections

18, and 17

Corner consists of a post in place

State condition poor

Dimensions above ground level inches

Sketch grooves, letters, figures, or notches, on proper face or edge.

CARDINAL POSITION

DIAGONAL POSITION

N W S E

NW SW SE NE

Ground of \_\_\_\_\_ is located \_\_\_\_\_

Pits are located \_\_\_\_\_

Sketch markings of Bearing Tree (or 150 ft) in proper box and fill blanks below, giving bearing from Corner to Trees and Distances in Links.

Species Oak

Diameter \_\_\_\_\_

Bearing \_\_\_\_\_

Distance \_\_\_\_\_

Do you believe this to be a genuine Land Office Corner? No

If not, why? County Corner

*Raymond F. DeFaut*  
RAYMOND F. DEFAUT

1-3-20

(Date)

St. Civil Engineer

(Title)

LW 3-23-74 NOT found

of rock  
 feet to level with  
 Corner again  
 Give any further facts which will aid in finding this  
 chains distant  
 from which this Corner bears  
 side of  
 inches diameter, on the  
 Metal Location Pester is on a

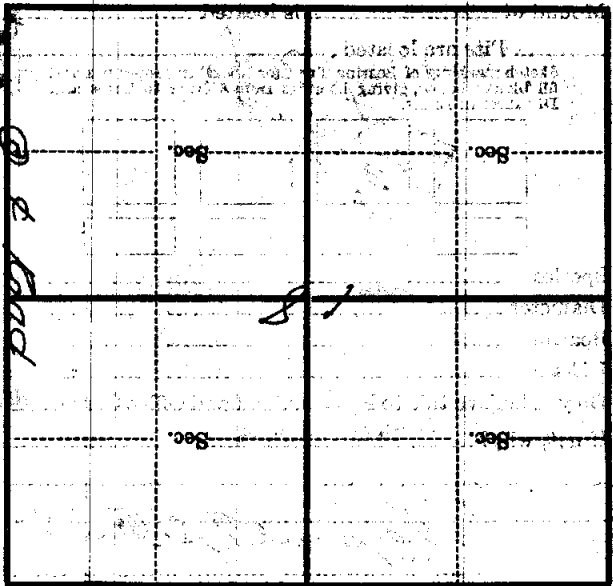

(Make sketch of topography near Corner)

Mer

R

M

T