

Form 874-9—Revised May, 1918
U. S. Department of Agriculture
FOREST SERVICE

N 9

CHIPPEWA NATIONAL FOREST

CORNERS OF THE PUBLIC SURVEY

T. 141 R. 25 5 Mer.

Section Corner common to Sections
17, 16, 20, and 21

Corner consists of a Iron Pipe (40) in place

State condition Very good

Dimensions above ground 14" X 2 1/2" inches

Sketch grooves, letters, figures, or notches, on proper face or edge.

CARDINAL POSITION

DIAGONAL POSITION

N	W	S	E

17	20	21	16
NW	SW	SE	NE

Mound of is located

Pits are located

Sketch markings of Bearing Trees (or Rocks) in proper box and fill blanks below, giving bearings from Corner to Trees and Distances in Links.

Species

Diameter

Bearing

Distance

Do you believe this to be a genuine Land Office Corner? No.

If not, why? County Corner

Raymond T. DeFaut
Raymond T. DeFaut
(Signature)

1-23-40
(Date)

Jr. Civil Engineer
(Title)

Corner again.

Give any further facts which will aid in finding this

35 chains distant.

from which this Corner bears S 52° E

side of Corner

tree 5" inches diameter, on the NW

Metal Location Poster is on a Aspen

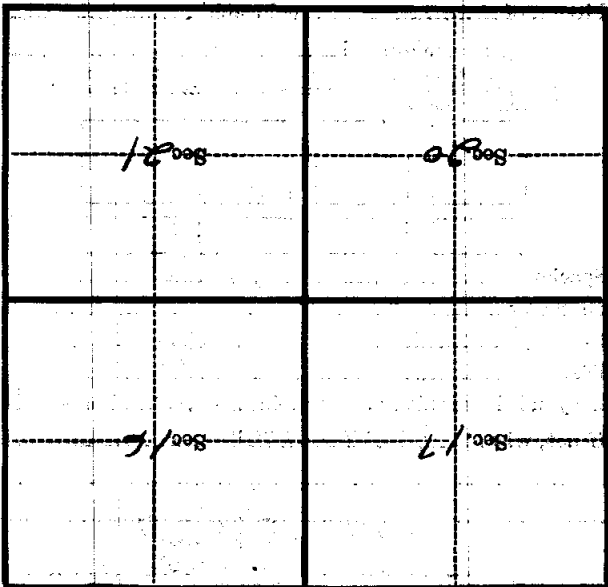

(Make sketch of topography near Corner)

Met. N-9

5

R. 25

T. 141

U. S. Department of Agriculture
FOREST SERVICE

N-9

CHIPPEWA NATIONAL FOREST

CORNERS OF THE PUBLIC SURVEY

T. 141 R. 25 Mer.

Section _____ Corner common to Sections
17, 18, 20, and 21

Corner consists of a Iron Pipe in place

State condition Very good

Dimensions above ground 14" x 2 1/2" inches

Sketch grooves, letters, figures, or notches, on proper face or edge.

CARDINAL POSITION

DIAGONAL POSITION

N	W	S	E

17	20	21	18
NW	SW	SE	NE

Mound of _____ is located _____

Pits are located _____

Sketch markings of Bearing Trees (or Rocks) in proper box and fill blanks below, giving bearings from Corner to Trees and Distances in Links.

Species _____

Diameter _____

Bearing _____

Distance _____

Do you believe this to be a genuine Land Office Corner?

If not, why? County Corner

Raymond T. DeFaut
Raymond T. DeFaut

(Signature)

FR. CIVIL ENGINEER

(Title)

1-22-49
(Date)

Give any further facts which will aid in finding this corner again.

of a ...

CORNER OF THE ...

Metal Location Poster is on a ...

tree ... inches diameter, on the ...

side of ...

from which this corner bears ...

chains distant ...

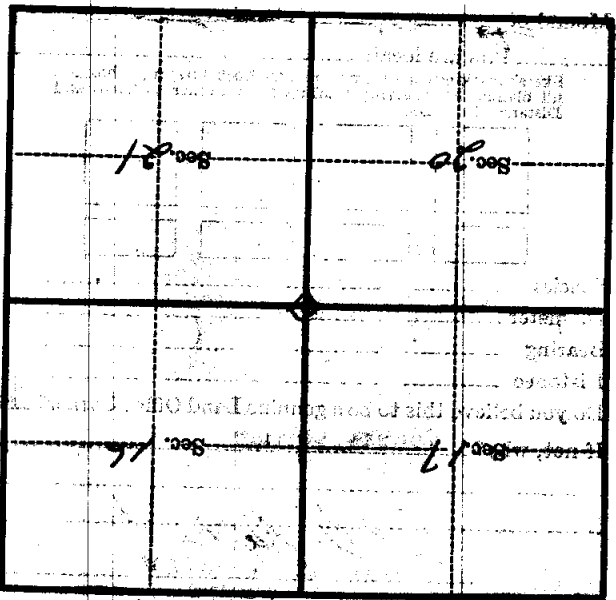

(Make sketch of topography near Corner)