

Form 874-B—Revised May, 1918  
 U. S. Department of Agriculture  
 FOREST SERVICE

P 5-10

----- NATIONAL FOREST

**CORNERS OF THE PUBLIC SURVEY**

T. 60 N R. 26 W 7th Mer.

Meander Corner common to Sections  
20, \_\_\_\_\_, \_\_\_\_\_, and \_\_\_\_\_

Corner consists of a Birch Post (not) in place  
 State condition Fair

Dimensions above ground 2x2x12" inches  
 Sketch grooves, letters, figures, or notches, on proper face or edge.

CARDINAL POSITION

DIAGONAL POSITION

--	--	--	--

	1/6 # 9		1/6 # 9
--	---------------	--	---------------

N W S E

NW SW SE NE

Mound of \_\_\_\_\_ is located \_\_\_\_\_

Pits are located \_\_\_\_\_

Sketch markings of Bearing Trees (or Rocks) in proper box and fill blanks below, giving bearings from Corner to Trees and Distances in Links.

Species Birch Cedar

Diameter 6" 6"

Bearing S 30 E S 67 W

Distance 38 52

Do you believe this to be a genuine Land Office Corner? No

If not, why? Corner set by county surveyors.

Lena Pakja

(Signature)

Jan 31, 1936

(Date)

CCC

(Title)

T.

R.

Mer.

(Make sketch of topography near Corner)

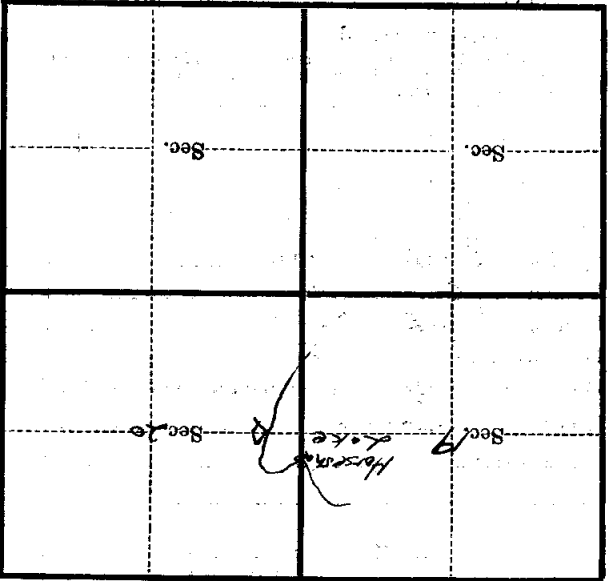

Metal Location Poster is on a *Bird Tree*

tree 6" inches diameter, on the *East*

side of *Tree*

from which this Corner bears *East*

chains distant. *18*

Give any further facts which will aid in finding this

Corner again.

U. S. Department of Agriculture  
FOREST SERVICE

Chippewa NATIONAL FOREST

CORNERS OF THE PUBLIC SURVEY

T. 60 N R. 26 W 4 Mer.

Mc # Corner common to Sections

19, and 20  
Corner consists of a Cedar Post (not) in place

State condition Fair

Dimensions above ground 24 inches

Sketch grooves, letters, figures, or notches, on proper face or edge.

CARDINAL POSITION

DIAGONAL POSITION

--	--	--	--

<u>Mc</u>		<u>Mc</u>	
<u>S</u>		<u>S</u>	
<u>20</u>		<u>19</u>	

N W S E

NW SW SE NE

Mound of \_\_\_\_\_ is located \_\_\_\_\_

\_\_\_\_\_ Pits are located \_\_\_\_\_

Sketch markings of Bearing Trees (or Rocks) in proper box and fill blanks below, giving bearings from Corner to Trees and Distances in Links.

<u>Mc</u>	<u>Mc</u>		
<u>BT</u>	<u>BT</u>		

Species Birch Birch

Diameter 6" 6"

Bearing N45E N50W

Distance 7/Ks 20/Ks

Do you believe this to be a genuine Land Office Corner? No

If not, why? County

Gen Skaja  
(Signature)

ccc  
(Title)

1/31/36  
(Date)

-----  
 -----  
 -----  
 -----  
 -----  
 -----  
 -----  
 -----

Corner again. *Mc or Horse shoe hole*

Give any further facts which will aid in finding this chains distant.

from which this Corner bears side of *Mc*

tree *9* inches diameter, on the *West* Metal Location Poster is on a *Cedar*

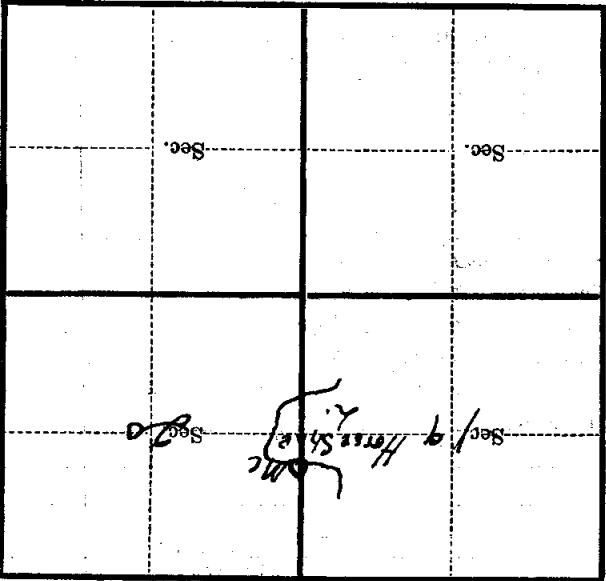

(Make sketch of topography near Corner)