

U. S. Department of Agriculture  
FOREST SERVICE

O-P 5

NATIONAL FOREST

CORNERS OF THE PUBLIC SURVEY

T. 60 R. 26 Mer. 4th

Meander Corner common to Sections

19, & 20, and

Corner consists of a Cedar Post (not) in place

State condition Fair

Dimensions above ground 3x3x24" inches

Sketch grooves, letters, figures, or notches, on proper face or edge.

CARDINAL POSITION

DIAGONAL POSITION

--	--	--	--

Mc		Mc	
S		S	
20		19	

N W S E

NW SW SE NE

Mound of \_\_\_\_\_ is located \_\_\_\_\_

Pits are located \_\_\_\_\_

Sketch markings of Bearing Trees (or Rocks) in proper box and fill blanks below, giving bearings from Corner to Trees and Distances in Links.

Mc	Mc		
BT	1BT		

Species Birch Birch

Diameter 6" 6"

Bearing N 45 E N 50 W

Distance 07 20

Do you believe this to be a genuine Land Office Corner? No

If not, why? County

Len Skaja  
(Signature)

Jan 31 1936  
(Date)

ccc  
(Title)

Blank lined area for notes at the top of the page.

*Meadow Lake*  
*Corner on*

Corner again.

Give any further facts which will aid in finding this chains distant.

from which this Corner bears *7 E*

side of *M.C.*  
tree *9"* inches diameter, on the *West*  
Metal Location Poster is on a *Cedar*

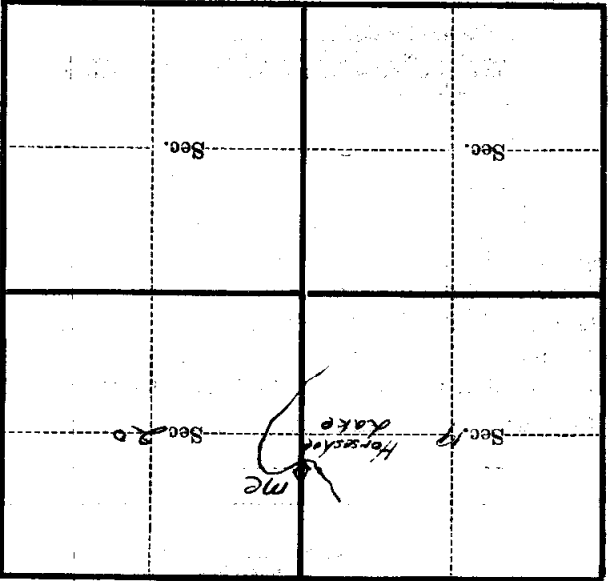

(Make sketch of topography near Corner)