

U. S. Department of Agriculture  
FOREST SERVICE

E-23

Chippewa NATIONAL FOREST

CORNERS OF THE PUBLIC SURVEY

T. 60 N. R. 26 W. 4<sup>th</sup> Mer.

1/4 Corner common to Sections

....., ..... 1, and 12

Corner consists of a Tamarack Post (not) in place

State condition Good

Dimensions above ground 24 inches

Sketch grooves, letters, figures, or notches, on proper face or edge.

CARDINAL POSITION

DIAGONAL POSITION

<u>None</u>			
N	W	S	E

NW	SW	SE	NE

Mound of ..... is located .....

Pits are located .....

Sketch markings of Bearing Trees (or Rocks) in proper box and fill blanks below, giving bearings from Corner to Trees and Distances in Links.

<u>1451</u> <u>T60 R26</u>			
<u>BT</u>			

Species Cedar

Diameter 11"

Bearing .....

Distance .....

Do you believe this to be a genuine Land Office Corner? Yes

If not, why? The bearing tree is original but it seems that the corner post has been replaced and moved to side of road.

G. L. Finney

(Signature)

Jr. Forester

(Title)

7/29/35  
(Date)

Corner again.  
Corner has been moved  
to side of road.

Give any further facts which will aid in finding this  
chains distant.  
from which this Corner bears  
side of ~~road~~  
tree 4 inches diameter, on the South  
Metal Location Poster is on a  
White Post

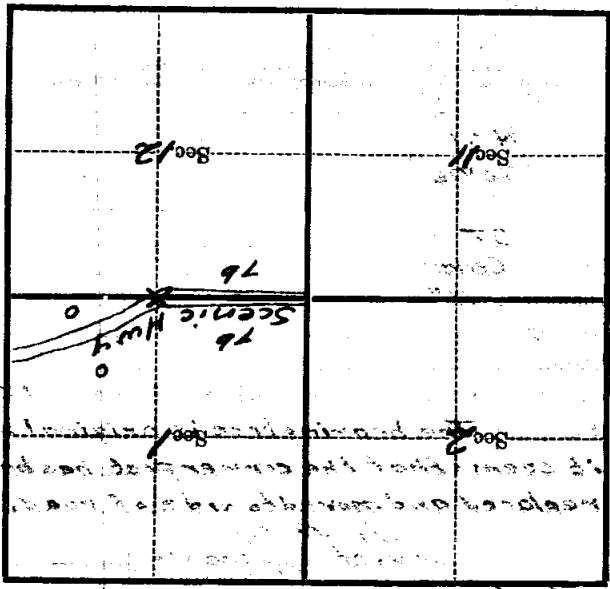

(Make sketch of topography near Corner)

U. S. Department of Agriculture  
FOREST SERVICE

E-23

Chippewa NATIONAL FOREST  
CORNERS OF THE PUBLIC SURVEY

T. 60 R. 26 4E Mer.

----- Corner common to Sections  
-----, -----, 1, and 12.

Corner consists of a Tamarack Post (not) in placeState condition GoodDimensions above ground 24" inches

Sketch grooves, letters, figures, or notches, on proper face or edge.

CARDINAL POSITION

DIAGONAL POSITION

--	--	--	--

N W S E

--	--	--	--

NW SW SE NE

Mound of ----- is located -----

Pits are located -----

Sketch markings of Bearing Trees (or Rocks) in proper box and fill blanks below, giving bearings from Corner to Trees and Distances in Links.

<u>44 S'</u>			
<u>760 <del>ft</del></u>			
<u>BT</u>			

Species CedarDiameter 11"

Bearing -----

Distance -----

Do you believe this to be a genuine Land Office Corner? No

If not, why? The bearing tree does not check with G&O notes. Corner probably was moved when road was built

A. L. Finney  
(Signature)

July 29/35  
(Date)

T. L. Lomax  
(Title)

Lined writing area with horizontal dashed lines.

Corner again.

Give any further facts which will aid in finding this  
chains distant.  
From which this Corner bears  
side of *road*  
tree *4* inches diameter, on the *South*  
Metal Location Poster is on a *White Post*

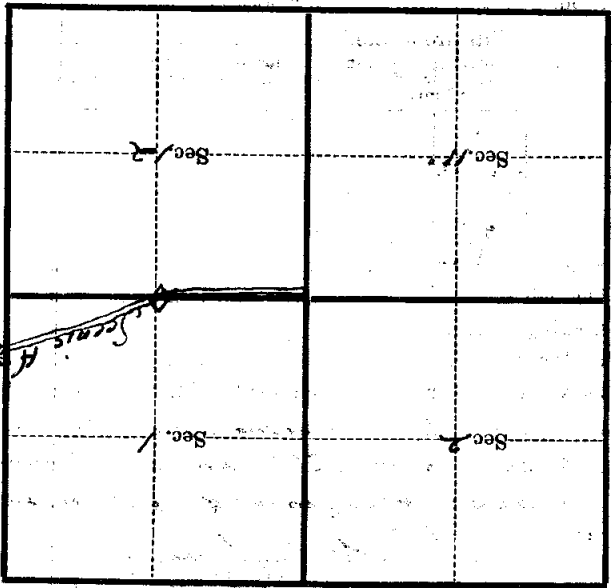

(Make sketch of topography near Corner)

Form 874-9- Revised May, 1913  
U. S. Department of Agriculture  
FOREST SERVICE

Chippewa NATIONAL FOREST

CORNERS OF THE PUBLIC SURVEY

T. 60 N R. 26 W 4<sup>th</sup> Mer.

1/4 Corner common to Sections  
\_\_\_\_\_, \_\_\_\_\_, \_\_\_\_\_, and \_\_\_\_\_

Corner consists of a Tamarack Stake (not) in place  
State condition Good

Dimensions above ground 24 inches  
Sketch grooves, letters, figures, or notches, on proper face or edge.

CARDINAL POSITION

DIAGONAL POSITION

	<u>None</u>		

N W S E

NW SW SE NE

Mound of \_\_\_\_\_ is located \_\_\_\_\_

Pits are located \_\_\_\_\_

Sketch markings of Bearing Trees (or Rocks) in proper box and fill blanks below, giving bearings from Corner to Trees and Distances in Links.

1/4 S1  
T60 R26



BT



Species Cedar

Diameter 11"

Bearing \_\_\_\_\_

Distance \_\_\_\_\_

Do you believe this to be a genuine Land Office Corner? No

If not, why? The bearing trees do not check with original notes.

Corner probably moved when road was built.

A. L. Finney

(Signature)

July 29/35

(Date)

J. Finney

(Title)

Metal Location Poster is on a *White Post* tree *4* inches diameter, on the *South* side of *road* from which this Corner bears chains distant \_\_\_\_\_ Give any further facts which will aid in finding this Corner again.

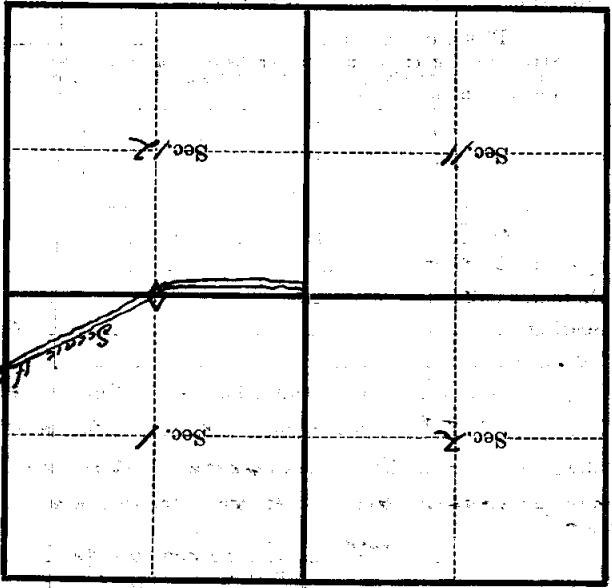

(Make sketch of topography near Corner)

U. S. Department of Agriculture  
FOREST SERVICE

E-23

Chippewa NATIONAL FOREST  
CORNERS OF THE PUBLIC SURVEY

T. 60 R. 26 4<sup>th</sup> Mer.

14 Corner common to Sections  
\_\_\_\_\_, \_\_\_\_\_, \_\_\_\_\_, and 12

Corner consists of a Wooden Stake (not) in place  
State condition Good

Dimensions above ground \_\_\_\_\_ 36 inches  
Sketch grooves, letters, figures, or notches, on proper face or edge.

CARDINAL POSITION

DIAGONAL POSITION

--	--	--	--

--	--	--	--

N W S E

NW SW SE NE

Mound of \_\_\_\_\_ is located \_\_\_\_\_

Pits are located \_\_\_\_\_

Sketch markings of Bearing Trees (or Rocks) in proper box and fill blanks below, giving bearings from Corner to Trees and Distances in Links.

T60 N
R26 W

T60 N
R26 W

--

--

BT
----

BT
----

--

--

Species Sp. Swamp Spruce Sp. Spruce

Diameter 5" 6"

Bearing N35W S37E } To present corner

Distance 97 62 } (see below)

Do you believe this to be a genuine Land Office Corner? Yes

~~How~~, why? Bearing trees check with G.O. notes.

Original stake probably was moved when road was built. See G.O. notes for bearings & distances to where true corner should be

R. R. Johnson  
(Signature)

Nov 3/34  
(Date)

C. F.  
(Title)

Corner again.

Give any further facts which will aid in finding this

chains distant.

99

From which this Corner bears *N 35 E*

side of *stump*

tree *2* inches diameter, on the *South*

Metal Location Poster is on a *Stump of bearing face*

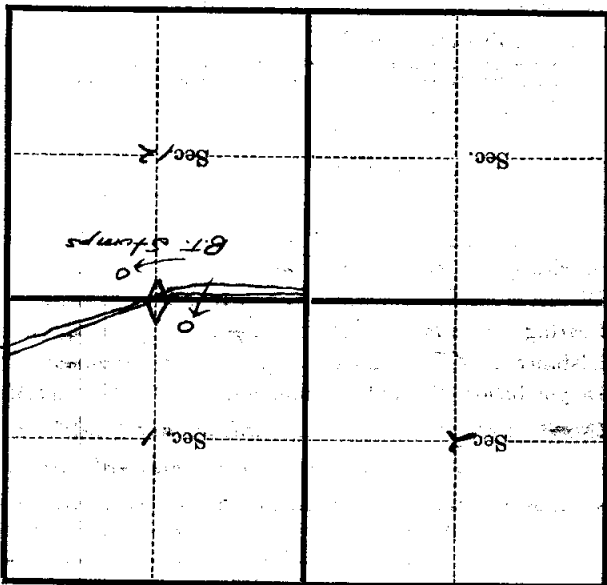

(Make sketch of topography near Corner)



Form 874-B, Revised May, 1918  
 U. S. Department of Agriculture  
 FOREST SERVICE

E-23

Chippewa NATIONAL FOREST  
 CORNERS OF THE PUBLIC SURVEY

T. 60 R. 26 4<sup>th</sup> Mer.

1/4 Corner common to Sections  
 \_\_\_\_\_, \_\_\_\_\_, \_\_\_\_\_, and 12

Corner consists of a Wooden stake (not) in place  
 State condition Fair

Dimensions above ground 36 inches  
 Sketch grooves, letters, figures, or notches, on proper face or edge.

CARDINAL POSITION

DIAGONAL POSITION

	<u>None</u>		
N	W	S	E

	<u>None</u>		
NW	SW	SE	NE

Mound of \_\_\_\_\_ is located \_\_\_\_\_

Pits are located \_\_\_\_\_

Sketch markings of Bearing Trees (or Rocks) in proper box and fill blanks below, giving bearings from Corner to Trees and Distances in Links.

<u>T60N</u>	<u>T60N</u>		
<u>R26W</u>	<u>R26W</u>		
<u>BT</u>	<u>BT</u>		

Species Spr. Stamp Spr. Stamp

Diameter 8" 6"

Bearing N 35.14 S 87 E } To perscat. stake

Distance .97 .62 ch. } (See below)

Do you believe this to be a genuine Land Office Corner? Yes

~~How~~, why? Bearing trees check with G.P.

Original stake probably was moved when road was built. See G.P. notes for bearings & distances to where true corner should be.

R.R. Johnson

(Signature)

Nov. 3/34  
(Date)

Carey Lane  
(Title)

Corner again.

Give any further facts which will aid in finding this

97 chains distant.

from which this Corner bears S 55 E

side of stump

tree 8 inches diameter, on the south

Metal Location Poster is on a stump of bearing tree

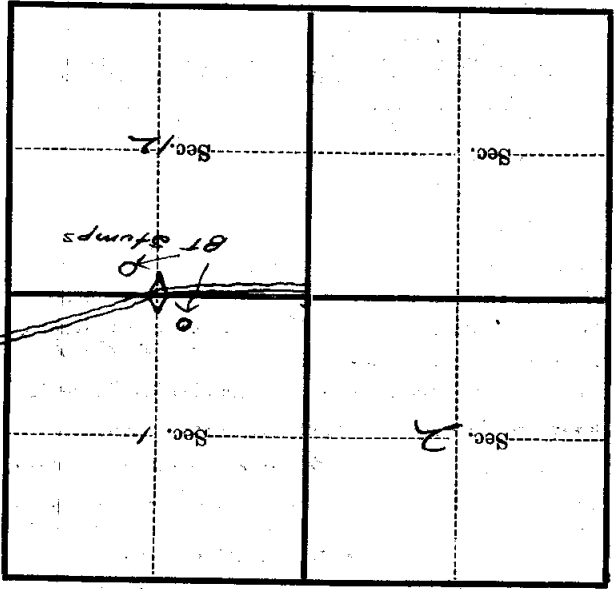

(Make sketch of topography near Corner)

T. Co. R. 26 Mer.

1/2 I " Road ...

1.3  
Tag " Farm Strip 8" N 35 W .97 ch  
" " 6" S 39 E .62 ch

1.3  
1.5

Color 11"

W. E. Post on S. E. R. R.

