

U. S. Department of Agriculture
FOREST SERVICE

NATIONAL FOREST

CORNERS OF THE PUBLIC SURVEY

T. 60 R. 26 *4th* Mer.

Section Corner common to Sections

26, 27, 34, and 35

Corner consists of a *Aspen* (not) in place

State condition *Good*

Dimensions above ground *3 x 3 x 48* inches

Sketch grooves, letters, figures, or notches, on proper face or edge.

CARDINAL POSITION

DIAGONAL POSITION

N W S E

NW SW SE NE

Mound of _____ is located _____

Pits are located _____

Sketch markings of Bearing Trees (or Rocks) in proper box and fill blanks below, giving bearings from Corner to Trees and Distances in Links.

<i>MC</i>			
<i>B.T.</i>			

Species *Cedar*

Diameter *10"*

Bearing *East*

Distance *584 links*

Do you believe this to be a genuine Land Office Corner? *Yes*

If not, why? *In, relocated this section*

corner from a Meander Corner

which is 600 yds east on Datsen Lake. I set 1x15 pipe 2" above ground

J. H. Schelhaug

(Signature)

11/12/36
(Date)

J. Civil Eng
(Title)

7-17

Lined area for notes at the top of the page.

Corner again.

Give any further facts which will aid in finding this

chains distant.

from which this Corner bears *N 85 W*

side of *Stump 5' high*

8" inches diameter, on the West

Metal Location Poster is on a *Open*

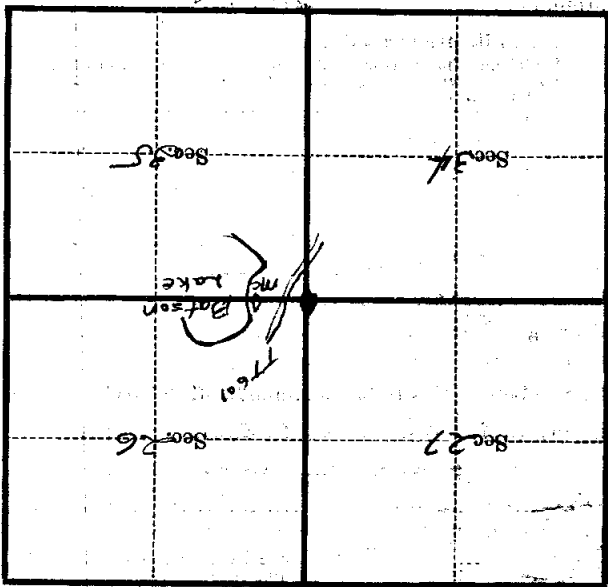

(Make sketch of topography near Corner)

Superior copy

U. S. Department of Agriculture
FOREST SERVICE

417

Chippewa NATIONAL FOREST V17

CORNERS OF THE PUBLIC SURVEY

T. 60 N R. 26 W 4th P. Mer.

Section Corner common to Sections
26, 27, 34, and 35

Corner consists of a Aspen Post (not) a place
State condition Good

Dimensions above ground 48 inches

Sketch grooves, letters, figures, or notches, on proper face or edge.

CARDINAL POSITION

DIAGONAL POSITION

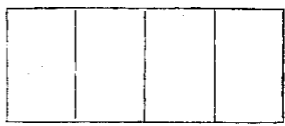
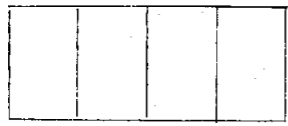

Mound of _____ is located _____

Pits are located _____

Sketch markings of Bearing Trees (or Rocks) in proper box and fill blanks below, giving bearings from Corner to Trees and Distances in Links.

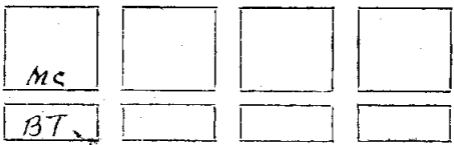

Species Cedar

Diameter 10"

Bearing EAST

Distance 58.4

Do you believe this to be a genuine Land Office Corner? Yes

If not, why? _____

Re-located the section corner from the meander bchs East. Set 1x18" pipe 2" above ground.

J. A. Gjelhaug
(Signature)

Is. Civil Engineer
(Title)

11/12/36
(Date)

Corner again.

Give any further facts which will aid in finding this

0.03 1/2 chains distant.

from which this Corner bears N 85° W

side of STUMP 5' 4.94

tree 8 inches diameter, on the West

Metal Location Poster is on a Aspen

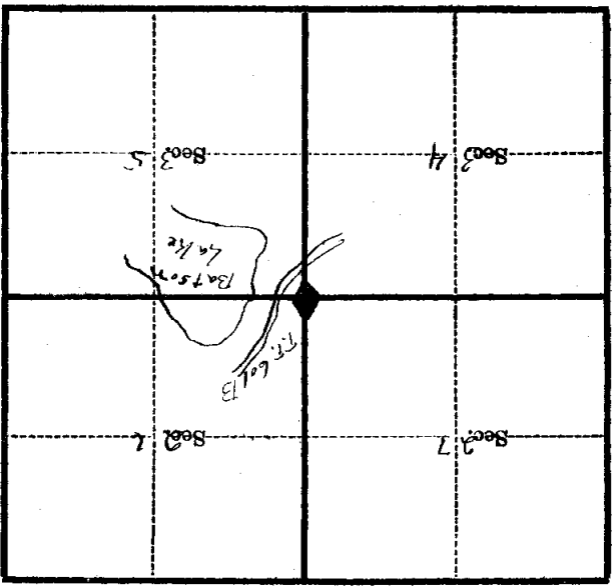

(Make sketch of topography near Corner)

T. 60 N. R. 26 W. 4th Mer.