

U. S. Department of Agriculture
FOREST SERVICE

E-13

Chippewa NATIONAL FOREST
CORNERS OF THE PUBLIC SURVEY

T. 60 N R. 26 W 4 Mer.

Section 9, 10, 3 and 4
Corner common to Sections

Corner consists of a _____ (not) in place

State condition _____

Dimensions above ground _____ inches

Sketch grooves, letters, figures, or notches, on proper face or edge.

CARDINAL POSITION

DIAGONAL POSITION

--	--	--	--

--	--	--	--

N W S E

NW SW SE NE

Mound of _____ is located _____

Pits are located _____

Sketch markings of Bearing Trees (or Rocks) in proper box and fill blanks below, giving bearings from Corner to Trees and Distances in Links.

S 10 T 60 R 26			
BT			

Species W. Spruce

Diameter 17"

Bearing _____

Distance _____

Do you believe this to be a genuine Land Office Corner? _____

If not, why? _____

Sid Rommel
(Signature)

Compass Man
(Title)

11/1/33
(Date)

BT recently blown down
to SE corner intersection
of roads

Corner again.

Give any further facts which will aid in finding this
chains distant.

from which this Corner bears

side of

tree inches diameter, on the

Metal Location Poster is on a

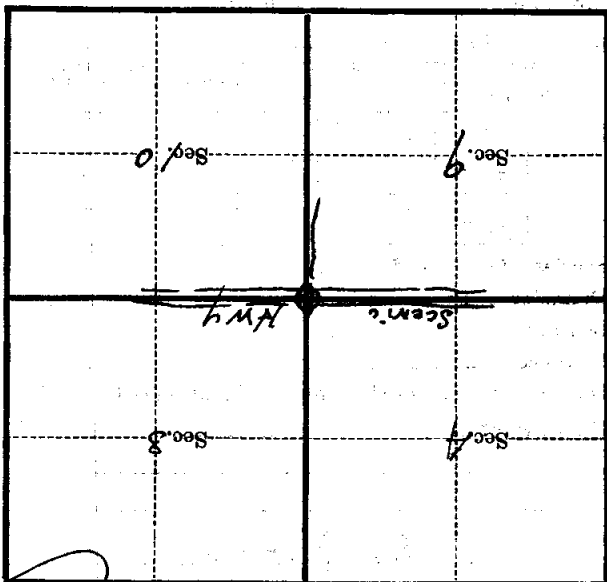

(Make sketch of topography near Corner)

T. 60 N. R. 26 W. 4th Mer. E-13

E-13

U. S. Department of Agriculture

FOREST SERVICE

posted

Chippewa

NATIONAL FOREST

CORNERS OF THE PUBLIC SURVEY

T. 145 R. 21 A Mer.

Section 10, 3, and 21 Corner common to Sections

Corner consists of a (not) in place State condition

Dimensions above ground inches.

Sketch grooves, letters, figures, or notches, on proper face or edge.

CARDINAL POSITION

DIAGONAL POSITION

Diagram for Cardinal Position with four vertical columns.

N W S E

Diagram for Diagonal Position with four vertical columns.

NW SW SE NE

Mound of is located

Pits are located

Sketch markings of Bearing Trees (or Rocks) in proper box and fill blanks below, giving bearings from Corner to Trees and Distances in Links.

Grid for sketching trees with handwritten entries: S-10, T6 DR 26, 37

Species

Diameter

Bearing

Distance

Do you believe this to be a genuine Land Office Corner?

If not, why?

(Signature)

Nov. 1 1933 (Date)

Comptroller (Title)

BT
9c SE
BT
Corner again.

Metal Location Poster is on a
tree _____ inches diameter, on the
side of _____
from which this Corner bears _____
chains distant.
Give any further facts which will aid in finding this

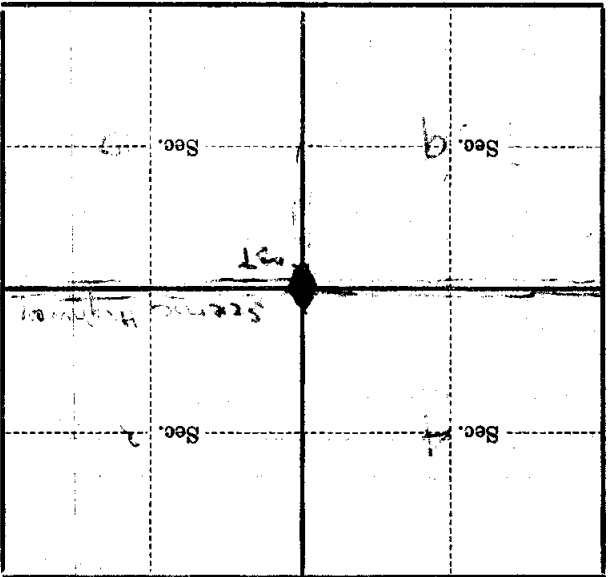

(Make sketch of topography near Corner)

T 60 R 20 Mer