

U. S. Department of Agriculture  
FOREST SERVICE

E-21  
12-21

**CALIFORNIA** NATIONAL FOREST

CORNERS OF THE PUBLIC SURVEY

T. ~~59N~~ R. ~~27W~~ Mer.

Corner common to Sections  
~~1~~, ~~2~~, ~~11~~, and ~~12~~

Corner consists of a ~~Post~~ <sup>Iron</sup> ~~in place~~

State condition ~~Good~~

Dimensions above ground ~~4 1/2~~ inches

Sketch grooves, letters, figures, or notches, on proper face or edge.

CARDINAL POSITION

DIAGONAL POSITION

--	--	--	--

8	8	8	8
2	11	12	1

N W S E

NW SW SE NE

Mound of \_\_\_\_\_ is located \_\_\_\_\_

Pits are located \_\_\_\_\_

Sketch markings of Bearing Trees (or Rocks) in proper box and fill blanks below, giving bearings from Corner to Trees and Distances in Links.

	8 12		

Species ~~Stump~~ ~~Cedar~~

Diameter ~~10"~~ ~~6"~~

Bearing ~~N20W~~ ~~S53E~~

Distance ~~0.10~~ ~~0.50~~

Do you believe this to be a genuine Land Office Corner? ~~Yes~~

If not, why? \_\_\_\_\_

A. Larson  
(Signature)

2-12-15  
(Date)

000 1111  
(1116)

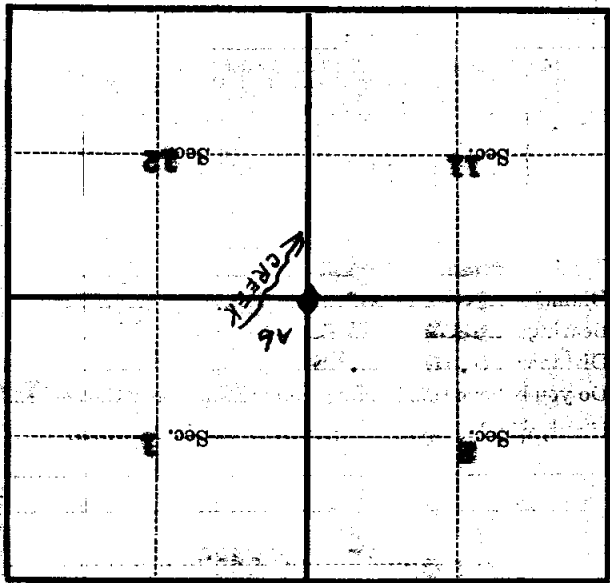

(Make sketch of topography near Corner)

Metal Location Poster is on a **1000** inches diameter, on the **1000** side of **1000** from which this Corner bears **0.16** chains distant.

Give any further facts which will aid in finding this Corner again.

U. S. Department of Agriculture  
FOREST SERVICE

12-21

Chippewa NATIONAL FOREST  
CORNERS OF THE PUBLIC SURVEY

T. 59 N R. 27 W Mer. 7

5 Corner common to Sections

1, 2, 11, and 12

Corner consists of a post (not) in place

State condition Fe Pipe  
Grass

Dimensions above ground 48 inches

Sketch grooves, letters, figures, or notches, on proper face or edge.

CARDINAL POSITION

DIAGONAL POSITION

--	--	--	--

5	5	5	5
2	11	12	1

N W S E

NW SW SE NE

Mound of \_\_\_\_\_ is located \_\_\_\_\_

Pits are located \_\_\_\_\_

Sketch markings of Bearing Trees (or Rocks) in proper box and fill blanks below, giving bearings from Corner to Trees and Distances in Links.

	5 12		
BT	BT		

Species Stump Cedar

Diameter 10" 6"

Bearing N 20 W S 53 E

Distance 0.10 0.58

Do you believe this to be a genuine Land Office Corner? Yes

If not, why? \_\_\_\_\_

Lorson

(Signature)

2-19-35

(Date)

CCC Enrollee

(Title)

Metal Location Poster is on a *Aspen* tree ~~4~~ inches diameter, on the *S* side of *tree* from which this Corner bears *532 W* chains distant. Give any further facts which will aid in finding this Corner again.

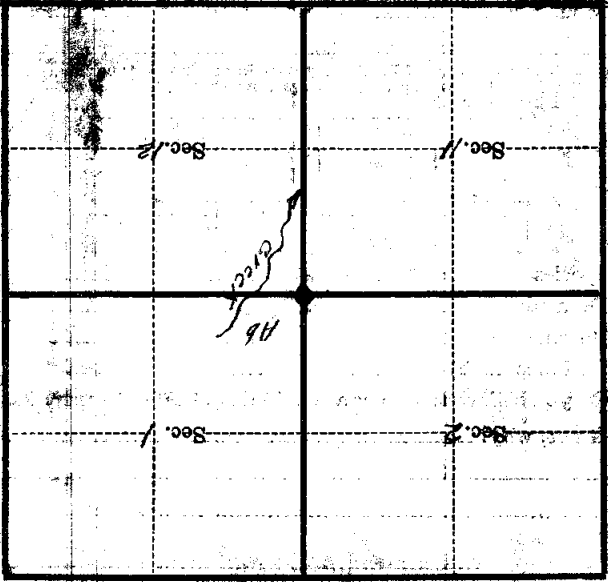

(Make sketch of topography near Corner)

T. 59 N. R. 27 W. 4 Mer. E-21

U. S. Department of Agriculture  
FOREST SERVICE

E-21

NATIONAL FOREST

CORNERS OF THE PUBLIC SURVEY

T. 58 R. 27 4 Mer.

Sec Corner common to Sections  
1, 2, 11, and 12

Corner consists of a scrub post (not) in place  
State condition standing but poor

Dimensions above ground \_\_\_\_\_ inches  
Sketch grooves, letters, figures, or notches, on proper face or edge.

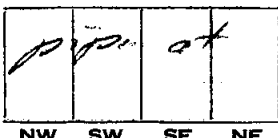
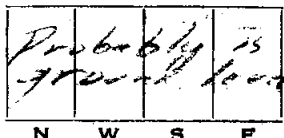

Mound of \_\_\_\_\_ is located \_\_\_\_\_

Pits are located \_\_\_\_\_

Sketch markings of Bearing Trees (or Rocks) in proper box and fill blanks below, giving bearings from Corner to Trees and Distances in Links.

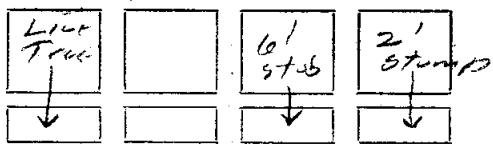

Species	<u>WT. Pine</u>	<u>Tan</u>	<u>Tan</u>
Diameter	<u>16"</u>	<u>4"</u>	<u>5"</u>
Bearing	<u>N60W</u>	<u>N40W</u>	<u>S20E</u>
Distance	<u>120 FT</u>	<u>5'</u>	<u>52'</u>

Do you believe this to be a genuine Land Office Corner? Yes

If not, why? Orig evidence & resurvey  
resurvey

R. G. ...  
(Signature)

12-24-54  
(Date)

D. E. P.  
(Title)

Corner again.  
 Toy - 2" Ribbon 3 1/2"  
 W. of road  
 Traced line to N. line  
 In first space there  
 76

Metal Location Poster is on a 5 inches diameter, on the SE side of from which this Corner bears 55 chains distant.  
 Give any further facts which will aid in finding this

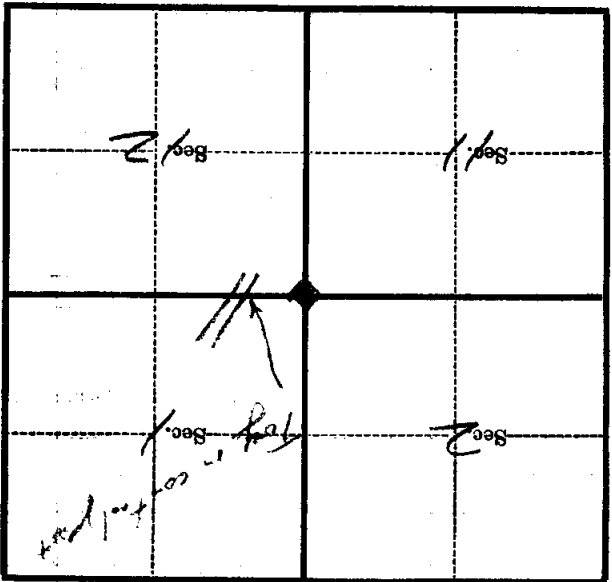

(Make sketch of topography near Corner)