

U. S. Department of Agriculture

FOREST SERVICE

Chippewa NATIONAL FOREST L 19

CORNERS OF THE PUBLIC SURVEY

T. 7 R. 77 10th Mer.

Corner to post Corner common to Sections 14, and \_\_\_\_\_

Corner consists of a \_\_\_\_\_ (not) in place

State condition \_\_\_\_\_

Dimensions above ground \_\_\_\_\_ inches.

Sketch grooves, letters, figures, or notches, on proper face or edge.

CARDINAL POSITION

DIAGONAL POSITION

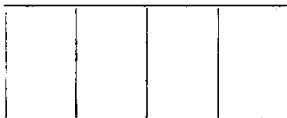
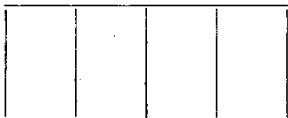

Mound of \_\_\_\_\_ is located \_\_\_\_\_

\_\_\_\_\_ Pits are located \_\_\_\_\_

Sketch markings of Bearing Trees (or Rocks) in proper box and fill blanks below, giving bearings from Corner to Trees and Distances in Links.

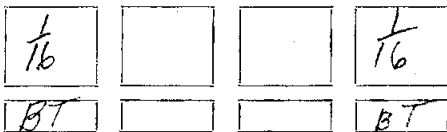

Species Oak \_\_\_\_\_ Bass

Diameter 14" \_\_\_\_\_ 9"

Bearing \_\_\_\_\_

Distance \_\_\_\_\_

Do you believe this to be a genuine Land Office Corner? \_\_\_\_\_

If not, why? yes

Jas. M. Kargall  
(Signature)

11/13  
(Date)

app.  
(Title)

Metal Location Poster is on a tree \_\_\_\_\_ inches diameter, on the side of \_\_\_\_\_ from which this Corner bears \_\_\_\_\_ chains distant.

Give any further facts which will aid in finding this Corner again.

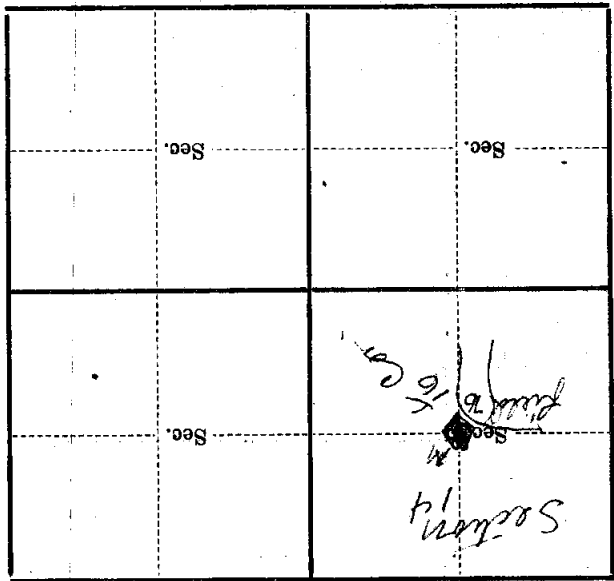

(Make sketch of topography near Corner)

T. 59 R. 27 4th Mer. 7-19