

U. S. Department of Agriculture
FOREST SERVICE

L-13

Chippewa NATIONAL FOREST
CORNERS OF THE PUBLIC SURVEY

T. 59N R. 27W 4th Mer.

1/4 Corner common to Sections
15, and 16

Corner consists of a Wood Stake (not) in place
State condition 1 1/2" Fe Pipe

Dimensions above ground 30 inches
Sketch grooves, letters, figures, or notches, on proper face or edge.

CARDINAL POSITION

DIAGONAL POSITION

	<u>1/4</u>	<u>1/4</u>	
	<u>S</u>	<u>S</u>	
	<u>16</u>	<u>15</u>	
N	W	S	E

NW	SW	SE	NE

Mound of _____ is located _____

Pits are located _____

Sketch markings of Bearing Trees (or Rocks) in proper box and fill blanks below, giving bearings from Corner to Trees and Distances in Links.

<u>1/4 S</u> <u>15</u>	<u>1/4 S</u> <u>16</u>		
<u>BT</u>	<u>BT</u>		

Species J.P. J.P.
Diameter 6" 7"
Bearing S52W N30W
Distance 8.2lk 7.6lk

Do you believe this to be a genuine Land Office Corner? Yes

If not, why? _____

Donald Poole
(Signature)
1-10-35 C.C.C. Enalla
(Date) (Title)

Compass set of N 70 W

Corner again.

Give any further facts which will aid in finding this

0.17 chains distant.

from which this Corner bears

S 10 E

side of

Trees

N 10 W

tree 8 inches diameter, on the

SW

Metal Location Poster is on a

1/2 Pine

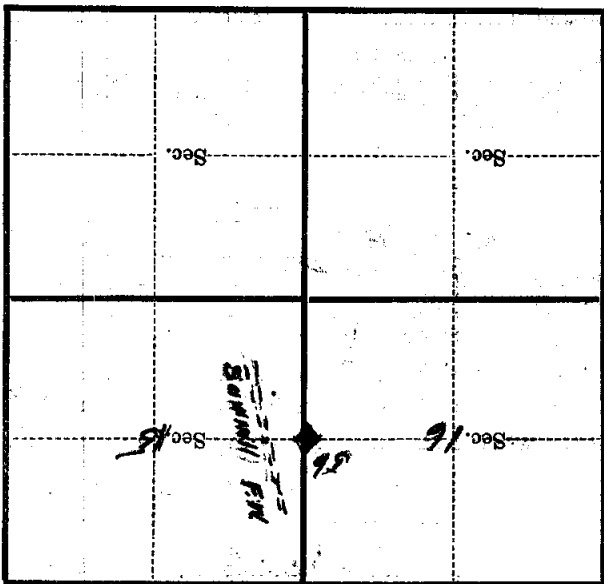

(Make sketch of topography near Corner)

7-13

Mer.

T. 52N R. 37W 4

Form 874-9—Revised May, 1918
 U. S. Department of Agriculture
 FOREST SERVICE

L-13

Chippewa NATIONAL FOREST

CORNERS OF THE PUBLIC SURVEY

T. 59N R. 27W 4 Mer.

1/4 Corner common to Sections
15, and 16

Corner consists of a Wood Post (not) in place
 State condition Good 1 1/2" Fe Pipe

Dimensions above ground 3.0 inches
 Sketch grooves, letters, figures, or notches, on proper face or edge.

CARDINAL POSITION

DIAGONAL POSITION

	<u>1/4</u>		<u>1/4</u>
	<u>5</u>		<u>5</u>
	<u>16</u>		<u>15</u>
N	W	S	E

NW	SW	SE	NE

Mound of _____ is located _____

Pits are located _____

Sketch markings of Bearing Trees (or Rocks) in proper box and fill blanks below, giving bearings from Corner to Trees and Distances in Links.

<u>1/4</u>	<u>1/4</u>		
<u>S 15</u>	<u>S 16</u>		
<u>BT</u>	<u>BT</u>		

Species J. Pine J. Pine

Diameter 6" 7"

Bearing S 55 W N 30 W

Distance 0.82 0.76

Do you believe this to be a genuine Land Office Corner? Yes

If not, why? _____

Don. Poole

(Signature)

1-10-35

(Date)

C.C.C. Enrollee

(Title)

Compass set N70W

Corner again.

Give any further facts which will aid in finding this

0.17 chains distant.

From which this Corner bears

S 10 W

side of

Tree

tree 8 inches diameter, on the

SW

Metal Location Poster is on a

Pine

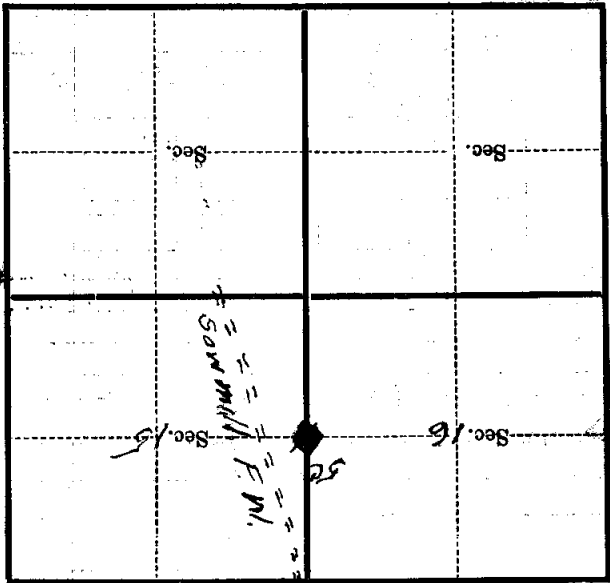

(Make sketch of topography near Corner)

T 59 N R 27 W 4 L-13 Mer.

U. S. Department of Agriculture

FOREST SERVICE

Chippewa NATIONAL FORESTCORNERS OF THE PUBLIC SURVEY ^{2 13}T. 59 N R. 27 W 4 Mer.

Corner common to Sections

_____, 15, and 16Corner consists of a Wood Stake (not) in placeState condition Good 1 1/2" Fe PipeDimensions above ground 30 inches

Sketch grooves, letters, figures, or notches, on proper face or edge.

CARDINAL POSITION

DIAGONAL POSITION

	<u>1/4</u>	<u>1/4</u>	
	<u>S</u>	<u>S</u>	
	<u>16</u>	<u>15</u>	

N W S E

NW SW SE NE

Mound of _____ is located _____

Pits are located _____

Sketch markings of Bearing Trees (or Rocks) in proper box and fill blanks below, giving bearings from Corner to Trees and Distances in Links.

<u>1/4</u> <u>S</u> <u>15</u>	<u>1/4</u> <u>S</u> <u>15</u>		
<u>BT</u>	<u>BT</u>		

Species J P J PDiameter 6" 7"Bearing S55W N30WDistance .82 ch .76 chDo you believe this to be a genuine Land Office Corner? Yes

If not, why? _____

Ronald Peals

(Signature)

1-10-35

(Date)

C. L. Curable

(Title)

Compass set N 70 W

Corner again.

Give any further facts which will aid in finding this

0.17 chains distant.

from which this Corner bears

S 10 E
N 10 W

side of

Tree

tree 8 inches diameter, on the

SW

Metal Location Poster is on a

V. Pine

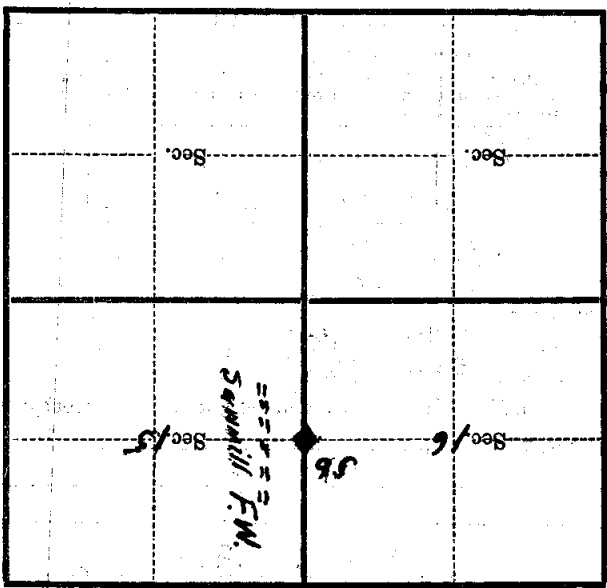

(Make sketch of topography near Corner)

T. 59 N. R. 27 W. Mer. L-13