

U. S. Department of Agriculture  
FOREST SERVICE

2-11,12

Chippewa NATIONAL FOREST  
CORNERS OF THE PUBLIC SURVEY

T. 59 N R. 26 W 4th Mer.

M.C. Corner common to Sections  
4, and 33

Corner consists of a 4" cedar (not) in place

State condition good (1" iron pipe 6")

Dimensions above ground 3' high inches

Sketch grooves, letters, figures, or notches, on proper face or edge.

CARDINAL POSITION

DIAGONAL POSITION

M S 33		M S 34	
N	W	S	E

NW	SW	SE	NE

Mound of \_\_\_\_\_ is located \_\_\_\_\_

Pits are located \_\_\_\_\_

Sketch markings of Bearing Trees (or Rocks) in proper box and fill blanks below, giving bearings from Corner to Trees and Distances in Links.

Species \_\_\_\_\_

Diameter \_\_\_\_\_

Bearing \_\_\_\_\_

Distance \_\_\_\_\_

Do you believe this to be a genuine Land Office Corner? Yes

If not, why? \_\_\_\_\_

Emin Meagher  
(Signature)

1-10-35  
(Date)

Field ass't  
(Title)

M.O. IS ON EDGE OF  
#38 HIGHWAY MAIL  
SHACK 1 CHAIN S.  
OF COR.

Corner again.

Give any further facts which will aid in finding this

76 ft. ~~feet~~ distant.

from which this Corner bears S 72° W

side of pole

tree 7 inches diameter, on the S.W

Metal Location Poster is on a Telephone pole

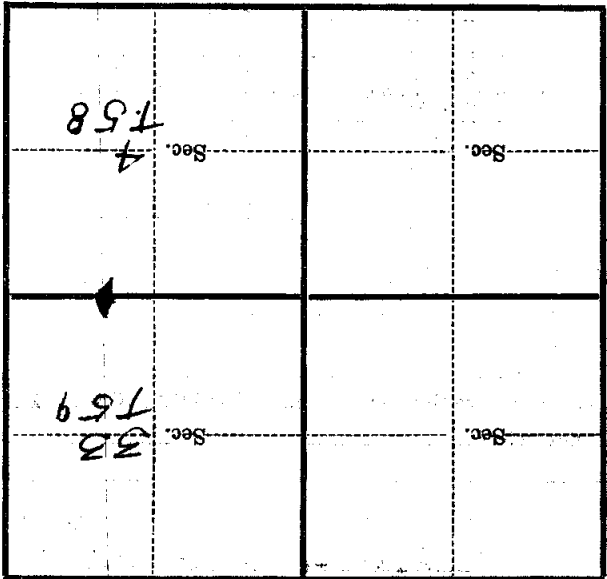

(Make sketch of topography near Corner)

T. 59 N R. 26 W 4th Mer.

Form 874-9—Revised May, 1918  
U. S. Department of Agriculture  
FOREST SERVICE

Chippewa NATIONAL FOREST

Q-  
Listed 7-11, 12

CORNERS OF THE PUBLIC SURVEY

T. 59 N R. 26 W 4th Mer.

M. C. Corner common to Sections

....., ....., 4, and 33

Corner consists of a 4" Cedar (not) in place

State condition good (1" iron pipe 6")

Dimensions above ground 3' inches

Sketch grooves, letters, figures, or notches, on proper face or edge.

CARDINAL POSITION

DIAGONAL POSITION

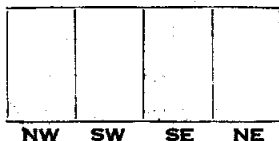
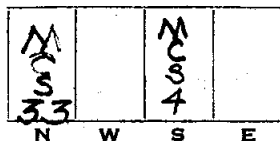

Mound of ..... is located .....

Pits are located .....

Sketch markings of Bearing Trees (or Rocks) in proper box and fill blanks below, giving bearings from Corner to Trees and Distances in Links.

Species .....

Diameter .....

Bearing .....

Distance .....

Do you believe this to be a genuine Land Office Corner? *Yes*

If not, why? .....

*E. M. ...*  
(Signature)

*1-10-35*  
(Date)

*Field Ass't*  
(Title)

M.C. is on edge of #38 HIGHWAY S.M. 11  
SHACK 1 CHAIN S. of  
COT.

Corner again.

Give any further facts which will aid in finding this

76.71! shows distant.

side of pole  
from which this Corner bears S 72° W

Metal Location Poster is on a telephone pole  
tree 7 inches diameter, on the S.W.

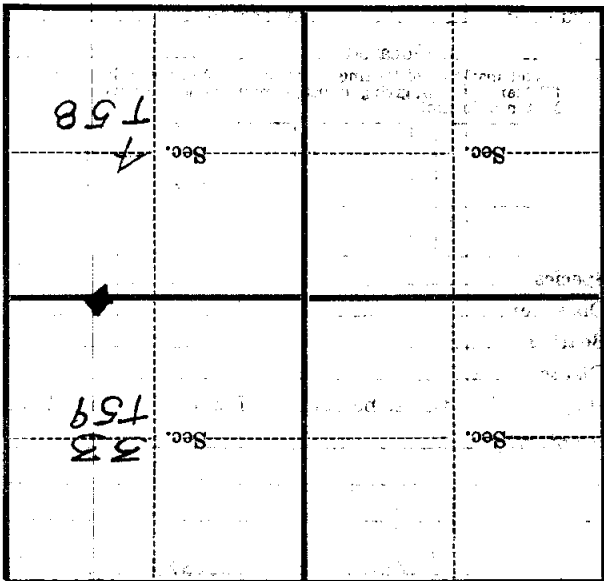

(Make sketch of topography near Corner)

T 59 N R. 46 W 4th Mer.