

U. S. Department of Agriculture

FOREST SERVICE

A-10,11

Chippewa NATIONAL FOREST

CORNERS OF THE PUBLIC SURVEY

T. 59 & 60 R. 26 4th P Mer.

M.C.

Corner common to Sections

4 and 33

Corner consists of a Cedar tree (not) in place

State condition

Dimensions above ground inches

Sketch grooves, letters, figures, or notches, on proper face or edge.

CARDINAL POSITION

DIAGONAL POSITION

--	--	--	--

N W S E

--	--	--	--

NW SW SE NE

Mound of is located

Pits are located

Sketch markings of Bearing Trees (or Rocks) in proper box and fill blanks below, giving bearings from Corner to Trees and Distances in Links.

Species

Diameter

Bearing

Distance

Do you believe this to be a genuine Land Office Corner? No

If not, why? U.S.F.S. (Approx.)

George H. Jennings

(Signature)

9-23-35

(Date)

Const. Insp. S.M.

(Title)

-----  
 -----  
 -----  
 -----  
 -----  
 -----  
 -----  
 -----

Corner again.

Give any further facts which will aid in finding this

chains distant.

from which this Corner bears

side of *tree*

tree 8 inches diameter, on the

Metal Location Poster is on a *W. Cedar*

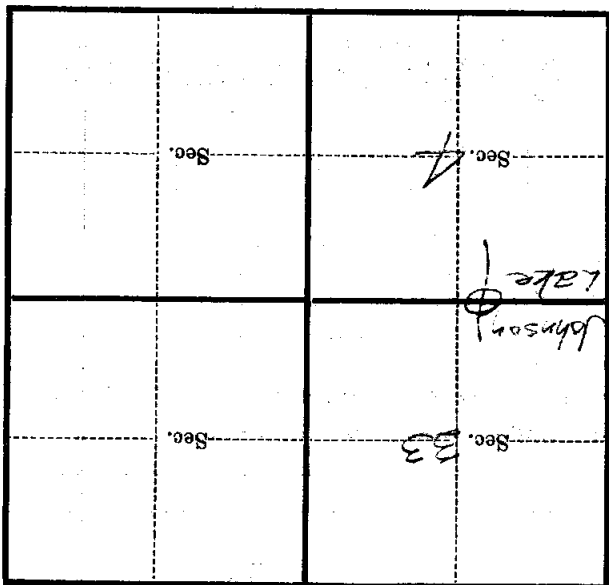

(Make sketch of topography near Corner)

T. 59+60 R. 26 W. 4th P. Mer.