

U. S. Department of Agriculture

FOREST SERVICE

shu p p c w 22 NATIONAL FOREST *N-19*

CORNERS OF THE PUBLIC SURVEY

T. *59N* R. *26W* *4th* Mer.

1/4 Corner common to Sections
 _____, *14*, and *23*

Corner consists of a *4" tall arched post* *G.L.O.* in place

State condition *Good*

Dimensions above ground *16"* inches

Sketch grooves, letters, figures, or notches, on proper face or edge.

CARDINAL POSITION

DIAGONAL POSITION

<i>1/4</i>		<i>1/4</i>	
<i>14</i>		<i>23</i>	
N	W	S	E

NW	SW	SE	NE

Mound of _____ is located _____

Pits are located _____

Sketch markings of Bearing Trees (or Rocks) in proper box and fill blanks below, giving bearings from Corner to Trees and Distances in Links.

Species *N pine stump*

Diameter *18*

Bearing *S 17° E*

Distance *35/ks*

Do you believe this to be a genuine Land Office Corner? *YES*

If not, why? _____

King
 (Signature)

10/12/35
 (Date)

(Title)

Corner sets in
TAXITE about 1/4 in
width bearing NTS

Corner again.

Give any further facts which will aid in finding this

251Ks chains distant.

from which this Corner bears N 58° W

side of tree

tree 5 inches diameter, on the NW

Metal Location Poster is on a Aspen

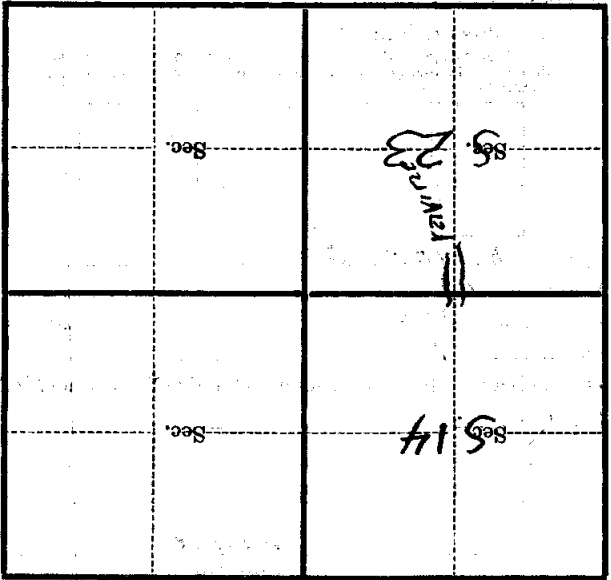

(Make sketch of topography near Corner)

T. 59 N R. 26 W 4th Mer.

U. S. Department of Agriculture

FOREST SERVICE

N-19

chippeval NATIONAL FOREST

CORNERS OF THE PUBLIC SURVEY

T. 59 N R. 26 W 4 E Mer.

1/4 Corner common to Sections 14, and 23

Corner consists of a Tamarack post (red) in place State condition Good

Dimensions above ground 16 inches

Sketch grooves, letters, figures, or notches, on proper face or edge.

CARDINAL POSITION

DIAGONAL POSITION

1/4		1/4	
14		23	
N	W	S	E

NW	SW	SE	NE

Mound of _____ is located _____

Pits are located _____

Sketch markings of Bearing Trees (or Rocks) in proper box and fill blanks below, giving bearings from Corner to Trees and Distances in Links.

Species N. Pine - St. Spr

Diameter 10

Bearing S 17° E

Distance 35 - 1/2 Ks. 23.1'

Do you believe this to be a genuine Land Office Corner? Yes

If not, why? _____

King (Signature)

10/12/35 (Date)

(Title)

Corner section
taken about 10:30 AM
with the bearing N 45

Corner again.

Give any further facts which will aid in finding this

from which this Corner bears
N 58 W
25 1/2 chains distant 16.5

side of fence

tree 5 inches diameter, on the NW

Metal Location Poster is on a Aspen

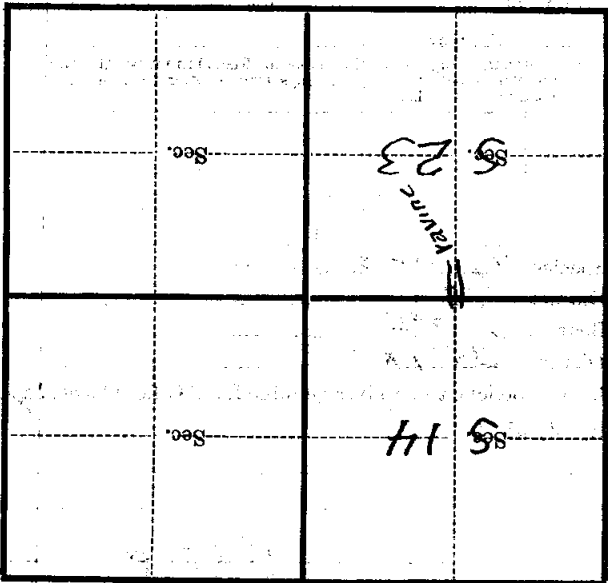

(Make sketch of topography near Corner)

T. 59 N R. 26 W 4th Mer.