

U. S. Department of Agriculture
FOREST SERVICE

Posted 5-17

Chippewa NATIONAL FOREST

CORNERS OF THE PUBLIC SURVEY

T. 59N R. 26W 4th Mer.

Sec. Corner common to Sections

10, 11, 14, and 15

Corner consists of a Wooden & Iron ^{stake} (not) in place

State condition Good

Dimensions above ground 18 inches

Sketch grooves, letters, figures, or notches, on proper face or edge.

CARDINAL POSITION

DIAGONAL POSITION

| | | | |
|--|--|--|--|
| | | | |
|--|--|--|--|

N W S E

| | | | |
|----|----|----|----|
| S | S | S | S |
| 10 | 15 | 14 | 11 |

NW SW SE NE

Mound of _____ is located _____

_____ Pits are located _____

Sketch markings of Bearing Trees (or Rocks) in proper box and fill blanks below, giving bearings from Corner to Trees and Distances in Links.

| | | | |
|--------------------------------------------|--|--|--|
| <u>T59N</u> <u>R26W</u> <u>S. 15</u> | | | |
| <u>B.T.</u> | | | |

Species W. P.

Diameter 2.0

Bearing S. 28° W

Distance .06

Do you believe this to be a genuine Land Office Corner? No

If not, why? Placed 5 or 6 yrs. ago

With Transit

Leonard J. Pulkrabek
(Signature)

Dec 13, 1934
(Date)

Rich. Fournier
(Title)

brushed out 12 ft wide
North line of Sec. 14 well

located Ash. N of marshy
grassland.

Corner again.

Give any further facts which will aid in finding this

chains distant .06

from which this Corner bears N 28° E

side of Trees

tree 20 inches diameter, on the NE

Metal Location Poster is on a W.P.

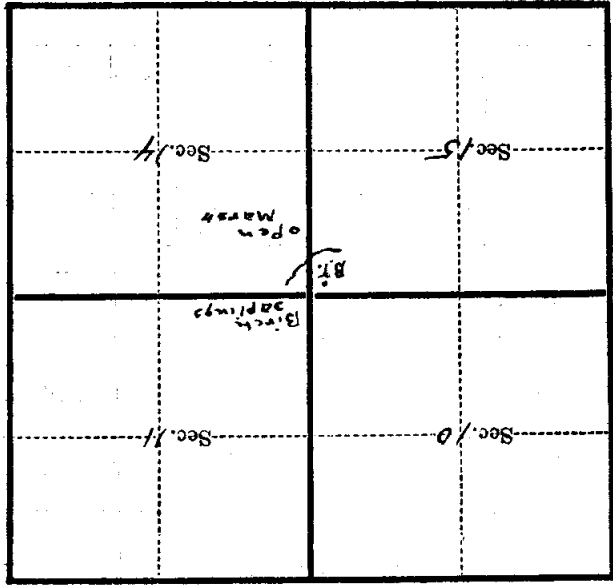

(Make sketch of topography near Corner)

T 59N R 26W 4th Mer.

U. S. Department of Agriculture
FOREST SERVICE

J-17

Chippewa NATIONAL FOREST

CORNERS OF THE PUBLIC SURVEY

T. 59N R. 26W 4th Mer.

Sec. Corner common to Sections
10, 11, 14, and 15

Corner consists of a wooden & iron stakes (not) in place

State condition Good

Dimensions above ground 18 inches

Sketch grooves, letters, figures, or notches, on proper face or edge.

CARDINAL POSITION

DIAGONAL POSITION

| | | | |
|---|---|---|---|
| | | | |
| N | W | S | E |

| | | | |
|----|----|----|----|
| S | S | S | S |
| 10 | 15 | 14 | 11 |
| NW | SW | SE | NE |

Mound of is located

Pits are located

Sketch markings of Bearing Trees (or Rocks) in proper box and fill blanks below, giving bearings from Corner to Trees and Distances in Links.

| | | | |
|----------------------|--|--|--|
| T59N R26W S 15 | | | |
| BT | | | |

Species W.P.

Diameter 20"

Bearing S 28° W

Distance 06

Do you believe this to be a genuine Land Office Corner? No

If not, why? Placed 5 or 6 yrs.

Ago. With Transit.

Leonard J. Cultrick

(Signature)

Dec. 13, 1934

(Date)

Leslie Foreman

(Title)

North line of Sec. 14
well brushed out 12' wide.

located 4 ch. N of Marshy
grassland.
Corner again.

Give any further facts which will aid in finding this
chains distant.

from which this Corner bears
N 28° E

side of Tree
tree 20 inches diameter, on the
NE

Metal Location Poster is on a
W.P.

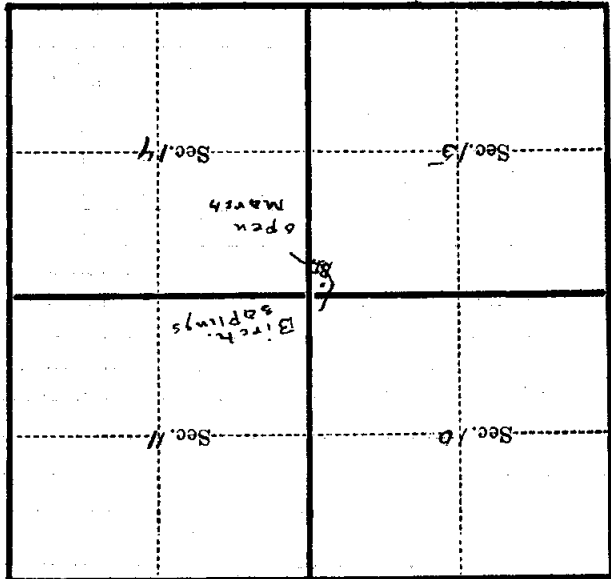

(Make sketch of topography near Corner)

T. 59N R. 26W 4th Mer.

U. S. Department of Agriculture
FOREST SERVICE

J-17

Chippewa

NATIONAL FOREST

CORNERS OF THE PUBLIC SURVEY

T. 59 N R. 26 W 4 P Mer.

Section 11

Corner common to Sections

10, 11, 14, and 15

Corner consists of a Stake (not) in place

State condition

Dimensions above ground inches

Sketch grooves, letters, figures, or notches, on proper face or edge.

CARDINAL POSITION

DIAGONAL POSITION

| | | | |
|--|--|--|--|
| | | | |
|--|--|--|--|

| | | | |
|----|----|----|----|
| 5 | 5 | 5 | 5 |
| 10 | 15 | 14 | 11 |

N W S E

NW SW SE NE

Mound of is located

Pits are located

Sketch markings of Bearing Trees (or Rocks) in proper box and fill blanks below, giving bearings from Corner to Trees and Distances in Links.

| | | | |
|--|------------------------|--|--|
| | T 59 N R 26 W 14 | | |
| | | | |

Species N. Pine

Diameter 20

Bearing S 70 W

Distance 0.9

Do you believe this to be a genuine Land Office Corner? No

If not, why? Co. Survey

George J. Janning

(Signature)

9-26-35

(Date)

J. J. Newman C+M

(Title)

Lined writing area with horizontal dashed lines.

Large B.I. leans SW

Corner again.

Give any further facts which will aid in finding this

0.09 chains distant.

from which this Corner bears

N20E

side of tree

tree 20 inches diameter, on the

W. Pine NE

Metal Location Poster is on a

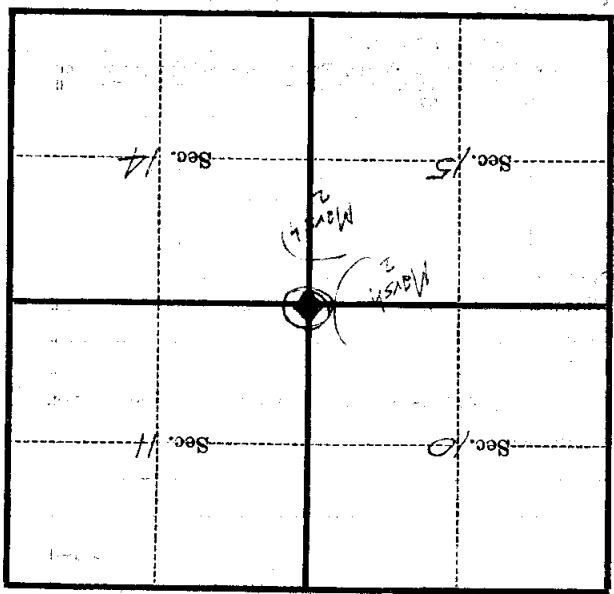

(Make sketch of topography near Corner)

T. R. Mer.