

U. S. Department of Agriculture
FOREST SERVICE

Posted
Chippewa NATIONAL FOREST L-17

CORNERS OF THE PUBLIC SURVEY

T. 59N R. 26W 4th Mer.

1/4 Corner common to Sections
14, and 15

Corner consists of a Wooden Stake (not) in place
State condition Preserving

Dimensions above ground 18 inches

Sketch grooves, letters, figures, or notches, on proper face or edge.

CARDINAL POSITION

DIAGONAL POSITION

	<u>1/4</u>		<u>1/4</u>
	<u>S15</u>		<u>S</u>
			<u>14</u>
N	W	S	E

NW	SW	SE	NE

Mound of _____ is located _____

Pits are located _____

Sketch markings of Bearing Trees (or Rocks) in proper box and fill blanks below, giving bearings from Corner to Trees and Distances in Links.

<u>obliterated</u>			
<u>BT</u>			

Species Cedar

Diameter 7"

Bearing N 40 W

Distance 10 ft

Do you believe this to be a genuine Land Office Corner? Yes

If not, why? Condition indicates

That post has not been

There for more than 20 yr.

Leonard J. Pulkrabek

(Signature)

Dec. 10, 1934

(Date)

Tech. Foreman

(Title)

Cover - Willow - Alder - Birch

South slope

located on a gentle

Corner again.

Give any further facts which will aid in finding this

chains distant.

18

from which this Corner bears S 47° W

side of Tree

tree 7 inches diameter, on the South

Metal Location Poster is on a Birch

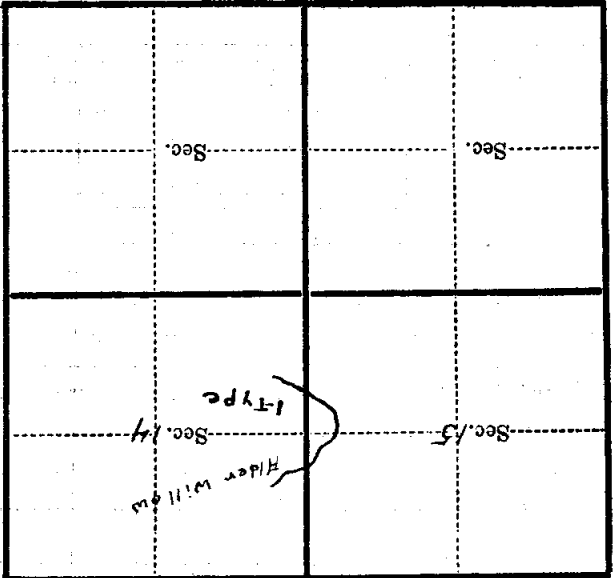

(Make sketch of topography near Corner)

T. 59N R. 26W 4th Mer.

U. S. Department of Agriculture
FOREST SERVICE

L-17

CHIPPewaWAG NATIONAL FOREST

CORNERS OF THE PUBLIC SURVEY

T. 59N R. 26W 4th Mer.

$\frac{1}{4}$ Corner common to Sections
14, and 15

Corner consists of a Wooden Stake (not) in place
State condition Decaying

Dimensions above ground 18 inches

Sketch grooves, letters, figures, or notches, on proper face or edge.

CARDINAL POSITION

DIAGONAL POSITION

	$\frac{1}{4}$		$\frac{1}{4}$
	S		S
	15		14

N W S E

NW SW SE NE

Mound of _____ is located _____

Pits are located _____

Sketch markings of Bearing Trees (or Rocks) in proper box and fill blanks below, giving bearings from Corner to Trees and Distances in Links.

Species _____

Diameter _____

Bearing _____

Distance _____

Do you believe this to be a genuine Land Office Corner? No

If not, why? Condition indicates that it has not been there for more than 20 yr.

Leonard J. Pulkrabek
(Signature)

Dec. 10, 1934
(Date)

Leh. Foreman
(Title)

Corner again.
located on a gentle
south slope.
Cover - Willow, Alder, Birch

Give any further facts which will aid in finding this
chains distant.
18
from which this Corner bears S 47° W
side of Tree
tree 2 inches diameter, on the south
Metal Location Poster is on a Birch

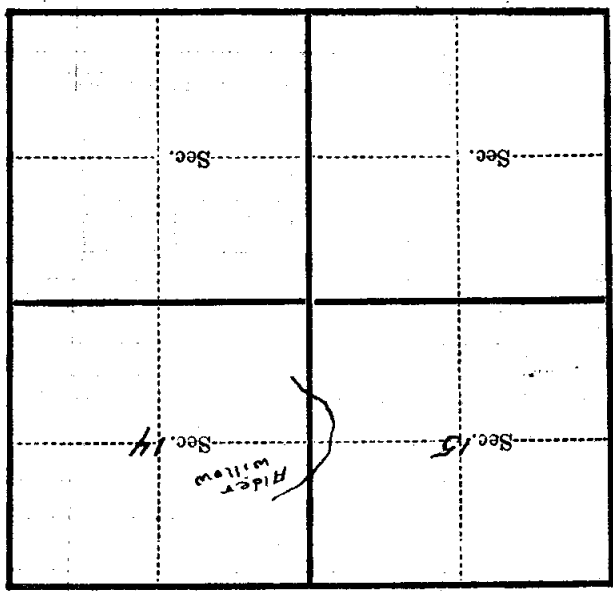

(Make sketch of topography near Corner)

T. 59N R. 26W 4th Mer.