

U. S. Department of Agriculture  
FOREST SERVICE

*Post*  
J-13

Chippewa NATIONAL FOREST

CORNERS OF THE PUBLIC SURVEY

T. 59N R. 26W 4th Mer.

Section Corner common to Sections  
9, 10, 15, and 16

Corner consists of a Cedar Post (not) in place  
State condition Good

Dimensions above ground 36 inches

Sketch grooves, letters, figures, or notches, on proper face or edge.

CARDINAL POSITION

DIAGONAL POSITION

--	--	--	--

N W S E

T59 R26 Sec 9	T59 R.26 Sec 16	T59 R26 Sec. 15	T59 R26 Sec 10
---------------------	-----------------------	-----------------------	----------------------

NW SW SE NE

Mound of \_\_\_\_\_ is located \_\_\_\_\_

Pits are located \_\_\_\_\_

Sketch markings of Bearing Trees (or Rocks) in proper box and fill blanks below, giving bearings from Corner to Trees and Distances in Links.

	T59 R26 Sec 9		
	B.T.		

Species Tamarack (Dead)

Diameter 7.5"

Bearing N85°W

Distance 30 ch.

Do you believe this to be a genuine Land Office Corner? No

If not, why? Corner post was put in in 1933

B.T. is original

*Edward J. Palkivaluk*  
(Signature)

Nov 2, 1934  
(Date)

Ed. Forman  
(Title)

-----

-----

-----

-----

-----

-----

-----

-----

-----

-----

Corner again.

Give any further facts which will aid in finding this  
 .40 chains distant.  
 from which this Corner bears Due North  
 side of The Tree  
 tree .4 inches diameter, on the North  
 Metal Location Poster is on a Black Spruce

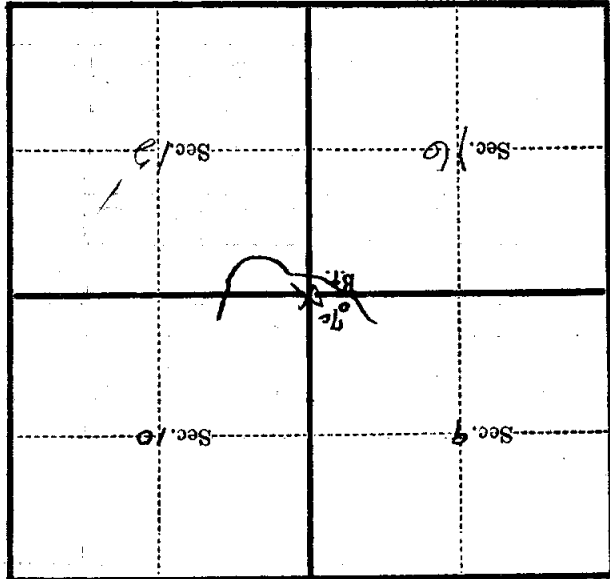

(Make sketch of topography near Corner)

## U. S. Department of Agriculture

FOREST SERVICE

J-13

CHIPPEWA NATIONAL FOREST

## CORNERS OF THE PUBLIC SURVEY

T. 59 N R. 26 W 4<sup>th</sup> Mer.

SECTION Corner common to Sections

9, 10, 15, and 16Corner consists of a CORNER POST (not) in placeState condition GOODDimensions above ground 36 inches

Sketch grooves, letters, figures, or notches, on proper face or edge.

CARDINAL POSITION

DIAGONAL POSITION

--	--	--	--

N W S E

T59	T59	T59	T59
R26	R26	R26	R26
SEC.	SEC.	SEC.	SEC.
9	16	15	10

NW SW SE NE

Mound of \_\_\_\_\_ is located \_\_\_\_\_

Pits are located \_\_\_\_\_

Sketch markings of Bearing Trees (or Rocks) in proper box and fill blanks below, giving bearings from Corner to Trees and Distances in Links.

	T59 R26 SEC 9		
	B.T.		

Species TAMARACK (DEAD)Diameter 7.5"Bearing N85°W.Distance 30 chs.Do you believe this to be a genuine Land Office Corner? NoIf not, why? CORNER POST WAS PUT ININ 1933. IT IS ORIGINAL.

(Signature)

11/2/34

(Date)

PULKRANK

(Title)

Corner again.

Give any further facts which will aid in finding this

40 chains distant.

from which this Corner bears **DUE NORTH**

side of **THE TREE**

tree **4** inches diameter, on the **NORTH**

Metal Location Poster is on a **BLACK SPRUCE**

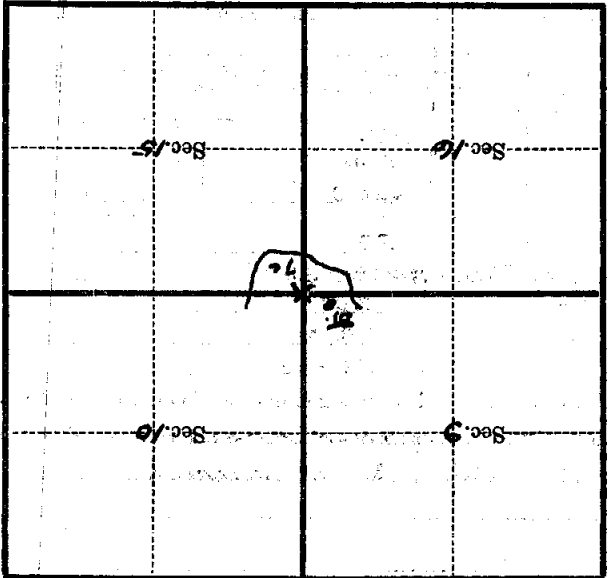

(Make sketch of topography near Corner)

T. 59 N. R. 26 W. #22 Mer.

**U. S. Department of Agriculture**  
**FOREST SERVICE**

*Posted*  
*J-13*

CHIPPEWA NATIONAL FOREST

**CORNERS OF THE PUBLIC SURVEY**

T. 59 N R. 26 Ath. Mer.

Sec. Corner common to Sections  
9, 10, 15, and 16

Corner consists of a Cedar Post (not) in place  
State condition Good

Dimensions above ground 36 inches

Sketch grooves, letters, figures, or notches, on proper face or edge.

CARDINAL POSITION

DIAGONAL POSITION

--	--	--	--

N      W      S      E

T59	T59	T59	T59
R26	R26	R26	R26
Sec.	Sec.	Sec.	Sec.
9	16	15	10

NW    SW    SE    NE

Mound of \_\_\_\_\_ is located \_\_\_\_\_

Pits are located \_\_\_\_\_

Sketch markings of Bearing Trees (or Rocks) in proper box and fill blanks below, giving bearings from Corner to Trees and Distances in Links.

	T59 R26 Sec. 9		
	B.T.		

Species Tamarack (Dead)

Diameter 7.5

Bearing N 85° W

Distance 30 chs.

Do you believe this to be a genuine Land Office Corner? No

If not, why? Corner was put in in 1933

B.T. is original

*Leonard J. Paulkratik*

(Signature)

Nov. 7, 1934

(Date)

*Tech. Foreman*

(Title)

Corner again.

Give any further facts which will aid in finding this

4 chains distant.

from which this Corner bears Due North

side of The Tree

tree 4 inches diameter, on the North

Metal Location Poster is on a Black Spruce

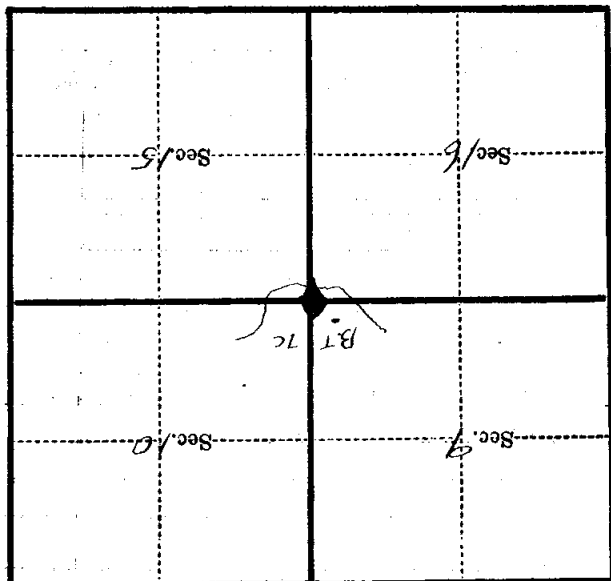

(Make sketch of topography near Corner)

T 59N R 26W 475 Mer.

U. S. Department of Agriculture  
FOREST SERVICE

*Posted J-13*

Chippewa NATIONAL FOREST

CORNERS OF THE PUBLIC SURVEY

T. 59N R. 26W 4th Mer.

Section Corner common to Sections  
9, 10, 15, and 16

Corner consists of a Cedar Post (not) in place  
State condition Good

Dimensions above ground 36 inches  
Sketch grooves, letters, figures, or notches, on proper face or edge.

CARDINAL POSITION

DIAGONAL POSITION

--	--	--	--

T59	T59	T59	T59
R26	R26	R26	R26
Sec	Sec	Sec	Sec
9	16	15	10

N W S E

NW SW SE NE

Mound of \_\_\_\_\_ is located \_\_\_\_\_

Pits are located \_\_\_\_\_

Sketch markings of Bearing Trees (or Rocks) in proper box and fill blanks below, giving bearings from Corner to Trees and Distances in Links.

	T59 R26 Sec. 9		
	B.T.		

Species Tamarack (Dead)

Diameter 7.5"

Bearing N85°W

Distance 30 ch.

Do you believe this to be a genuine Land Office Corner? No

If not, why? Corner post was put in in 1933

B.T. is original

Leonard J. Peltz

(Signature)

Nov 2, 1934

(Date)

Rich Foreman

(Title)

.....  
.....  
.....  
.....  
.....  
.....  
.....  
.....

Corner again.

Give any further facts which will aid in finding this

..... chains distant.

40

Bar north

from which this Corner bears

side of *the tree*

tree 4 inches diameter, on the

North

Metal Location Poster is on a

*Black Spruce*

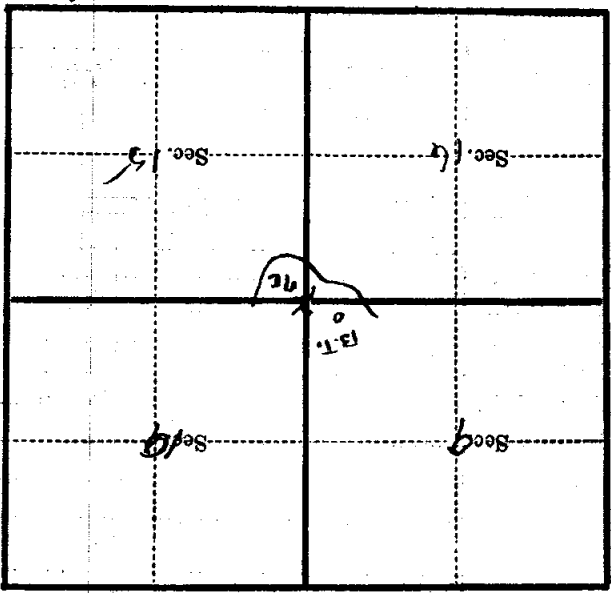

(Make sketch of topography near Corner)

T. 59 N. R. 26 W. 4<sup>th</sup> Mer.