

U. S. Department of Agriculture

FOREST SERVICE

N-3 P

Chippewa NATIONAL FOREST

CORNERS OF THE PUBLIC SURVEY

T. 59N R. 26W 4th P Mer.

1/4 Corner common to Sections 18, and 19

Corner consists of a (not) a place

State condition

Dimensions above ground inches

Sketch grooves, letters, figures, or notches, on proper face or edge.

CARDINAL POSITION

DIAGONAL POSITION

Diagram for cardinal positions: N, W, S, E

N W S E

Diagram for diagonal positions: NW, SW, SE, NE

NW SW SE NE

Mound of is located

Pits are located

Sketch markings of Bearing Trees (or Rocks) in proper box and fill blanks below, giving bearings from Corner to Trees and Distances in Links.

Grid of boxes for sketching trees and rocks

Species

Diameter

Bearing

Distance

Do you believe this to be a genuine Land Office Corner? No

If not, why? U.S.F.S

George H. Jennings

(Signature)

8-20-35

(Date)

Const Foreman C & M

(Title)

Corner again.

Give any further facts which will aid in finding this

0.13 chains distant.

from which this Corner bears N60°E

side of tree

tree 4 inches diameter, on the N

Metal Location Poster is on a Cedar

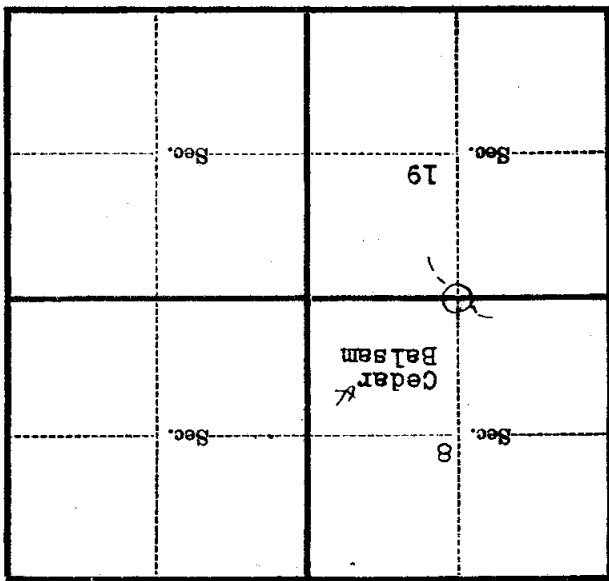

(Make sketch of topography near Corner)

U. S. Department of Agriculture
FOREST SERVICE

N-3

Chippewa NATIONAL FOREST

CORNERS OF THE PUBLIC SURVEY

T. 59 N R. 26 W 4th P Mer.

1/4 Corner common to Sections
18, and 19

Corner consists of a _____ (not) in place
State condition _____

Dimensions above ground _____ inches

Sketch grooves, letters, figures, or notches, on proper face or edge.

CARDINAL POSITION

DIAGONAL POSITION

--	--	--	--

--	--	--	--

N W S E

NW SW SE NE

Mound of _____ is located _____

Pits are located _____

Sketch markings of Bearing Trees (or Rocks) in proper box and fill blanks below, giving bearings from Corner to Trees and Distances in Links.

Species _____

Diameter _____

Bearing _____

Distance _____

Do you believe this to be a genuine Land Office Corner? N

If not, why? U.S.F.S

George H. Jennings

(Signature)

8-20-35

(Date)

Const. Foreman C.M.

(Title)

Series of horizontal dashed lines for writing.

Corner again.

Give any further facts which will aid in finding this

0.13 chains distant.

from which this Corner bears N 60 E

side of tree

tree 4 inches diameter, on the N

Metal Location Poster is on a Cedar

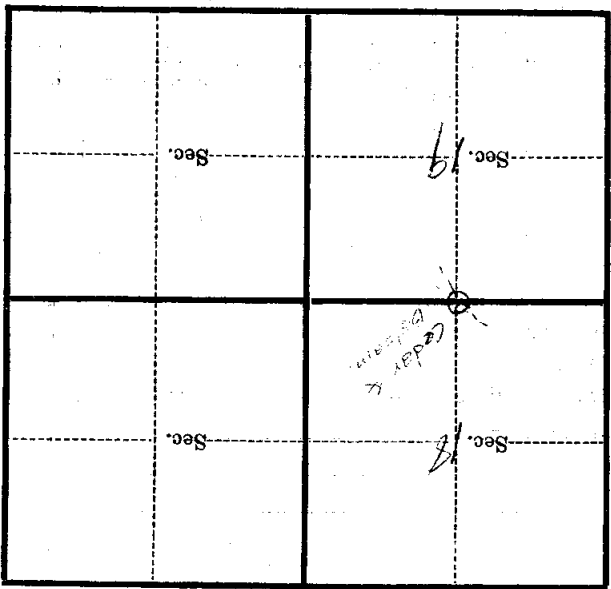

(Make sketch of topography near Corner)

T. 59 N R. 26 W A P Mer.