

U. S. Department of Agriculture
FOREST SERVICE

N-21

Chippewa NATIONAL FOREST

CORNERS OF THE PUBLIC SURVEY

T. 58N R. 27W 4th P.M. Mer.

Section

Corner common to Sections

14, 13, 23, and 24

Corner consists of a 4" Cedar & pipe (~~rod~~) in place

State condition Good

Dimensions above ground 38 inches

Sketch grooves, letters, figures, or notches, on proper face or edge.

CARDINAL POSITION

DIAGONAL POSITION

--	--	--	--

N W S E

S14	S23	S24	S13
-----	-----	-----	-----

NW SW SE NE

Mound of _____ is located _____

Pits are located _____

Sketch markings of Bearing Trees (or Rocks) in proper box and fill blanks below, giving bearings from Corner to Trees and Distances in Links.

S14 BT			

Species Birch

Diameter 14"

Bearing N13°W

Distance 15 Lks.

Do you believe this to be a genuine Land Office Corner? Yes

If not, why? _____

Sig. Hainard

(Signature)

G. F. P.

(Title)

11/13/36

(Date)

Corner again.
 Light brush. In slightly open
 field sloping toward S.
 Give any further facts which will aid in finding this

chains distant.
 0.15
 from which this Corner bears
 S13° E
 side of Mill. *Tree*
 tree 14 inches diameter, on the SE
 Metal Location Poster is on a Birch

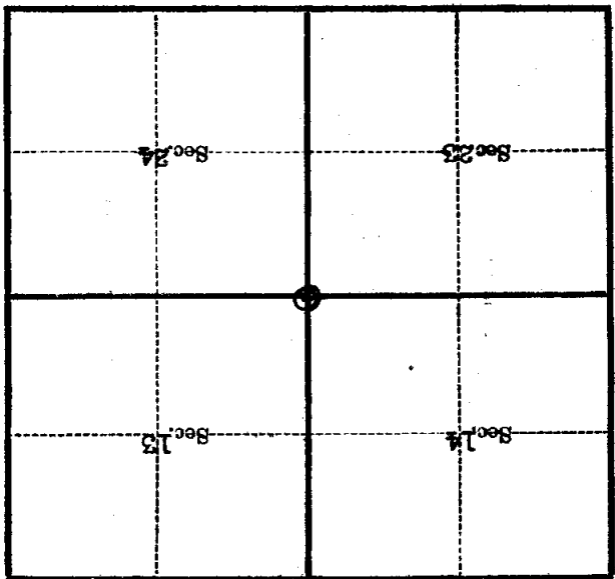

(Make sketch of topography near Corner)

U. S. Department of Agriculture

FOREST SERVICE

16-N

Chippewa NATIONAL FOREST

CORNERS OF THE PUBLIC SURVEY

T. 58N R. 27W 5th P. Mer.

Sec. Corner

Corner common to Sections

13 14

23

, and 24

Corner consists of a Cedar (mark in place

State condition Good

Dimensions above ground 5'39" X 36" inches

Sketch grooves, letters, figures, or notches, on proper face or edge.

CARDINAL POSITION

DIAGONAL POSITION

S 14	S 23	S 24	S 13
N	W	S	E

NW	SW	SE	NE

Mound of _____ is located _____

Pits are located _____

Sketch markings of Bearing Trees (or Rocks) in proper box and fill blanks below, giving bearings from Corner to Trees and Distances in Links.

S 14

S 24

--

--

B.T.

B.T.

--

--

Species Birch N.P. Stump

Diameter 10" 28"

Bearing N 12 W N 80 E

Distance 15 links 60 links

Do you believe this to be a genuine Land Office Corner? No

If not, why? County corner

C. Fidely
C. Fidely
(Signature)

3/10/41
(Date)

Leader
(Title)



Corner is on the south west side of Hill 1 chain south center swamp

Corner again.

Give any further facts which will aid in finding this

15 links chains distant.

from which this Corner bears S. 12 E.

side of Birch

tree 10 inches diameter, on the southeast

Metal Location Poster is on a 10" Birch

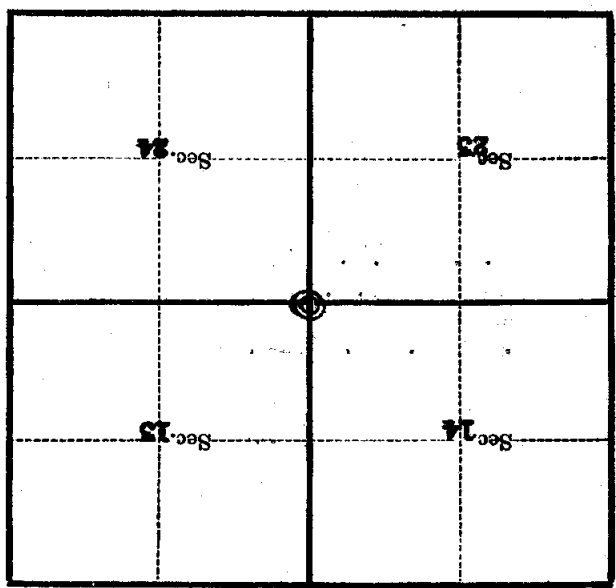

(Make sketch of topography near Corner)

U. S. Department of Agriculture

FOREST SERVICE

18-N

Chippewa NATIONAL FOREST

CORNERS OF THE PUBLIC SURVEY

T. 58N. R. 27W 4th P.M. Mer.

Section

Corner common to Sections

14, 13, 23, and 24

Corner consists of a Cedar & pipe (not) in place

State condition Good

Dimensions above ground 38 inches

Sketch grooves, letters, figures, or notches, on proper face or edge.

CARDINAL POSITION

DIAGONAL POSITION

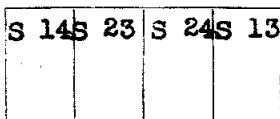
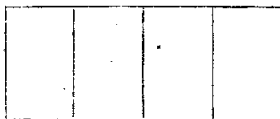

Mound of is located

Pits are located

Sketch markings of Bearing Trees (or Rocks) in proper box and fill blanks below, giving bearings from Corner to Trees and Distances in Links.



Species Birch

Diameter 14"

Bearing N 13° W.

Distance 15 Lks.

Do you believe this to be a genuine Land Office Corner? Yes

If not, why? No

Ben L. ...

(Signature)

11/13/36

(Date)

(Title)

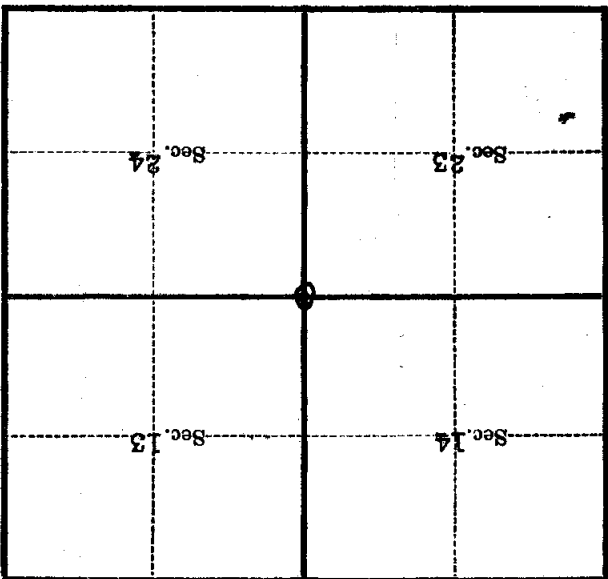

(Make sketch of topography near Corner)

T. 58N R. 27W. 4th P.M. Mer.

Metal Location Poster is on a Birch

tree 14 inches diameter, on the S E

side of ~~1111~~ Rec.

from which this Corner bears S 13° E

0.15 chains distant.

Give any further facts which will aid in finding this

Corner again.

Light brush. In slightly open field sloping toward S.

U. S. Department of Agriculture
 FOREST SERVICE
 18-N
CHIPPEWA NATIONAL FOREST

CORNERS OF THE PUBLIC SURVEY

 T. 59N R. 27W 4th Mer.

Sec Corner common to Sections
14, 13, 23, and 24

 Corner consists of a post (~~not~~) in place

 State condition Badly decayed

Dimensions above ground _____ inches

Sketch grooves, letters, figures, or notches, on proper face or edge.

CARDINAL POSITION

DIAGONAL POSITION

--	--	--	--

N W S E

S14	S23	S24	S13
-----	-----	-----	-----

NW SW SE NE

Mound of _____ is located _____

Pits are located _____

Sketch markings of Bearing Trees (or Rocks) in proper box and fill blanks below, giving bearings from Corner to Trees and Distances in Links.

S 14	S 23	S 24	S 13
B.T.	B.T.	B.T.	B.T.

 Species SPT B&L BT BT

 Diameter 6" 9" 6" 6"

 Bearing N58°W S42°W S42°E N45°W

 Distance 0.41 0.34 4.5 0.34

 Do you believe this to be a genuine Land Office Corner? Yes

If not, why? _____

Ea Laven
 (Signature)

12/17-34
 (Date)

(Title)

Metal Location Poster is on a tree _____ inches diameter, on the side of _____ from which this Corner bears _____ chains distant.

Give any further facts which will aid in finding this Corner again.

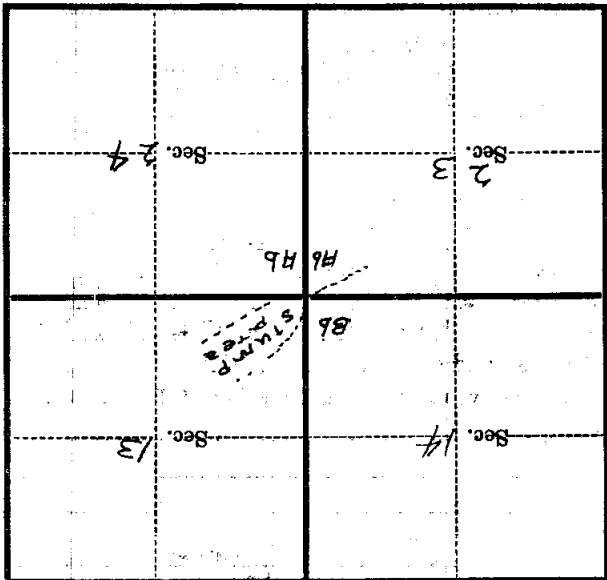

(Make sketch of topography near Corner)

U. S. Department of Agriculture
FOREST SERVICE

16-N

Chippewa NATIONAL FOREST

CORNERS OF THE PUBLIC SURVEY

T. 59 N R. 27 W 4 Mer.

Section Corner common to Sections

141, 12, 24, and 23

Corner consists of a Tap P (not) in place

State condition Good

Dimensions above ground 24 inches

Sketch grooves, letters, figures, or notches, on proper face or edge.

CARDINAL POSITION

DIAGONAL POSITION

--	--	--	--

S	P	S	139
23	27W	13	N 3 18

N W S E

NW SW SE NE

Mound of _____ is located _____

Pits are located _____

Sketch markings of Bearing Trees (or Rocks) in proper box and fill blanks below, giving bearings from Corner to Trees and Distances in Links.

S	S	S	S
13	24	23	14
BT	BT	BT	BT

Species Birch Birch Balsam Spruce

Diameter 4" 4" 9" 2"

Bearing N 56° E S 14° E S 49° W N 50° W

Distance 3.41 ch .46 ch .35 ch .52 ch

Do you believe this to be a genuine Land Office Corner? Yes

If not, why? _____

Arnold Larson

(Signature)

C. C. Enslin

(Title)

1-10-35

(Date)

Corner again.
 This corner is on a No. 5
 line cleared about 4 ft wide
 compared with 70 ft

Give any further facts which will aid in finding this
 point - points distant.
 from which this Corner bears **N 25° E**
 side of **Tree**
 tree 10 inches diameter, on the **NNE**
 Metal Location Poster is on a **Balloon**

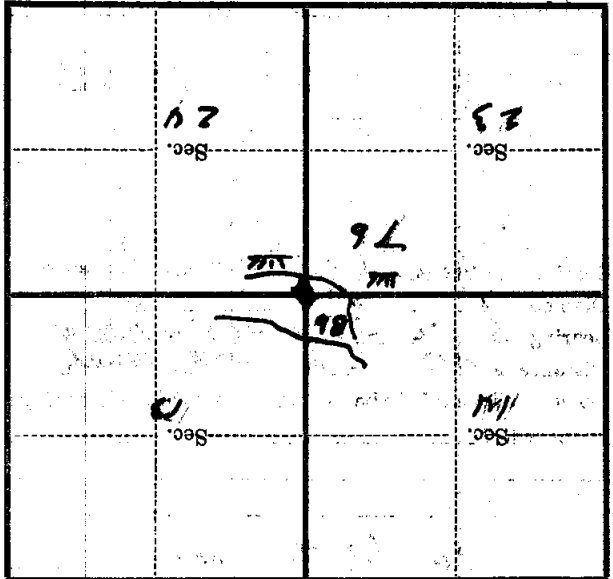

(Make sketch of topography near Corner)

T. 59 N. R. 27 W. Mer.

U. S. Department of Agriculture
FOREST SERVICE

Chippewa NATIONAL FOREST

CORNERS OF THE PUBLIC SURVEY

T. 59 N R. 27 W 4th Mer.

Sec. Corner common to Sections
14, 13, 23, and 24

Corner consists of a post (~~not~~) in place

State condition Badly ~~decayed~~ decayed

Dimensions above ground DOWN inches

Sketch grooves, letters, figures, or notches, on proper face or edge.

CARDINAL POSITION

DIAGONAL POSITION

--	--	--	--

N W S E

S14	S23	S29	S13
-----	-----	-----	-----

NW SW SE NE

Mound of _____ is located _____

Pits are located _____

Sketch markings of Bearing Trees (or Rocks) in proper box and fill blanks below, giving bearings from Corner to Trees and Distances in Links.

S 14	S 23	S 24	S 13
B.T.	B.T.	B.T.	B.T.

Species SPT. B2L. BT BT

Diameter 6" 9" 6" 6"

Bearing N58°W S42°W S42°E N45°E

Distance 0.41 .34 .45 0.34

Do you believe this to be a genuine Land Office Corner? yes

If not, why? _____

E. A. Sagen
(Signature)

12/17-34
(Date)

(Title)

N-91
16-91

Metal Location Posters on a tree _____ inches diameter, on the _____ side of _____ from which this Corner bears _____ chains distant. _____ Give any further facts which will aid in finding this Corner again.

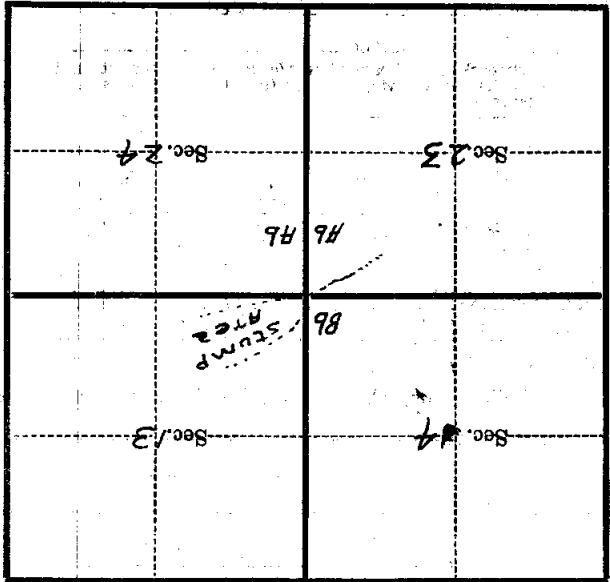

(Make sketch of topography near Corner)

T. 59 R. 27 4T4 Mer.

U. S. Department of Agriculture

FOREST SERVICE

chippewa NATIONAL FOREST ^{N21}

CORNERS OF THE PUBLIC SURVEY

T. 58N R. 27W 5th P. Mer.

Sec. corner

Corner common to Sections

13 14 23 and 24

Corner consists of a cedar ~~tree~~ in place

State condition Good

Dimensions above ground 5*39. X 36* inches

Sketch grooves, letters, figures, or notches, on proper face or edge.

CARDINAL POSITION

DIAGONAL POSITION

S	S	S	S
14	23	24	13
N	W	S	E

NW	SW	SE	NE

Mound of _____ is located _____

Pits are located _____

Sketch markings of Bearing Trees (or Rocks) in proper box and fill blanks below, giving bearings from Corner to Trees and Distances in Links.

S	S		
14	24		
B.T.	B.T.		

Species Birch W.P. Stump

Diameter 10* 28*

Bearing N. 12° W. N. 88° E.

Distance 15 links 60 links

Do you believe this to be a genuine Land Office Corner? **N^o**

If not, why? **County corner**

C. Fideldy
C. Fideldy

(Signature)

Leader

(Title)

3/10/41

(Date)

(Make sketch of topography near Corner)

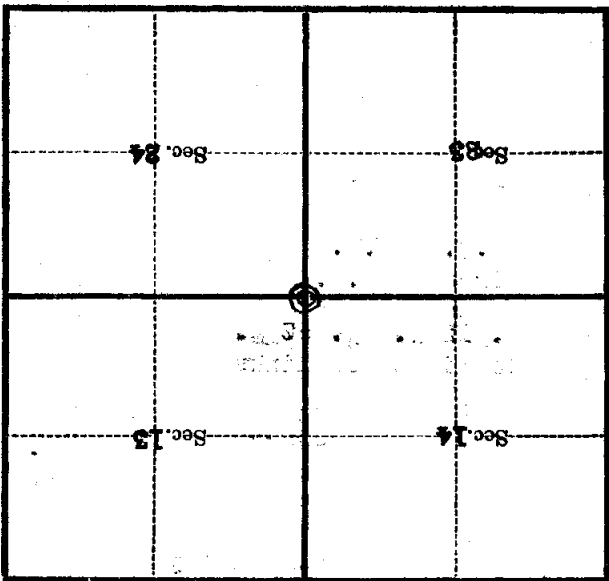

Metal Location Poster is on a 10" Birch

tree 10 inches diameter, on the southeast

side of Birch

from which this Corner bears

S. 12° E.

15 links chains distant.

Give any further facts which will aid in finding this

Corner again.

Corner is on the south west side of

hill chain south center swamp

U. S. Department of Agriculture
FOREST SERVICE

Chippewa NATIONAL FOREST

CORNERS OF THE PUBLIC SURVEY

T. 59N R. 27W 4 Mer.

S Corner common to Sections

14, 13, 23, and 24

Corner consists of a Tam Post in place

State condition Good

Dimensions above ground 24 inches

Sketch grooves, letters, figures, or notches, on proper face or edge.

CARDINAL POSITION

DIAGONAL POSITION

--	--	--	--

N W S E

<u>5</u>	<u>R</u>	<u>5</u>	<u>T59</u>
<u>23</u>	<u>27W</u>	<u>13</u>	<u>N</u>
			<u>S</u>
			<u>14</u>

NW SW SE NE

Mound of _____ is located _____

Pits are located _____

Sketch markings of Bearing Trees (or Rocks) in proper box and fill blanks below, giving bearings from Corner to Trees and Distances in Links.

<u>S</u> <u>13</u>	<u>S</u> <u>24</u>	<u>S</u> <u>23</u>	<u>S</u> <u>14</u>
<u>BT</u>	<u>BT</u>	<u>BT</u>	<u>BT</u>

Species Birch Birch Balsam Spruce

Diameter 4" 4" 8" 3"

Bearing N56E S44E S49W N50W

Distance 0.34 0.46 0.35 0.52

Do you believe this to be a genuine Land Office Corner? Yes

If not, why? _____

Arnold Larsen

(Signature)

1-10-35
(Date)

C.C.C. Enrollee
(Title)

Compass set of 70 W

This corner is on N-S
line cleared about 4'
wide
Corner again.

Give any further facts which will aid in finding this
0.20 chains distant.
from which this Corner bears N 25 E
side of tree
tree 10 inches diameter, on the NE
Metal Location Poster is on a Balsam

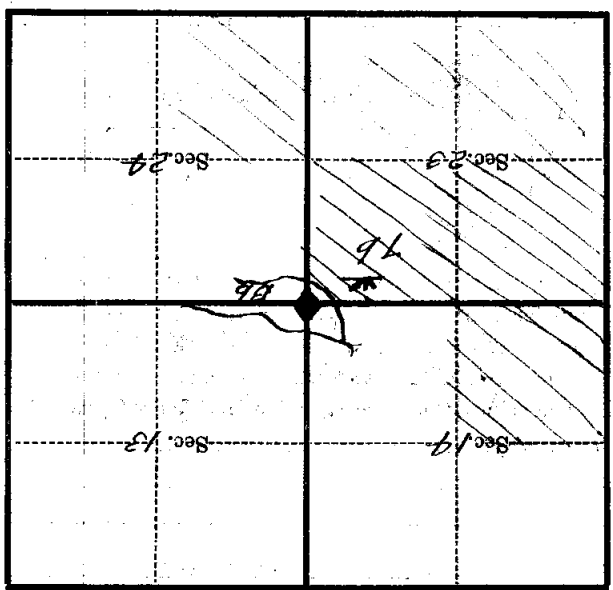

(Make sketch of topography near Corner)

T. 59 N. R. 27 W. 9 Mer.