

U. S. Department of Agriculture
FOREST SERVICE

A-19

Chippewa NATIONAL FOREST

CORNERS OF THE PUBLIC SURVEY

T. 58-59N R. 27W 4 Mer.

1/2 Corner common to Sections
35, and 2

Corner consists of a Post ~~xxx~~ in place

State condition Good

Dimensions above ground 30 inches

Sketch grooves, letters, figures, or notches, on proper face or edge.

CARDINAL POSITION

DIAGONAL POSITION

T59N		1/2	
R27W		8	
1/2		2	
835	W	S	E

	NW	SW	SE NE

Mound of _____ is located _____

Pits are located _____

Sketch markings of Bearing Trees (or Rocks) in proper box and fill blanks below, giving bearings from Corner to Trees and Distances in Links.

T59N R27W 835	T58N R27W 82		
BT			

Species Stump Spruce
 Diameter 14" 14"
 Bearing N35W S19E
 Distance 0.55 0.94

Do you believe this to be a genuine Land Office Corner? Yes

If not, why? _____

Paul Nelson

(Signature)

CCC Enrollee

(Title)

4-2-35
(Date)

Dotted lines for notes.

Corner again.

Give any further facts which will aid in finding this

chains distant.

S281

from which this Corner bears

side of

Tree

tree 5 inches diameter, on the SE

Metal Location Poster is on a Spruce

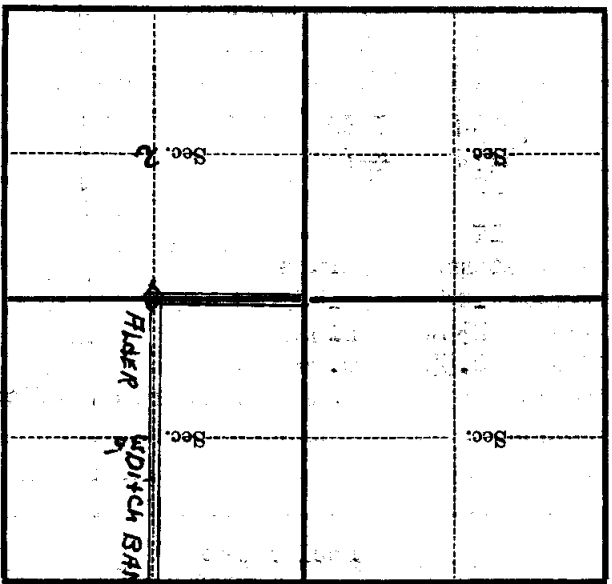

(Make sketch of topography near Corner)

U. S. Department of Agriculture
FOREST SERVICE

Posted

Chippewa NATIONAL FOREST *A 19*

CORNERS OF THE PUBLIC SURVEY

T. 58-59N R. 27W 4 Mer.

4 Corner common to Sections
35, and 2

Corner consists of a Post (~~box~~) in place

State condition Good

Dimensions above ground 30 inches

Sketch grooves, letters, figures, or notches, on proper face or edge.

CARDINAL POSITION

DIAGONAL POSITION

T59N			
R27W			
<u>4</u>		<u>2</u>	
S35			
N	W	S	E

NW	SW	SE	NE

Mound of _____ is located _____

Pits are located _____

Sketch markings of Bearing Trees (or Rocks) in proper box and fill blanks below, giving bearings from Corner to Trees and Distances in Links.

T59N	T58N		
R27W	R27W		
S35	S2		
BT			

Species Stump Spruce

Diameter 14" 14"

Bearing N35W S19E

Distance 0.55 0.94

Do you believe this to be a genuine Land Office Corner? Yes

If not, why? _____

Paul Nelson

(Signature)

CCC Enrollee

(Title)

4-2-35

(Date)

Corner again.

Give any further facts which will aid in finding this

0.83 chains distant.

from which this Corner bears S28E

side of Tree

tree 5 inches diameter, on the SE

Metal Location Poster is on a Spruce

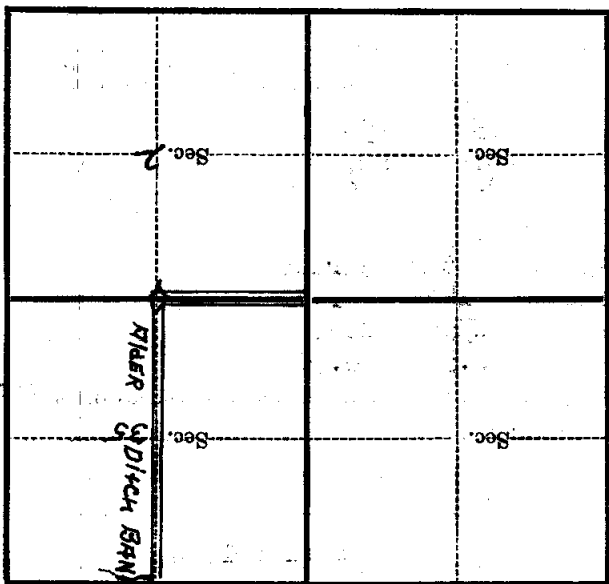

(Make sketch of topography near Corner)