

Form 874-9—Revised May, 1918  
 U. S. Department of Agriculture  
 FOREST SERVICE

*Marcell*

*U-19*

Chicago

NATIONAL FOREST

CORNERS OF THE PUBLIC SURVEY

T. 53 R. 37 4th Mer.

Corner common to Sections  
26, and 35

Corner consists of a \_\_\_\_\_ (not) in place

State condition Corner not present

Dimensions above ground it is in the center of road inches

Sketch grooves, letters, figures, or notches, on proper face or edge.

CARDINAL POSITION

DIAGONAL POSITION

--	--	--	--

N W S E

--	--	--	--

NW SW SE NE

Mound of \_\_\_\_\_ is located \_\_\_\_\_

Pits are located \_\_\_\_\_

Sketch markings of Bearing Trees (or Rocks) in proper box and fill blanks below, giving bearings from Corner to Trees and Distances in Links.

35 <sup>3</sup>			
U.T.			

Species Red Pine stump

Diameter 14"

Bearing 330°

Distance 33 links

Do you believe this to be a genuine Land Office Corner?

no? data taken from the original C.L.O. notes.

*Devon R. ...*  
 (Signature)

1/27/52  
 (Date)

Engr. A.D.  
 (Title)

-----

-----

-----

-----

-----

-----

-----

-----

-----

-----

Corner again.

Give any further facts which will aid in finding this

----- chains distant.

----- from which this Corner bears

----- side of ~~T.P. 147~~

----- ~~tree~~ 5 inches diameter, on the ~~west~~

----- Metal Location Poster is on a ~~post~~

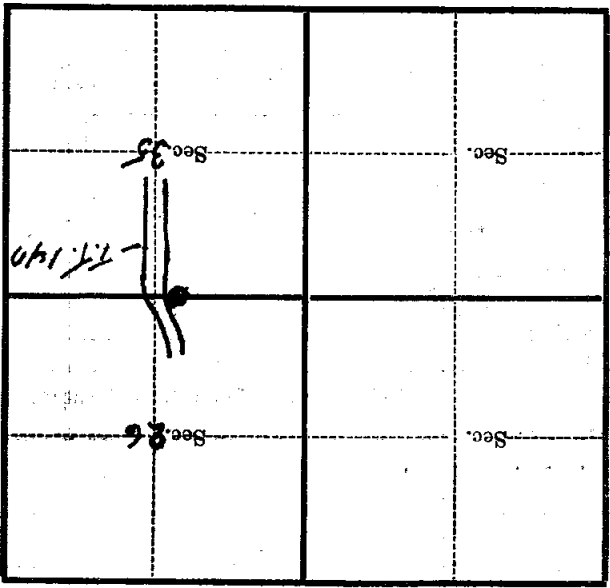

(Make sketch of topography near Corner)

U. S. Department of Agriculture

FOREST SERVICE

Chippewa

NATIONAL FOREST

CORNERS OF THE PUBLIC SURVEY

T. 58 R. 27 4th. Mer.

Corner common to Sections

20, and 35

Corner consists of a (not) in place

State condition Corner not Present because

Dimensions above ground it is in the center of road. inches

Sketch grooves, letters, figures, or notches, on proper face or edge.

CARDINAL POSITION

DIAGONAL POSITION

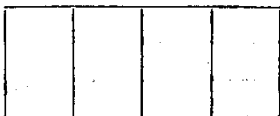

N W S E

NW SW SE NE

Mound of is located

Pits are located

Sketch markings of Bearing Trees (or Rocks) in proper box and fill blanks below, giving bearings from Corner to Trees and Distances in Links.

Table with 4 columns for trees and 2 rows for bearings and B.T. labels.

Species Red Pine Stump

Diameter 14"

Bearing S35°E

Distance 33 Links

Do you believe this to be a genuine Land Office Corner? yes

Data taken from the original

G.L.O. notes.

Handwritten signature of Vernon D. Lincoln

(Signature)

1/22/52 (Date)

Handwritten title: Camps, R. D.

(Title)

-----

-----

-----

-----

-----

-----

-----

-----

Corner again.

Give any further facts which will aid in finding this  
 ----- chains distant.  
 ----- from which this Corner bears  
 ----- side of ----- 167  
 ----- tree - 5 inches diameter, on the west  
 ----- Metal Location Poster is on a Post

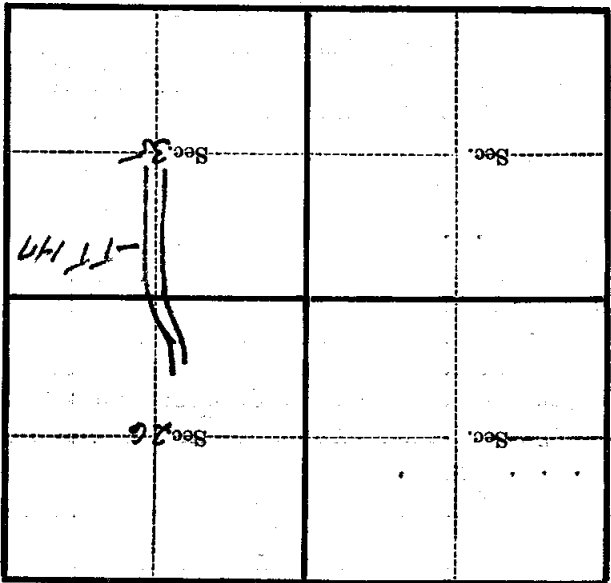

(Make sketch of topography near Corner)

U. S. Department of Agriculture  
FOREST SERVICE

Chippewa

NATIONAL FOREST V 19

CORNERS OF THE PUBLIC SURVEY

T. 58 R. 27 4th. Mer.

Corner common to Sections 26, and 35

Corner consists of a (not) in place  
State condition Corner not Present because  
Dimensions above ground it is in the center of road. inches

Sketch grooves, letters, figures, or notches, on proper face or edge.

CARDINAL POSITION

DIAGONAL POSITION

--	--	--	--

--	--	--	--

N W S E

NW SW SE NE

Mound of is located

Pits are located

Sketch markings of Bearing Trees (or Rocks) in proper box and fill blanks below, giving bearings from Corner to Trees and Distances in Links.

$\frac{1}{4}$ 35 <sup>S</sup>			
B.T.			

Species Red Pine Stump

Diameter 14"

Bearing S35°E

Distance 33 Links

Do you believe this to be a genuine Land Office Corner? yes

If not, Why? Data taken from the original

G.L.O. notes.

*Ernest A. Lindholm*  
(Signature)

1/22/52  
(Date)

*Ernest A. Lindholm*  
(Title)

Corner again.

Give any further facts which will aid in finding this

chains distant.

from which this Corner bears

side of T. 1. 147

tree 5 inches diameter, on the west

Post Metal Location Poster is on a

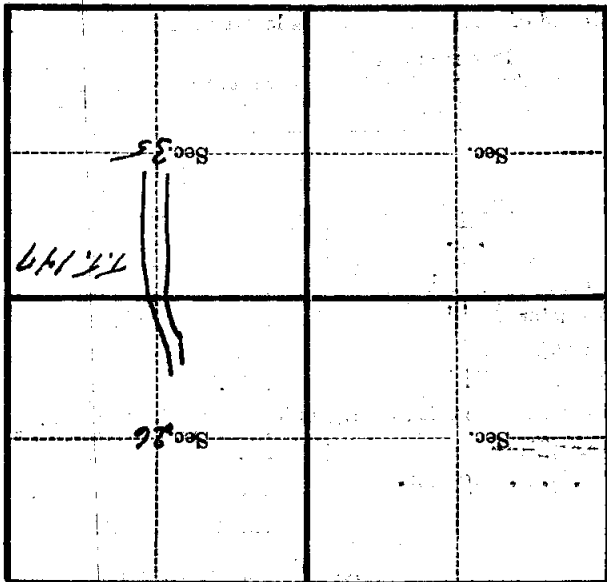

(Make sketch of topography near Corner)