

U. S. Department of Agriculture
FOREST SERVICE

A-17

Chippewa NATIONAL FOREST
CORNERS OF THE PUBLIC SURVEY

T. 52-59 N R. 27 W 9 Mer.

5 Corner common to Sections
34, 35, 2, and 3

Corner consists of a post (not) in place

State condition Good

Dimensions above ground 30" inches

Sketch grooves, letters, figures, or notches, on proper face or edge.

CARDINAL POSITION

DIAGONAL POSITION

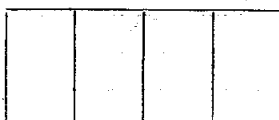
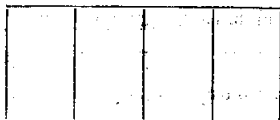

Mound of _____ is located _____

Pits are located _____

Sketch markings of Bearing Trees (or Rocks) in proper box and fill blanks below, giving bearings from Corner to Trees and Distances in Links.

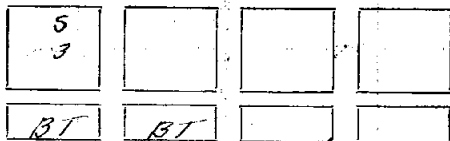

Species Cedar Balsam Gilead

Diameter 16" 18"

Bearing S70W S32W

Distance 1.02 0.91

Do you believe this to be a genuine Land Office Corner? Yes

If not, why? _____

Paul Nelson

(Signature)

9-1-35

(Date)

CCC Enrollee

(Title)

Corner again.

Give any further facts which will aid in finding this

0.64 chains distant.

from which this Corner bears

N 8 E

side of

Tree

tree *16* inches diameter, on the

N E

Metal Location Poster is on a *Balm-gilead*

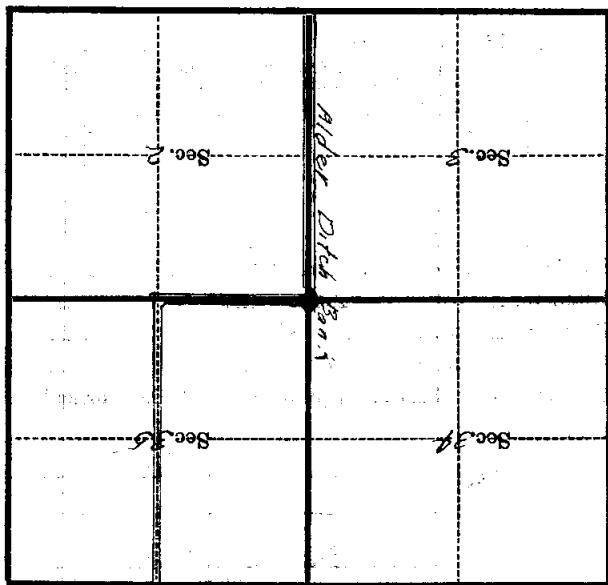

(Make sketch of topography near Corner)

T. 58-59 N R. 27 W. 4 Mer.

U. S. Department of Agriculture
FOREST SERVICE

A-17

~~OREGON~~ NATIONAL FOREST

CORNERS OF THE PUBLIC SURVEY

T. ~~22-59N~~ R. ~~27W~~ Mer.

Corner common to Sections ~~34~~, ~~35~~, ~~2~~, and ~~3~~

Corner consists of a ~~Post~~ ~~Stake~~ (not) in place
State condition ~~Good~~

Dimensions above ground ~~30~~ inches

Sketch grooves, letters, figures, or notches, on proper face or edge.

CARDINAL POSITION

DIAGONAL POSITION

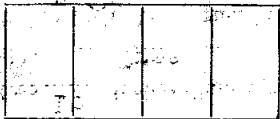

Mound of _____ is located _____

Pits are located _____

Sketch markings of Bearing Trees (or Rocks) in proper box and fill blanks below, giving bearings from Corner to Trees and Distances in Links.

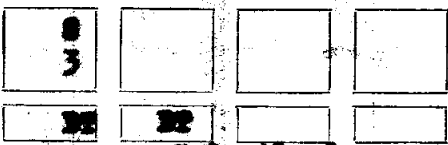

Species ~~Cedar~~ ~~Redwood~~

Diameter ~~16"~~ ~~18"~~

Bearing ~~S79W~~ ~~S34W~~

Distance ~~1.02~~ ~~0.91~~

Do you believe this to be a genuine Land Office Corner? _____

If not, why? _____

~~4-1-23~~

(Date)

(Signature)

~~W. L. ...~~
~~US Forest Service~~

Corner again.

Give any further facts which will aid in finding this

chains distant.

0.64

from which this Corner bears

N8E

side of **Trees**

tree 16 inches diameter, on the

NE

Metal Location Poster is on a **Balm Lead**

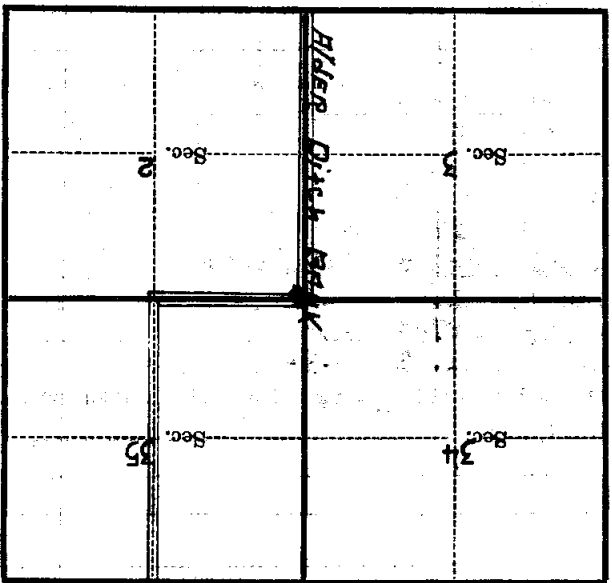

(Make sketch of topography near Corner)

U. S. Department of Agriculture
FOREST SERVICE

Posted

CHIPPWA NATIONAL FOREST *A17*

CORNERS OF THE PUBLIC SURVEY

T. 88-59N R. 27W 4 Mer.

8 Corner common to Sections

34, 35, 2, and 3

Corner consists of a Post (~~Rock~~) in place

State condition Good

Dimensions above ground 30 inches

Sketch grooves, letters, figures, or notches, on proper face or edge.

CARDINAL POSITION

DIAGONAL POSITION

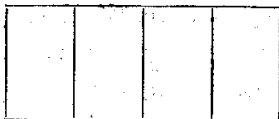

N W S E

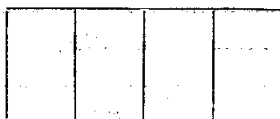

NW SW SE NE

Mound of _____ is located _____

Pits are located _____

Sketch markings of Bearing Trees (or Rocks) in proper box and fill blanks below, giving bearings from Corner to Trees and Distances in Links.

S 3			
BT	BT		

Species Cedar Balmgilead

Diameter 16" 18"

Bearing S79W S32W

Distance 1.02 0.91

Do you believe this to be a genuine Land Office Corner? Yes

If not, why? _____

(Signature)

Paul Nelson

(Title)

CCC Enrollee

4-1-35

(Date)

Faint, illegible text on ruled lines, possibly bleed-through from the reverse side of the page.

Corner again.
Give any further facts which will aid in finding this chains distant.
from which this Corner bears
side of
tree inches diameter, on the
Metal Location Poster is on a

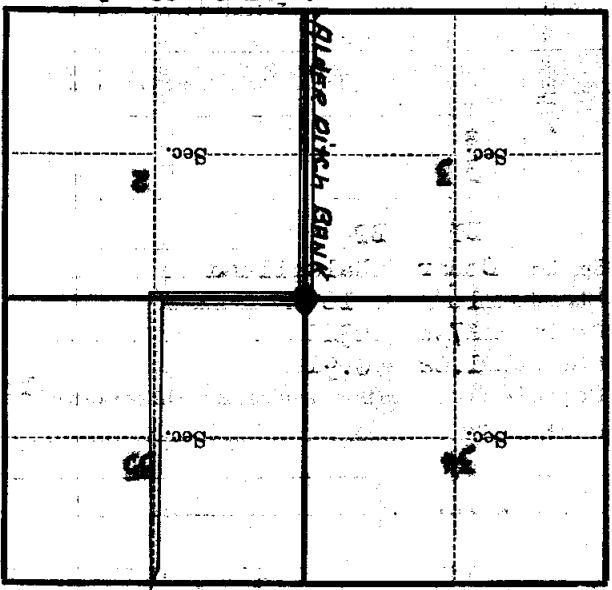

(Make sketch of topography near Corner)