

U. S. Department of Agriculture  
FOREST SERVICE

*Posted*

*Chippewa* NATIONAL FOREST

N 17

CORNERS OF THE PUBLIC SURVEY

T. *5-7N* R. *26W* 4<sup>th</sup> Mer.

Section Corner common to Sections  
*14, 15, 22, and 23*

Corner consists of a *iron pipe & wood post* (not) in place  
State condition *Good*

Dimensions above ground *pipe 6" post 24"* inches  
Sketch grooves, letters, figures, or notches, on proper face or edge.

CARDINAL POSITION

DIAGONAL POSITION

--	--	--	--

N W S E

<i>S</i> <i>15</i>	<i>S</i> <i>22</i>	<i>S</i> <i>23</i>	<i>S</i> <i>14</i>
-----------------------	-----------------------	-----------------------	-----------------------

NW SW SE NE

Mound of \_\_\_\_\_ is located \_\_\_\_\_

Pits are located \_\_\_\_\_

Sketch markings of Bearing Trees (or Rocks) in proper box and fill blanks below, giving bearings from Corner to Trees and Distances in Links.

	<i>S 22</i>	<i>S 23</i>	<i>S 14</i>
	<i>BT</i>	<i>BT</i>	<i>BT</i>

Species \_\_\_\_\_ *Maple Oak Oak*  
Diameter \_\_\_\_\_ *11" 9" 12"*  
Bearing \_\_\_\_\_ *S74°W S79°E N27°E*  
Distance \_\_\_\_\_ *12ft 33' 21'*

Do you believe this to be a genuine Land Office Corner? *Yes*

If not, why? \_\_\_\_\_

*Edgar J. Parker*  
*Sept 20 1914*  
(Date) \_\_\_\_\_ (Title) \_\_\_\_\_

Corner again.  
Trail starting from the  
road west of Sherwood  
Camp passes North  
200' west of corner

Give any further facts which will aid in finding this

15 feet chains distant.

from which this Corner bears N50E

side of Tree

tree 11. inches diameter, on the South

Maple Metal Location Poster is on a

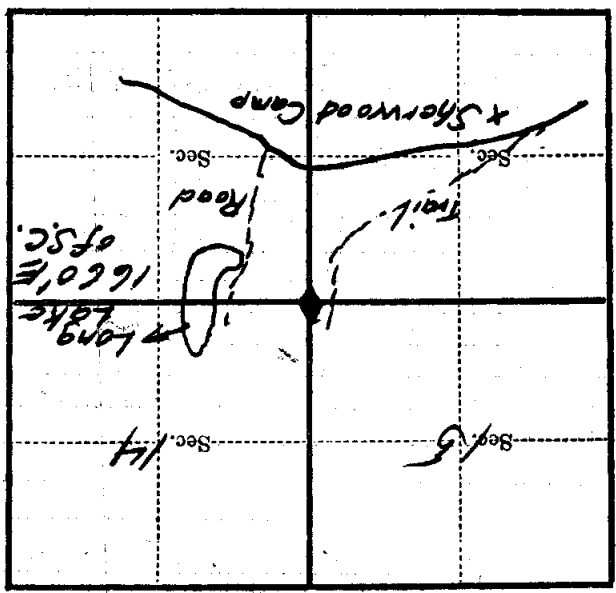

(Make sketch of topography near Corner)

T. 5714 R. 26W 4th Mer.