

U. S. Department of Agriculture  
FOREST SERVICE

D-5

NATIONAL FOREST

CORNERS OF THE PUBLIC SURVEY

T. 58 N R. 26 7th Mer.

S. 1/16 Corner common to Sections  
5, and 6

Corner consists of a ccc stake (not) in place  
State condition NEW

Dimensions above ground 36 inches

Sketch grooves, letters, figures, or notches, on proper face or edge.

CARDINAL POSITION

DIAGONAL POSITION



N W S E



NW SW SE NE

Mound of \_\_\_\_\_ is located \_\_\_\_\_

Pits are located \_\_\_\_\_

Sketch markings of Bearing Trees (or Rocks) in proper box and fill blanks below, giving bearings from Corner to Trees and Distances in Links.

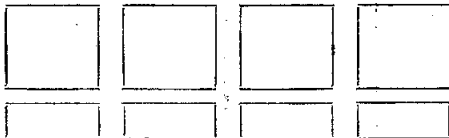

Species \_\_\_\_\_

Diameter \_\_\_\_\_

Bearing \_\_\_\_\_

Distance \_\_\_\_\_

Do you believe this to be a genuine Land Office Corner? Yes

If not, why? \_\_\_\_\_

Established by CCC employee

Harold Hamalainen

(Signature)

1/27/40

(Date)

CCC

(Title)

Handwritten notes on a set of four horizontal lines with dashed midlines.

located on T 591

Corner again.  
Give any further facts which will aid in finding this  
chains distant.  
from which this Corner bears  
side of  
tree inches diameter, on the  
Metal Location Poster is on a

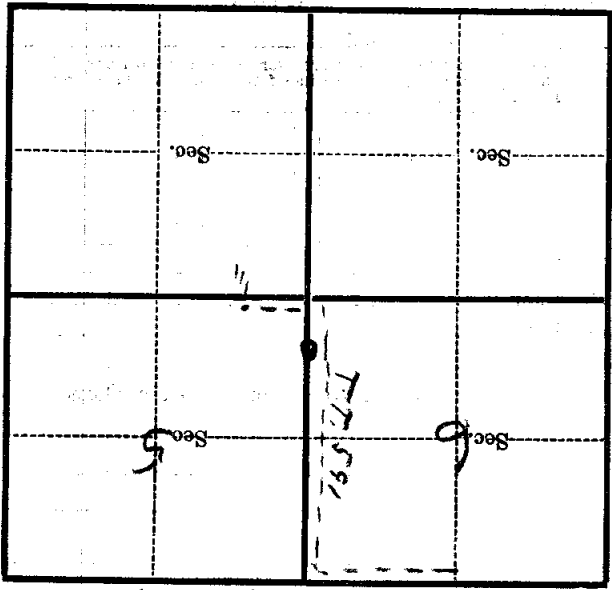

(Make sketch of topography near Corner)

T. R. Mer.