

U. S. Department of Agriculture
FOREST SERVICE

E-1

NATIONAL FOREST

CORNERS OF THE PUBLIC SURVEY

T. 58 R. 26-27 Mer.

Corner common to Sections

1, 12, 6, and 7

Corner consists of a _____ (not) in place

State condition _____

Dimensions above ground _____ inches

Sketch grooves, letters, figures, or notches, on proper face or edge.

CARDINAL POSITION

DIAGONAL POSITION

--	--	--	--

N W S E

--	--	--	--

NW SW SE NE

Mound of _____ is located _____

Pits are located _____

Sketch markings of Bearing Trees (or Rocks) in proper box and fill blanks below, giving bearings from Corner to Trees and Distances in Links.

Species *Aspen* *Aspen* _____

Diameter *15"* *17"* _____

Bearing *S 30° E* *S 10° W* _____

Distance *38'* *75'* _____

Do you believe this to be a genuine Land Office Corner? *No*

If not, why? *B.T. not in accord with orig notes.*

R. H. ...

(Signature)

D. F. ...

(Title)

3-7-57

(Date)

Corner again.
 Log on *Gate St. Dispensary*
 & *coal shed* find post on top
 but here. *post* is *gone*.
 I tried to cut to west thru
 dense *cedar* & *balcony* stand.
BT

Metal Location Poster is on a *aspen*
 tree *6* inches diameter, on the *west*
 side of
 from which this Corner bears *unknown*
 chains distant.

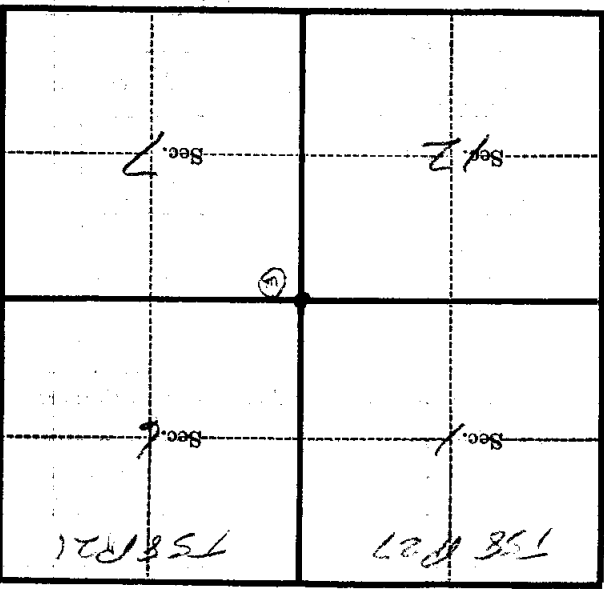

(Make sketch of topography near Corner)