

U. S. Department of Agriculture
FOREST SERVICE

A-21-22

NATIONAL FOREST

CORNERS OF THE PUBLIC SURVEY

T. 58-59 R. 25 Mer.

W. C Corner common to Sections
1, 36, and

Corner consists of a I. P. Aluminum Corner in place
State condition good

Dimensions above ground 24 inches

Sketch grooves, letters, figures, or notches, on proper face or edge.

CARDINAL POSITION

DIAGONAL POSITION

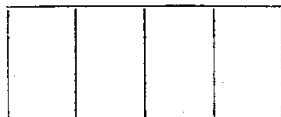

N W S E



NW SW SE NE

Mound of _____ is located _____

Pits are located _____

Sketch markings of Bearing Trees (or Rocks) in proper box and fill blanks below, giving bearings from Corner to Trees and Distances in Links.

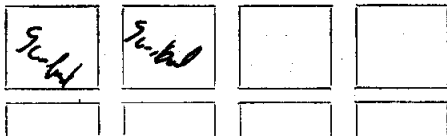

Species Balsam Balsam _____

Diameter 6" 4" _____

Bearing S 20 W N 45 W _____

Distance 19' 13' _____

Do you believe this to be a genuine Land Office Corner? _____

If not, why? No

Set in 1957 by County

R. W. Christopher

(Signature)

12-14-54

(Date)

D. F. R.

(Title)

~~Corner is on a~~

40' north of Transit line

Corner again.

Give any further facts which will aid in finding this

chains distant.

from which this Corner bears

side of

tree inches diameter, on the

Metal Location Poster is on a *BTS*

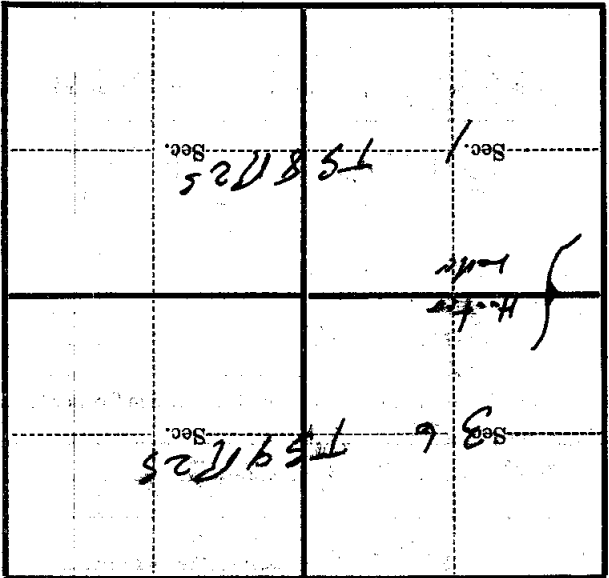

(Make sketch of topography near Corner)