

U. S. Department of Agriculture
FOREST SERVICE

5-5

Chippewa NATIONAL FOREST

CORNERS OF THE PUBLIC SURVEY

T. 58N R. 29+25W 4th Mer.

Section 9 Corner common to Sections

7, 18, 12, and 13
4" scribed Post

Corner consists of a 1" x 6" Iron Pipe (not) in place

State condition Good

Dimensions above ground 36 inches

Sketch grooves, letters, figures, or notches, on proper face or edge.

CARDINAL POSITION

DIAGONAL POSITION

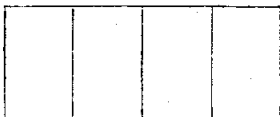

N W S E

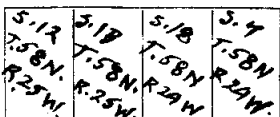

NW SW SE NE

Mound of _____ is located _____

Pits are located _____

Sketch markings of Bearing Trees (or Rocks) in proper box and fill blanks below, giving bearings from Corner to Trees and Distances in Links.

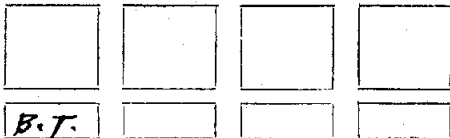

Species Pine Stump

Diameter _____

Bearing N 67° E

Distance 291ks

Do you believe this to be a genuine Land Office Corner? NO.

If not, why? B.T. does not correspond with original notes.

Arthur J. Johnson

(Signature)

Lead Foreman

(Title)

2/26/90
(Date)

(Make sketch of topography near Corner)

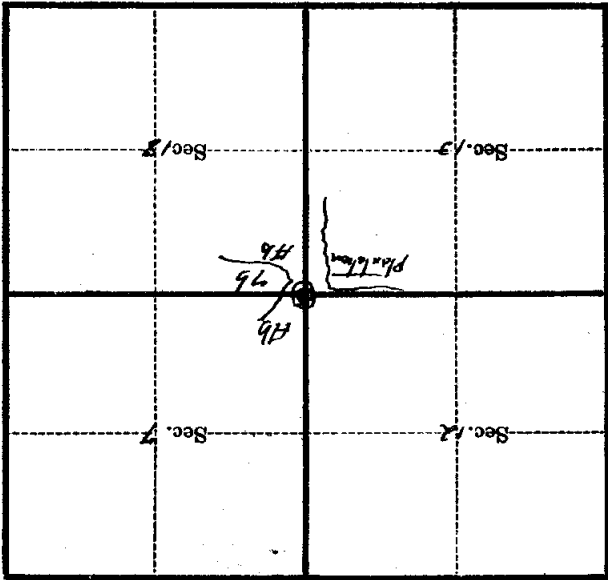

Metal Location Poster is on a Birch

tree 3 inches diameter, on the

side of

from which this Corner bears 5505

.17 chains distant.

Give any further facts which will aid in finding this

Corner again.

U. S. Department of Agriculture
FOREST SERVICE

5-25

~~Galipueva~~ NATIONAL FOREST

CORNERS OF THE PUBLIC SURVEY

T. ~~56 N~~ R. ~~24-25 W~~ 4th Mer.

Corner common to Sections

~~7~~, ~~18~~, ~~12~~, and ~~15~~

Corner consists of a ~~iron pipe & post~~ (not) in place

State condition ~~pipe good - post new~~

Dimensions above ground ~~pipe 4x4x34~~ inches

Sketch grooves, letters, figures, or notches, on proper face or edge.

CARDINAL POSITION

DIAGONAL POSITION

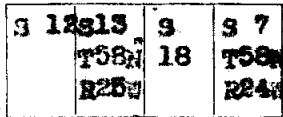

N W S E

NW SW SE NE

Mound of _____ is located _____

Pits are located _____

Sketch markings of Bearing Trees (or Rocks) in proper box and fill blanks below, giving bearings from Corner to Trees and Distances in Links.



Species ~~P. pine - sp~~

Diameter ~~14~~

Bearing ~~N. 61° E~~

Distance ~~0.34~~

Do you believe this to be a genuine Land Office Corner? ~~yes~~

~~If not, why? established by county about 1915~~

~~Seth W. Peterson~~
(Signature)

~~5/11/38~~
(Date)

~~J. A. Smith~~
(Title)

(Make sketch of topography near Corner)

T. 58 N. R. 24-25 W. 4th Mer.

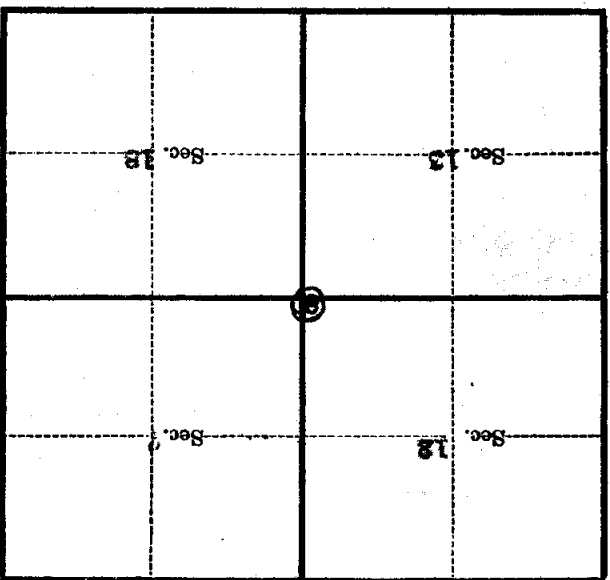

Metal Location Poster is on a Birch tree 5 inches diameter, on the Northwest side of swamp from which this Corner bears 0.17 chains distant.

Give any further facts which will aid in finding this

Corner again.

U. S. Department of Agriculture
FOREST SERVICE

5-25

Chippewa NATIONAL FOREST

CORNERS OF THE PUBLIC SURVEY

T. 58N R. 29+25W 9th Mer.

Section Corner common to Sections

7, 18, 12, and 13

Corner consists of a 1" 16" Iron Pipe (not) in place

State condition Good

Dimensions above ground 36 inches

Sketch grooves, letters, figures, or notches, on proper face or edge.

CARDINAL POSITION

DIAGONAL POSITION

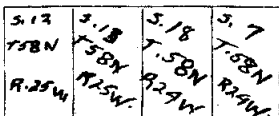

N W S E

NW SW SE NE

Mound of is located

Pits are located

Sketch markings of Bearing Trees (or Rocks) in proper box and fill blanks below, giving bearings from Corner to Trees and Distances in Links.

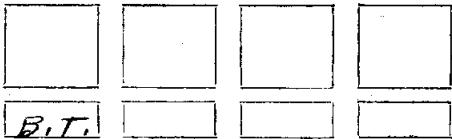

Species *Picea Stump*

Diameter

Bearing *N. 67° E*

Distance *391k.*

Do you believe this to be a genuine Land Office Corner? *NO*

If not, why? *B.T. does not match with original notes.*

Arthur J. Johnson

(Signature)

Special Foreman

(Title)

2/26/40
(Date)

(Make sketch of topography near Corner)

T. 58 N R. 29 E S. W. 9th Mer.

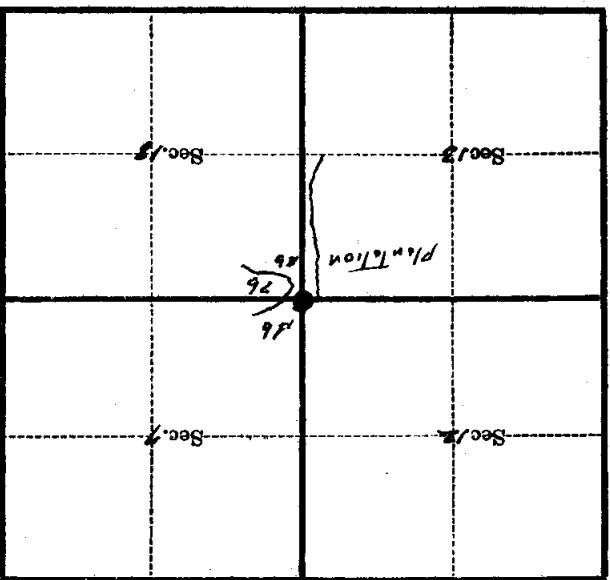

Metal Location Poster is on a *Birch*

tree *3* inches diameter, on the

side of

from which this Corner bears *55° E*

~~N. 77. 17~~ chains distant.

Give any further facts which will aid in finding this

Corner again.

U. S. Department of Agriculture

FOREST SERVICE

Chippewa NATIONAL FOREST J 25

CORNERS OF THE PUBLIC SURVEY

T. 58 N R. 24-25 W 4th Mer.

section Corner common to sections

7, 18, 12, and 13

Corner consists of a ^{Tam} Iron pipe & post (not) in place

State condition Pipe good-- post new

Dimensions above ground pipe 3x8 post 4x4x36 inches

Sketch grooves, letters, figures, or notches, on proper face or edge.

CARDINAL POSITION

DIAGONAL POSITION

--	--	--	--

S 12	S 13	S 18	S 7
	T 58N		T 58N
	R 25W		R 24W

N W S E

NW SW SE NE

Mound of _____ is located _____

Pits are located _____

Sketch markings of Bearing Trees (or Rocks) in proper box and fill blanks below, giving bearings from Corner to Trees and Distances in Links.

BT			

Species R. Pine. Stp.

Diameter 14

Bearing N 61° E

Distance 0.34

Do you believe this to be a genuine Land Office Corner? Yes

If not, why? Reestablished by county about

1915

Seth W. Peterson

(Signature)

5/11/38

(Date)

Jr. Asst. to Tech.

(Title)

(Make sketch of topography near Corner)

T. 58 N. R. 24-25 W. 4th Mer.

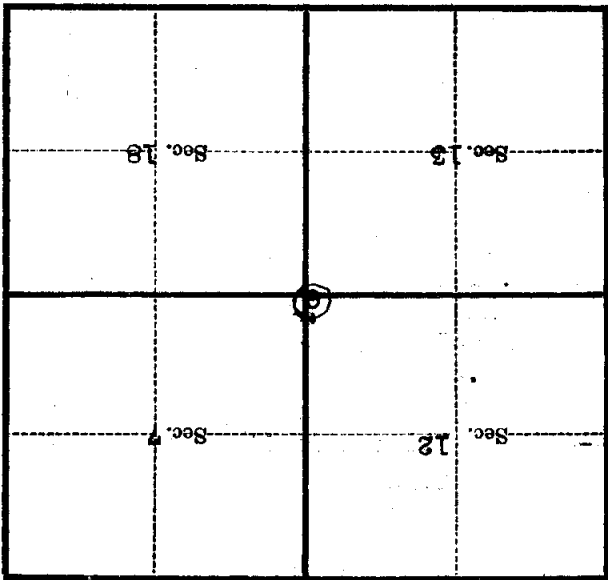

Metal Location Poster is on a Birch

tree 3 inches diameter, on the Northwest

side of SWAMP

from which this Corner bears

S 50 E

0.17 chains distant.

Give any further facts which will aid in finding this

Corner again.