

Form 8749—Revised May, 1918
 U. S. Department of Agriculture
 FOREST SERVICE

Chippewa NATIONAL FOREST N 25

CORNERS OF THE PUBLIC SURVEY

T. 58N R. 24+25W 9th Mer.
Section Corner common to Sections
13, 29, 18, and 19

Corner consists of a 2" Aspen Post (not) in place
 State condition Good

Dimensions above ground 30 inches

Sketch grooves, letters, figures, or notches, on proper face or edge.

CARDINAL POSITION

DIAGONAL POSITION

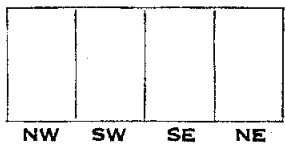
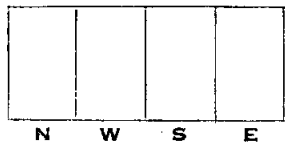

Mound of _____ is located _____

Pits are located _____

Sketch markings of Bearing Trees (or Rocks) in proper box and fill blanks below, giving bearings from Corner to Trees and Distances in Links.

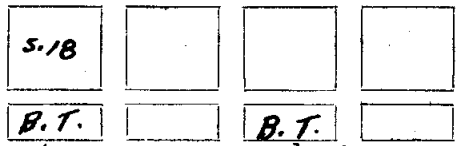

Species Cedar Stump Cedar Stump

Diameter _____

Bearing N 69° E S 55° E

Distance 50 lks 37 lks

Do you believe this to be a genuine Land Office Corner? NO

If not, why? B.T.'s do not check with G.H.O. notes.

Arthur J. Johnson
 (Signature)
Forest Ranger
 (Title)

2/16/40
 (Date)

Metal Location Poster is on a tree inches diameter, on the side of from which this Corner bears chains distant. Give any further facts which will aid in finding this Corner again.

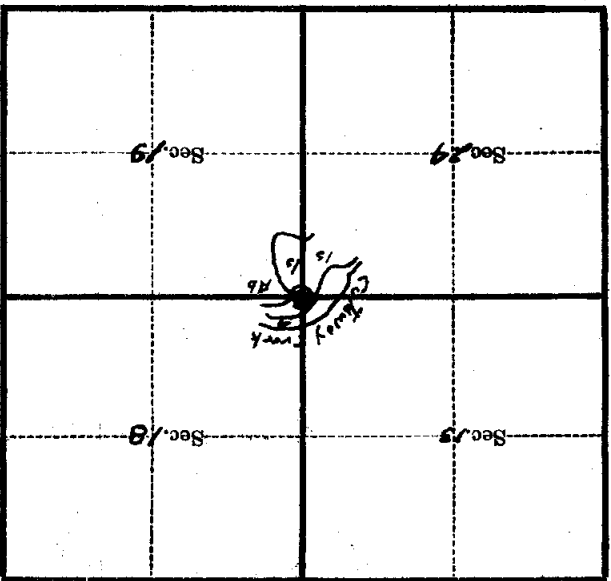

(Make sketch of topography near Corner)

T. 58N R. 29E 25W 97E Mer.

U. S. Department of Agriculture
FOREST SERVICE

N-25

Chippewa NATIONAL FOREST

CORNERS OF THE PUBLIC SURVEY

T. 58N R29+25W 4th Mer.

Section Corner common to Sections
13, 29, 18, and 19

Corner consists of a 2" Aspen Post (~~rod~~) in place
State condition Good

Dimensions above ground 30 inches

Sketch grooves, letters, figures, or notches, on proper face or edge.

CARDINAL POSITION

DIAGONAL POSITION

--	--	--	--

N W S E

--	--	--	--

NW SW SE NE

Mound of _____ is located _____

Pits are located _____

Sketch markings of Bearing Trees (or Rocks) in proper box and fill blanks below, giving bearings from Corner to Trees and Distances in Links.

5.18			
------	--	--	--

B.T.		B.T.	
------	--	------	--

Species Cedar Stump Cedar Stump

Diameter _____

Bearing N69°E S55°E

Distance 50 lks 27 lks

Do you believe this to be a genuine Land Office Corner? No

If not, why? B.T.'s do not check with

G. L. O. notes

Arthur J. Johnson

(Signature)

Special Forester

(Title)

2/16/40

(Date)

Metal Location Poster is on a tree inches diameter, on the side of from which this Corner bears chains distant.

Give any further facts which will aid in finding this Corner again.

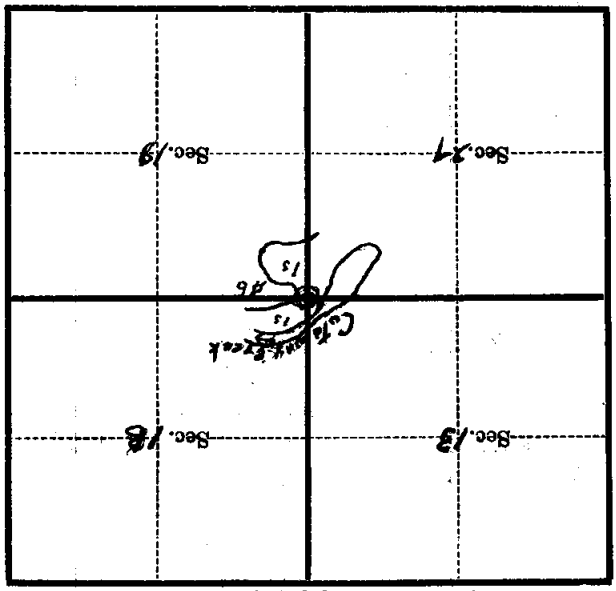

(Make sketch of topography near Corner)

T. 58N R. 27W 9th Mer.

Form 8752 - Revised May, 1918
U. S. Department of Agriculture
FOREST SERVICE

N-25

Chippewa NATIONAL FOREST

CORNERS OF THE PUBLIC SURVEY

T. 50 N R. 29 & 30 W 9th Mer.

Section Corner common to Sections
13, 29, 18, and 19

Corner consists of a 2" Aspen Post (not) in place
State condition Good

Dimensions above ground 30 inches

Sketch grooves, letters, figures, or notches, on proper face or edge.

CARDINAL POSITION

DIAGONAL POSITION



N W S E

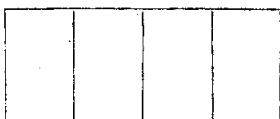

NW SW SE NE

Mound of _____ is located _____

Pits are located _____

Sketch markings of Bearing Trees (or Rocks) in proper box and fill blanks below, giving bearings from Corner to Trees and Distances in Links.

S. 18

B.T.

B.T.

Species Cedar Stamp _____

Diameter _____

Bearing N 62° E 55° E

Distance 50 lks 37 lks

Do you believe this to be a genuine Land Office Corner? NO
If not, why? B.T.'s do not check with G.H.O. notes.

Arthur J. Johnson

(Signature)

Squad Foreman

(Title)

2/16/40
(Date)

Metal Location Poster is on a tree _____ inches diameter, on the side of _____ from which this Corner bears _____ chains distant.

Give any further facts which will aid in finding this Corner again.

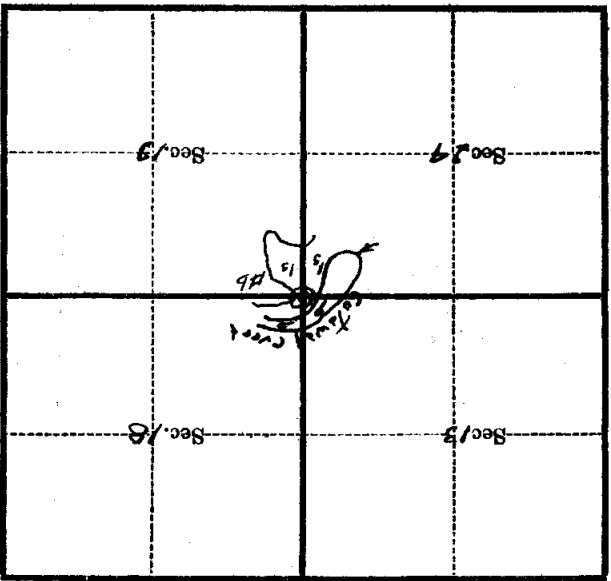

(Make sketch of topography near Corner)

T. 58N R. 24E S. 15W 4th Mer.

U. S. Department of Agriculture
FOREST SERVICE

N-25

Chippewa NATIONAL FOREST

CORNERS OF THE PUBLIC SURVEY

T. 58 N R. 24-25 W 4th Mer.

Section Corner common to sections

18, 19, 20, and 21

Corner consists of Iron stake & Post (not) a place

State condition good - submerged

Dimensions above ground ? inches

Sketch grooves, letters, figures, or notches, on proper face or edge.

CARDINAL POSITION

DIAGONAL POSITION



N W S E



NW SW SE NE

Mound of _____ is located _____

Pits are located _____

Sketch markings of Bearing Trees (or Rocks) in proper box and fill blanks below, giving bearings from Corner to Trees and Distances in Links.

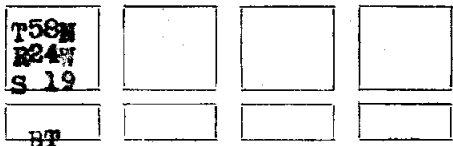

Species Cedar

Diameter 10

Bearing _____

Distance _____

Do you believe this to be a genuine Land Office Corner? **yes**

If not, why? **Resurveyed by county about 1915. present water level 3 feet higher.**

Seth W. Peterson

5/11/30

Jr. Asst. to Tech.

Corner again.
 Ridge of land on S side of creek projects west into swamp. Corner is about 50 feet off end of swamp ridge in S feet of water. No poster was set, and nothing on post couldn't be read because of deep water.
 Give any further facts which will aid in finding this

chains distant.
 from which this Corner bears
 side of
 tree inches diameter, on the
 Metal Location Poster is on a

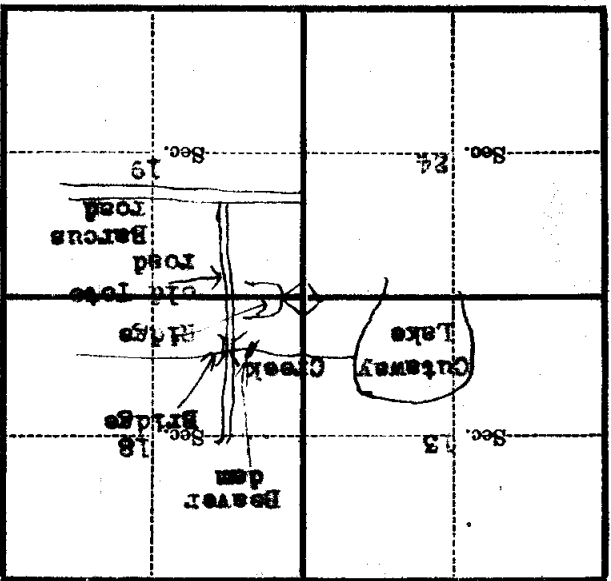

(Make sketch of topography near Corner)