

U. S. Department of Agriculture

FOREST SERVICE

75A

Chippewa NATIONAL FOREST

CORNERS OF THE PUBLIC SURVEY

T. 58 R. 25 Mer. 4

1/4

Corner common to Sections

\_\_\_\_\_, 17, and 18  
 Corner consists of a 4" ASPEN Post - 1/2" dia (not) in place

State condition good

Dimensions above ground 36 8 inches

Sketch grooves, letters, figures, or notches, on proper face or edge.

CARDINAL POSITION

DIAGONAL POSITION

	S 18		S 17
N	W	S	E

NW	SW	SE	NE

Mound of \_\_\_\_\_ is located \_\_\_\_\_

Pits are located \_\_\_\_\_

Sketch markings of Bearing Trees (or Rocks) in proper box and fill blanks below, giving bearings from Corner to Trees and Distances in Links.

	S 18		S 17
			BT

Species \_\_\_\_\_ Asp. Pixe.

Diameter \_\_\_\_\_ 8"

Bearing \_\_\_\_\_ N. 22° E.

Distance \_\_\_\_\_ 32.1/2

Do you believe this to be a genuine Land Office Corner? Yes

If not, why? \_\_\_\_\_

Ernest Perry

(Signature)

Field Road

(Title)

10/18/34  
(Date)

Corner again.  
1/4 cor. located 2 chs. N. of Ruby  
Lake - 1 ch. E. of Smith's Road

Give any further facts which will aid in finding this  
chains distant.

32.  
from which this Corner bears S 22° N  
side of *Tree*  
tree 8 inches diameter, on the *SN*  
Metal Location Poster is on a *W. Pine*

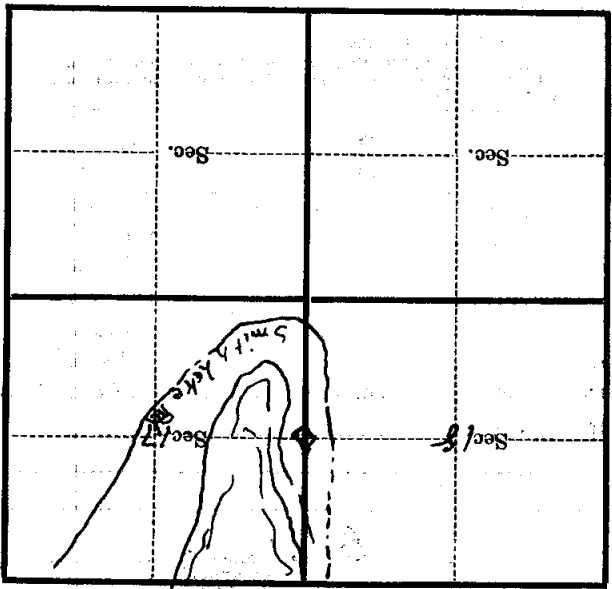

(Make sketch of topography near Corner)

U. S. Department of Agriculture  
FOREST SERVICE

Chippewa NATIONAL FOREST <sup>L5</sup>

CORNERS OF THE PUBLIC SURVEY

T. 58N R. 25W 4<sup>th</sup> Mer.

$\frac{1}{4}$  Corner common to Sections  
17, and 18

Corner consists of a 4" aspen post (not) in place  
State condition good <sup>1" iron pipe</sup>

Dimensions above ground post 36" pipe 8" inches  
Sketch grooves, letters, figures, or notches, on proper face or edge.

CARDINAL POSITION

DIAGONAL POSITION

	S. 18		S. 17
N	W	S	E

NW	SW	SE	NE

Mound of \_\_\_\_\_ is located \_\_\_\_\_

Pits are located \_\_\_\_\_

Sketch markings of Bearing Trees (or Rocks) in proper box and fill blanks below, giving bearings from Corner to Trees and Distances in Links.

	S. 18		S. 17
			B.T.

Species \_\_\_\_\_ W. pine  
Diameter \_\_\_\_\_ 8"  
Bearing \_\_\_\_\_ N. 22° E  
Distance \_\_\_\_\_ 32 links

Do you believe this to be a genuine Land Office Corner? *yes*

If not, why? \_\_\_\_\_

*Ernest Seung*  
(Signature)

10/18/34  
(Date)

*Field Crit*  
(Title)

1/4 COR. IS LOCATED 2 CHAINS  
WEST OF RUBY LAKE AND 1 CHAIN  
EAST OF THE SMITH LAKE TRAIL  
Corner again.

Metal Location Poster is on a **W PINE**  
tree **8** inches diameter, on the **S.W.**  
side of **tree**  
from which this Corner bears **S 22° W**  
**32** links. chains distant.  
Give any further facts which will aid in finding this

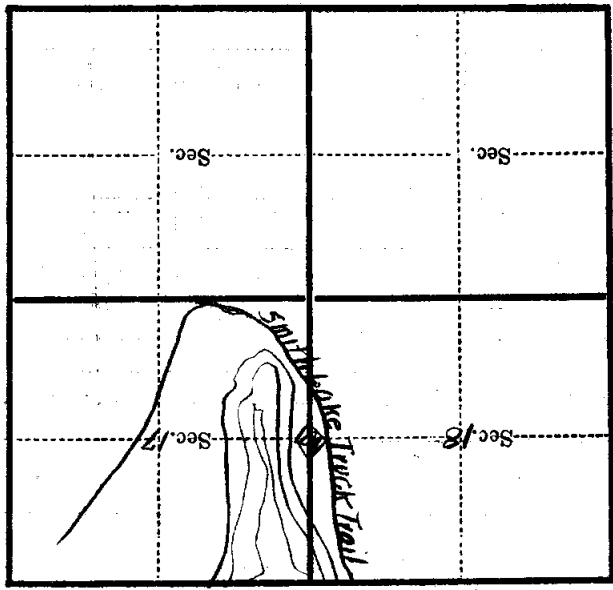

(Make sketch of topography near Corner)

T. 58N R. 25W 4th Mer.

U. S. Department of Agriculture  
FOREST SERVICE

1-5

Chippewa NATIONAL FOREST

CORNERS OF THE PUBLIC SURVEY

T. 58N. R. 25W. 4<sup>th</sup> Mer.

1/4 Corner common to Sections  
17, and 18

Corner consists of a 4" aspen post (not) in place  
iron pipe  
State condition good

Dimensions above ground post 36" pipe 8" inches  
Sketch grooves, letters, figures, or notches, on proper face or edge.

CARDINAL POSITION

DIAGONAL POSITION

	S 18		S 17
N	W	S	E

NW	SW	SE	NE

Mound of \_\_\_\_\_ is located \_\_\_\_\_

Pits are located \_\_\_\_\_

Sketch markings of Bearing Trees (or Rocks) in proper box and fill blanks below, giving bearings from Corner to Trees and Distances in Links.

	S 18		S 17
			B.T.

Species \_\_\_\_\_ W. pine  
Diameter \_\_\_\_\_ 8"  
Bearing \_\_\_\_\_ N. 22° E  
Distance \_\_\_\_\_ 32 links

Do you believe this to be a genuine Land Office Corner? yes

If not, why? \_\_\_\_\_

Ernest Perry  
(Signature)  
Field Asst.  
(Title)

10/18/39  
(Date)

Corner again.  
 Accor. is located E. Champs  
 West of Ruby Lake and  
 Chain East of The Smith  
 Lake Truck Trail.

Metal Location Poster is on a *W. Pine*  
 tree *8* inches diameter, on the *S.W.*  
 side of *tree*  
 from which this Corner bears *S.R.W.*  
~~32.1 mts. chains distant.~~  
 Give any further facts which will aid in finding this

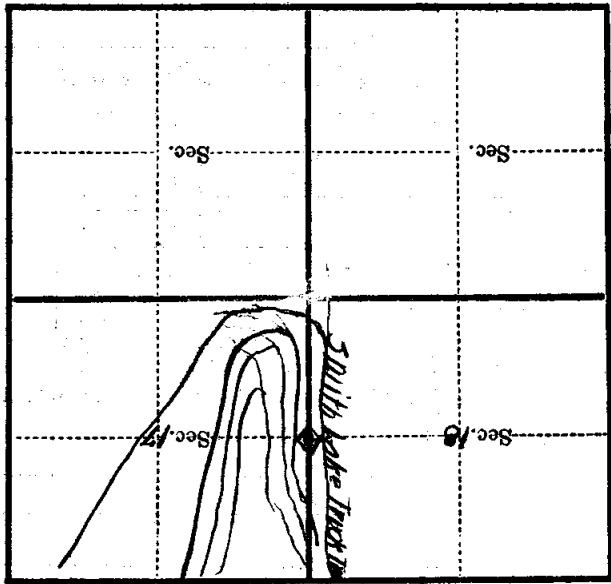

(Make sketch of topography near Corner)

T. 58N R. 25W 9<sup>th</sup> Mer.