

U. S. Department of Agriculture
FOREST SERVICE

J-21

Chippewa NATIONAL FOREST
CORNERS OF THE PUBLIC SURVEY

T. 57 N R26 W 4th Mer.
Sec. Corner common to Sections

11, 12, 13, and 14

Corner consists of a 4" ASPEN (not) in place
State condition 1/2" IRON PIPE - good

Dimensions above ground 2' 6" inches

Sketch grooves, letters, figures, or notches, on proper face or edge.

CARDINAL POSITION

DIAGONAL POSITION

N	W	S	E

S	S	S	S
11	14	13	12
NW	SW	SE	NE

Mound of _____ is located _____

Pits are located _____

Sketch markings of Bearing Trees (or Rocks) in proper box and fill blanks below, giving bearings from Corner to Trees and Distances in Links.

S 11	S 14	S 13	S 12
B.T	B.T	B.T	B.T

Species W. Birch W. Birch Iron Wood Maple
Diameter 5" 6" 8" 7"
Bearing N47°W N39°E S73°E N6°E
Distance 40 Li 31 Li 30-Li 44-Li

Do you believe this to be a genuine Land Office Corner? No

If not, why? _____

Erwin Meagher

(Signature)

12-4-34
(Date)

Field Ass't
(Title)

F-21

LAND ROLLING MIXED
HARD WOODS
of highway # 38
COR. IS 15.00 CHS. E

Corner again.

Give any further facts which will aid in finding this

44-41 chains distant.

from which this Corner bears S 67° W

side of tree

tree 7 inches diameter, on the S. W

Metal Location Poster is on a Maple

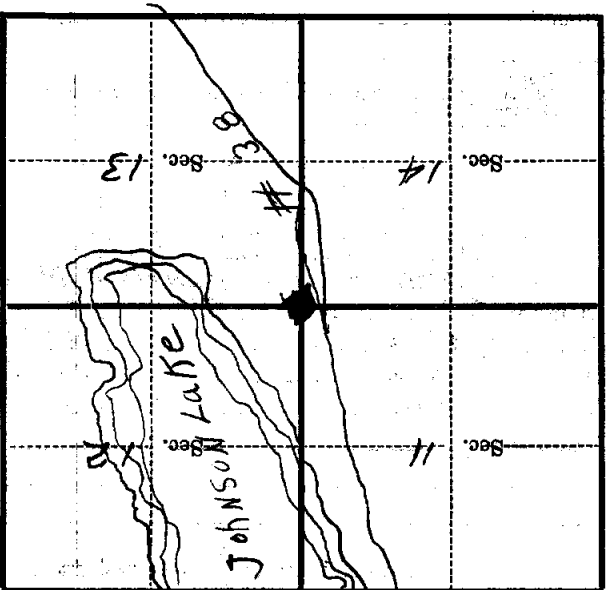

(Make sketch of topography near Corner)

T. 57 N R. 26 W 4th Mer.

U. S. Department of Agriculture
FOREST SERVICE

Handwritten initials

Chippewa NATIONAL FOREST 521
CORNERS OF THE PUBLIC SURVEY

T. 57N R. 26W 4th Mer.
Sec. Corner common to Sections
11, 12, 13, and 14

Corner consists of a 4" ASPEN (not) in place
State condition 1 1/2" IRON PIPE good
Dimensions above ground 2' 6" inches

Sketch grooves, letters, figures, or notches, on proper face or edge.
CARDINAL POSITION DIAGONAL POSITION

N	W	S	E

S	S	S	S
11	14	13	12
NW	SW	SE	NE

Mound of _____ is located _____

Pits are located _____

Sketch markings of Bearing Trees (or Rocks) in proper box and fill blanks below, giving bearings from Corner to Trees and Distances in Links.

S 11	S 14	S 13	S 12
B.T	B.T	B.T	B.T

Species W. birch W. birch Iron Wood Maple
Diameter 5" 6" 8" 7"
Bearing N47°W N39°E S73°E N6°E
Distance 40-Li 31-Li 30-Li 44-Li

Do you believe this to be a genuine Land Office Corner? *yes*
If not, why? _____

Emin Meagher

(Signature)

12-4-34
(Date)

Field Ass't
(Title)

corner again.
 cor is 15.00 chs E. of
 highway # 38
 Land Rollings Mixed
 Hard Woods

Give any further facts which will aid in finding this

44-41 chains distant.

from which this corner bears S. 6° W

side of tree

tree 7 inches diameter, on the S. E. W

Metal Location Poster is on a M.A.P. 10

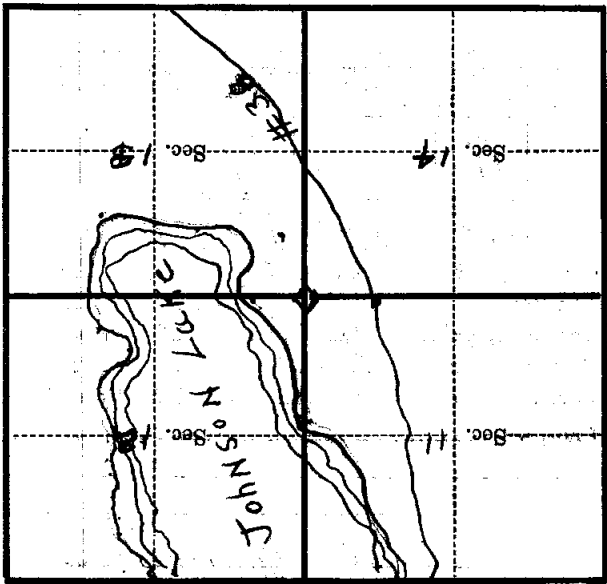

(Make sketch of topography near corner)

T. 57 N. R. 6 W. 7th Mer.

U. S. Department of Agriculture
 FOREST SERVICE

12-3

Chippewa NATIONAL FOREST

CORNERS OF THE PUBLIC SURVEY

T. 57 N R. 26 W 4th Mer.

Sec. Corner common to Sections

11, 12, 13, and 14

Corner consists of a 4" ASPEN (not) in place

State condition 1 1/2" IRON PIPE good

Dimensions above ground 2' 6" inches

Sketch grooves, letters, figures, or notches, on proper face or edge.

CARDINAL POSITION

DIAGONAL POSITION

--	--	--	--

N W S E

S	S	S	S
11	14	13	12

NW SW SE NE

Mound of _____ is located _____

Pits are located _____

Sketch markings of Bearing Trees (or Rocks) in proper box and fill blanks below, giving bearings from Corner to Trees and Distances in Links.

S 11	S 14	S 13	S 12
B.T.	B.T.	B.T.	B.T.

Species W. Birch W. birch IRONWOOD Maple

Diameter 5" 6" 8" 7"

Bearing N 47° W N 79° E S 73° E N 6° E

Distance 40-Li 31-Li 30-Li 44-Li

Do you believe this to be a genuine Land Office Corner? Yes

If not, why? _____

Emin Meagher

(Signature)

12-4-34

(Date)

Field Ass't

(Title)

J-21

LAND ROLLING MIXED HARD WOODS
COR. IS 15.00 CHS E
OF HIGHWAY #38

Corner again.

Give any further facts which will aid in finding this

49-LI chains distant.

from which this Corner bears S 60 W

side of tree

tree 7 inches diameter, on the S. W.

Metal Location Poster is on a Maple

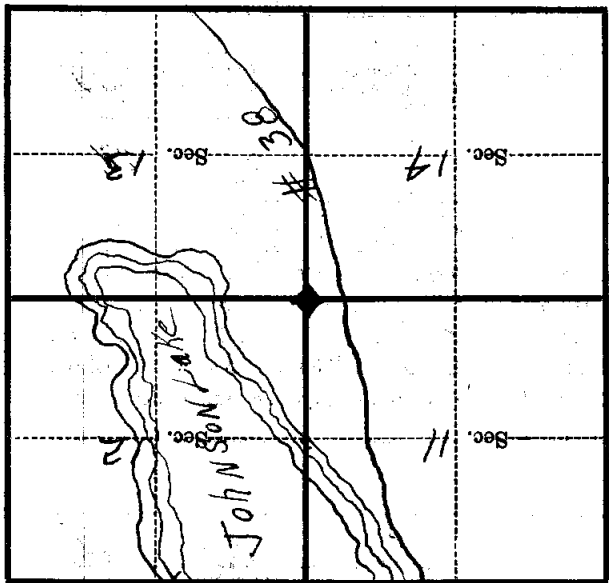

(Make sketch of topography near Corner)

T. 57 N R. 26 W 4th Mer.