

U. S. Department of Agriculture

FOREST SERVICE

N-17

chippewa NATIONAL FOREST

CORNERS OF THE PUBLIC SURVEY

T. 57 N R. 26 W 4th Mer.

Section Corner common to Sections 14, 15, 22, and 23

Corner consists of a 4" Asper post (not) in place State condition Good 3" Iron pipe

Dimensions above ground 30" post 6" pipe inches Sketch grooves, letters, figures, or notches, on proper face or edge.

CARDINAL POSITION

DIAGONAL POSITION

--	--	--	--

S	S	S	S
15	22	23	14

N W S E

NW SW SE NE

Mound of _____ is located _____

Pits are located _____

Sketch markings of Bearing Trees (or Rocks) in proper box and fill blanks below, giving bearings from Corner to Trees and Distances in Links.

	S 22	S 23	S 14
	BT	BT	BT

Species Maple Maple Maple

Diameter 7" 5" 11"

Bearing N28°E S79°E S73°W

Distance 381Ks. 571Ks. 191Ks.

Do you believe this to be a genuine Land Office Corner? Yes

If not, why? _____

King (Signature)

7-11-35 (Date)

(Title)

N-17

CORNER TOLLING
HARDWOOD

Corner again.

Give any further facts which will aid in finding this

191K5 chains distant.

from which this Corner bears N73°E 2

side of tree

tree 11 inches diameter, on the NE

Metal Location Poster is on a Maple

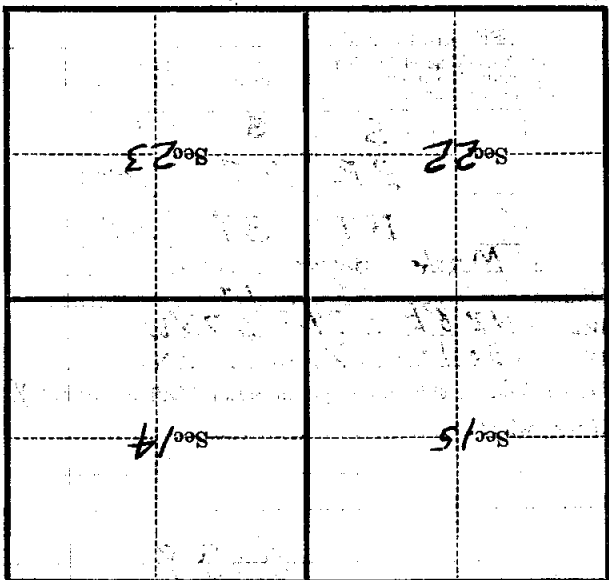

(Make sketch of topography near Corner)

T. 59 N R. 26 W 4th Mer.

U. S. Department of Agriculture
FOREST SERVICE

N-19

Chippewa NATIONAL FOREST

CORNERS OF THE PUBLIC SURVEY

T. 57 N R. 26 W 4 Mer.

Section Corner common to Sections
14, 16, 22, and 23

Corner consists of a iron pipe - guard s/d (not) in place
State condition good

Dimensions above ground 6 30 inches
Sketch grooves, letters, figures, or notches, on proper face or edge.

CARDINAL POSITION

DIAGONAL POSITION

N	W	S	E

S 15	S 22	S 23	S 14
NW	SW	SE	NE

Mound of _____ is located _____

Pits are located _____

Sketch markings of Bearing Trees (or Rocks) in proper box and fill blanks below, giving bearings from Corner to Trees and Distances in Links.

	S 22	S 23	S 14
	BT	BT	BT

Species Maple OAK OAK
Diameter 11" 9" 12"
Bearing S 74° W S 79° E N 27° E
Distance 19 lks 57 lks 38 lks

Do you believe this to be a genuine Land Office Corner? Yes
If not, why? _____

Edgar J. Parker
(Signature)

Rich Foreman
(Title)

9/20/34
(Date)

N-17

Trail starting from road West of Sherwood Lodge passes North 200' West of corner
Corner again.

Give any further facts which will aid in finding this

chains distant.

from which this Corner bears N 50° E
side of tree 11 inches diameter, on the
Metal Location Poster is on a Maple

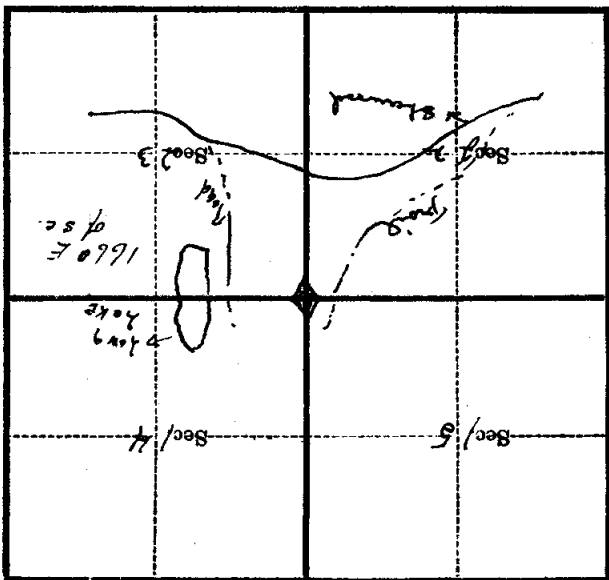

(Make sketch of topography near Corner)

T. 57 R. 26 Mer.

U. S. Department of Agriculture
FOREST SERVICE

N-17

Chippewa

NATIONAL FOREST

CORNERS OF THE PUBLIC SURVEY

T. 57N R. 26W 4th Mer.

Section Corner common to Sections
14, 15, 22, and 23

Corner consists of a ~~iron pipe~~ ^{wooden post} ~~(not)~~ in place
State condition ~~good~~

Dimensions above ground ^{pipe 6" stake 20} inches
Sketch grooves, letters, figures, or notches, on proper face or edge.

CARDINAL POSITION

DIAGONAL POSITION

N	W	S	E

S 15	S 22	S 23	S 14
NW	SW	SE	NE

Mound of _____ is located _____

Pits are located _____

Sketch markings of Bearing Trees (or Rocks) in proper box and fill blanks below, giving bearings from Corner to Trees and Distances in Links.

	S 22	S 23	S 14
	BT	BT	BT

Species _____ Maple Oak Oak
 Diameter _____ 12" 12"
 Bearing _____ S74°W S79°E N27°E
 Distance _____ 12' 33' 21'

Do you believe this to be a genuine Land Office Corner? **Yes**

If not, why? _____

BT's not 6.10 link
9/30/37

Edgar J. Parker
 (Signature)
 Sept 29, 1934 (Date) Foreman (Title)

N 17

Trail starting from the
Road West of Sherwood
Lodge passes North 200
West of corner
Corner again.

Give any further facts which will aid in finding this

16 feet chains distant.

from which this Corner bears N 59° E

side of Tree

tree 11 inches diameter, on the South

Metal Location Poster is on a Maple

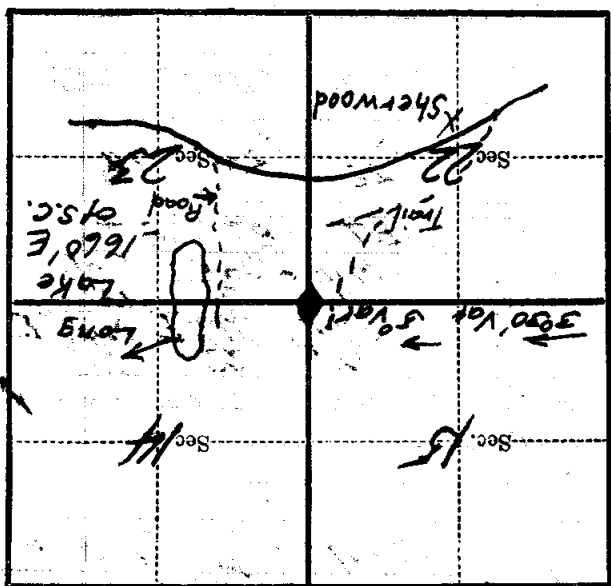

(Make sketch of topography near Corner)

T. 57N R. 26W 4th Mer.