

U. S. Department of Agriculture

FOREST SERVICE

N~~o~~ 4

CHIPPENAW NATIONAL FOREST

CORNERS OF THE PUBLIC SURVEY

T. 57 N R. 25 W 4th Mer.

E 1/16 Corner common to Sections

18 and 19
Corner consists of a 3" Scribed Post (not in place)
1" x 3" iron pipe

State condition oppd

Dimensions above ground 36 inches

Sketch grooves, letters, figures, or notches, on proper face or edge.

CARDINAL POSITION

DIAGONAL POSITION

N	W	S	E
21/16	21/16	21/16	21/16
S. 18	S. 18	S. 19	S. 19

NW	SW	SE	NE

Mound of _____ is located _____

Pits are located _____

Sketch markings of Bearing Trees (or Rocks) in proper box and fill blanks below, giving bearings from Corner to Trees and Distances in Links.

S. 18	Grown Over		
S. 7.			

Species ~~Aspen~~ Aspen

Diameter 8" 8"

Bearing N14°W 56°W

Distance 58 Lks 51 Lks

Do you believe this to be a genuine Land Office Corner? No

If not, why? records show it was set by County Surveyor

Arthur J. Johnson
(Signature)

2/1/40
(Date)

Squad Foreman
(Title)

~~This corner lies 4.9 chains East of
Road to Joyce Kates.~~

Corner again.

Give any further facts which will aid in finding this
chains distant.
from which this Corner bears
side of
tree inches diameter, on the
Metal Location Poster is on a

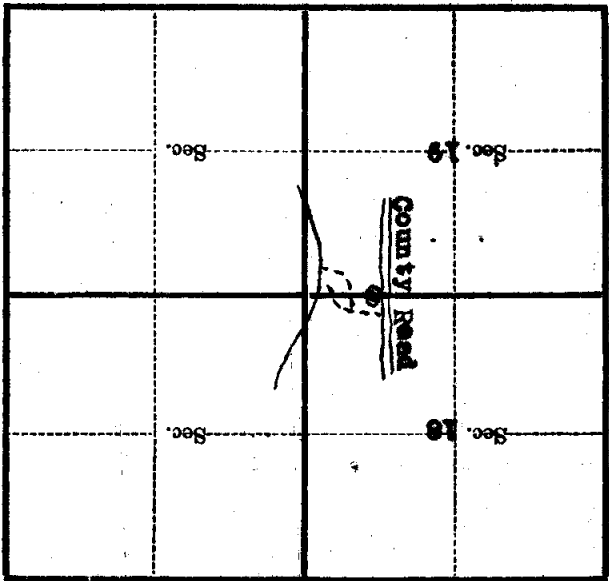

(Make sketch of topography near Corner)

U. S. Department of Agriculture
FOREST SERVICE

N-4

~~CHIPPEWA~~ NATIONAL FOREST
CORNERS OF THE PUBLIC SURVEY

T. 57 N R. 25 W 4 1/2 Mer.
E 1/16 Corner common to Sections

18 and 19
Corner consists of a 3" scribed post
1 x 3" iron pipe in place

State condition good

Dimensions above ground 36 inches

Sketch grooves, letters, figures, or notches, on proper face or edge.

CARDINAL POSITION

DIAGONAL POSITION

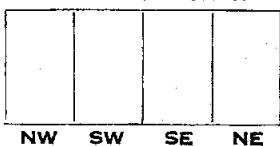
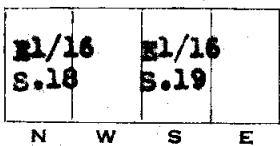

Mound of _____ is located _____

Pits are located _____

Sketch markings of Bearing Trees (or Rocks) in proper box and fill blanks below, giving bearings from Corner to Trees and Distances in Links.

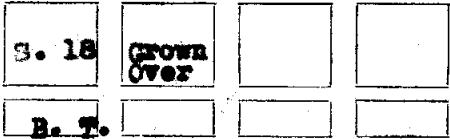

Species aspen aspen
Diameter 8" 8"
Bearing N14°W S69°W
Distance 56 lks 51 lks

Do you believe this to be a genuine Land Office Corner? NO

If not, why? Records show it was set by county surveyor

Arthur J. Johnson
(Signature)

2/1/40
(Date)

Squad Foreman
(Title)

N-4

This corner lies 4.8 chains West of
Road to Joyce Estate.

Corner again.

Give any further facts which will aid in finding this

chains distant.

from which this Corner bears

side of

tree inches diameter, on the

Metal Location Poster is on a

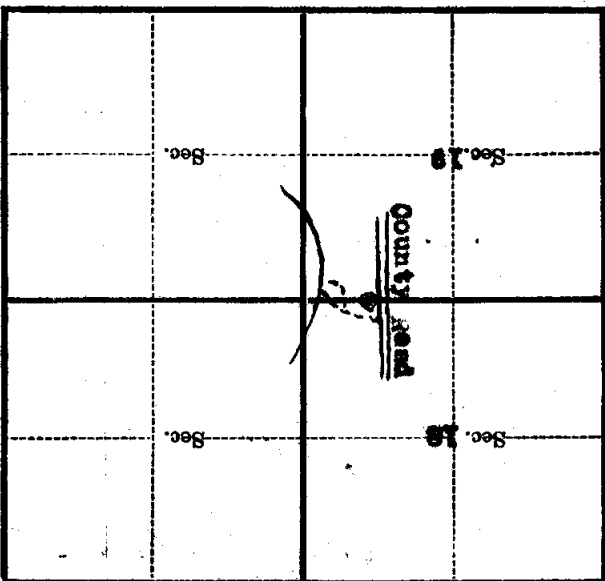

(Make sketch of topography near Corner)

T. 57 N. R. 25 W. Mer.

U. S. Department of Agriculture
FOREST SERVICE

2
1
1

CHIEPELIA NATIONAL FOREST

CORNERS OF THE PUBLIC SURVEY

T. 57 N R. 25 W 4 th Mer.

E 1/16 Corner common to Sections

18 and 19

3rd Scribed Post

Corner consists of a 1" x 3" Iron pipe (not) in place

State condition Gppd

Dimensions above ground 36 inches

Sketch grooves, letters, figures, or notches, on proper face or edge.

CARDINAL POSITION

DIAGONAL POSITION

E 1/16	E 1/16		
S. 18	S. 19		
N	W	S	E

NW	SW	SE	NE

Mound of _____ is located _____

Pits are located _____

Sketch markings of Bearing Trees (or Rocks) in proper box and fill blanks below, giving bearings from Corner to Trees and Distances in Links.

S. 18	Grown Over		
B. T.			

Species ~~Aspen~~ Aspen

Diameter 8" 8"

Bearing N 14° W S 69° W

Distance 58 lks 51 lks

Do you believe this to be a genuine Land Office Corner? NO
If not, why? Records show it was set by County Surveyor

Arthur J. Johnson
(Signature)

2/1/40
(Date)

Squad Foreman
(Title)

N-1

Corner again.
This corner lies 4.9 chains East of
Road to Joyce Estate.

Metal Location Poster is on a
tree inches diameter, on the
side of
from which this Corner bears
chains distant.
Give any further facts which will aid in finding this

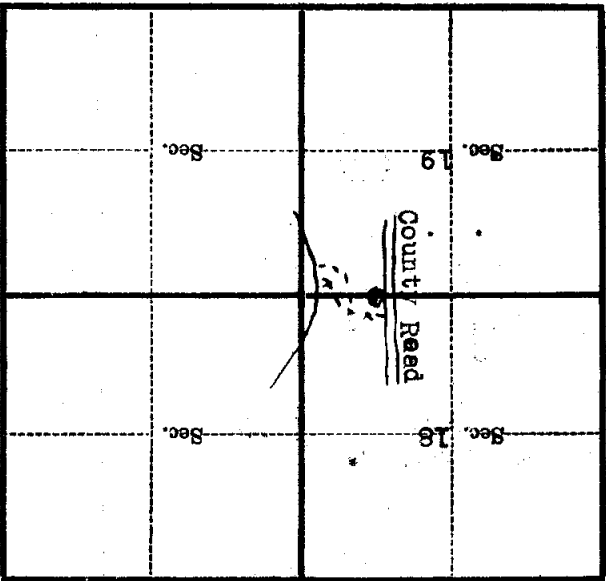

(Make sketch of topography near Corner)

T. 57 N. R. 25 W. 4th Mer.