

U. S. Department of Agriculture
FOREST SERVICE

N
2

CHIPPENAW NATIONAL FOREST

CORNERS OF THE PUBLIC SURVEY

T. **57 N** R. **25 W** **4 1/2** Mer.

1/16 Corner common to Sections

18, and **19**
Corner consists of a **2" x 2" x 1/2" iron pipe** in place

State condition **good**

Dimensions above ground **36** inches

Sketch grooves, letters, figures, or notches, on proper face or edge.

CARDINAL POSITION

DIAGONAL POSITION

N 1/16		W 1/16	
S. 18		S. 19	

N W S E

NW SW SE NE

Mound of _____ is located _____

Pits are located _____

Sketch markings of Bearing Trees (or Rocks) in proper box and fill blanks below, giving bearings from Corner to Trees and Distances in Links.

S. 18	S. 19		
B.T.	B.T.		

Species **ASPEN** **ASPEN**

Diameter **8"** **12"**

Bearing **N 16° W** **S 94° W**

Distance **38 Lks** **38 Lks**

Do you believe this to be a genuine Land Office Corner? **NO**

If not, why? **Records show it was set by County Surveyor.**

Arthur J. Johnson
(Signature)

2/1/40
(Date)

Squad Foreman
(Title)

N-2

Corner again.

Give any further facts which will aid in finding this

chains distant.

from which this Corner bears

side of

tree inches diameter, on the

Metal Location Poster is on a

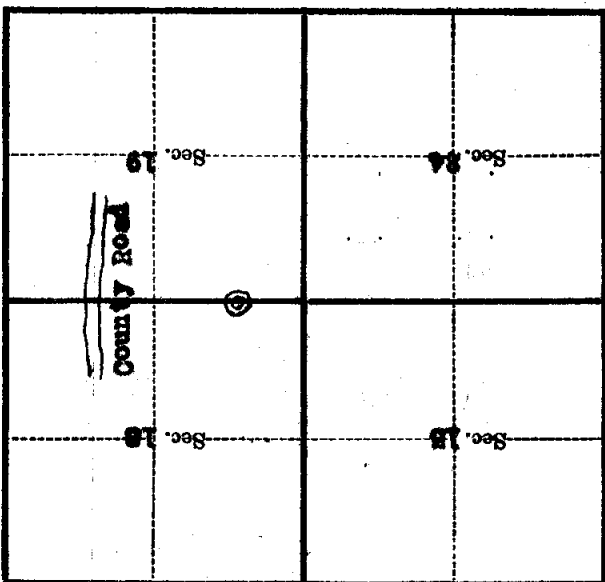

(Make sketch of topography near Corner)

U. S. Department of Agriculture
FOREST SERVICE

N-2

CHIPPENAW NATIONAL FOREST

CORNERS OF THE PUBLIC SURVEY

T. 57 N R. 25 W 4th Mer.

W 1/16 Corner common to sections

18, and 19

Corner consists of a ^{2" scribed Aspen post} ~~3/4" iron pipe~~ in place

State condition Good

Dimensions above ground 36 inches

Sketch grooves, letters, figures, or notches, on proper face or edge.

CARDINAL POSITION

DIAGONAL POSITION

W 1/16	W 1/16		
S. 18	S. 19		
N	W	S	E

NW	SW	SE	NE

Mound of _____ is located _____

Pits are located _____

Sketch markings of Bearing Trees (or Rocks) in proper box and fill blanks below, giving bearings from Corner to Trees and Distances in Links.

S. 18	S. 19		
B.T.	B.T.		

Species ASPER ASPER

Diameter 8" 12"

Bearing N16°W S94°W

Distance 38 Lks 38 Lks

Do you believe this to be a genuine Land Office Corner? NO

If not, why? Records show it was set by County surveyor.

Arthur J. Johnson
(Signature)

2/1/40
(Date)

Squad Foreman
(Title)

N-2

Corner again.

Give any further facts which will aid in finding this

chains distant.

from which this Corner bears

side of

tree inches diameter, on the

Metal Location Poster is on a

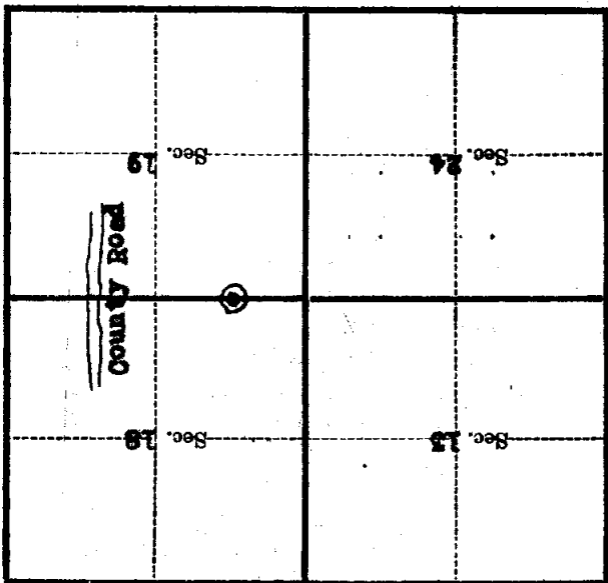

(Make sketch of topography near Corner)