

Loon Lake

SUPERVISORS' ROAD ORDER

Filed this 26 day of Sept
A. D. 1904

W. M. Leonard
Town Clerk

The within Road Order, together with the Award of Damages, was recorded by me the 26 day of Sept 1904 in the Road Record Book of the Town, and then sent by me to the County Auditor, to be filed and preserved by him.

W. M. Leonard
Town Clerk

Office of County Auditor,

County of Minn.

Filed this day of
190 at o'clock M., in this office.

County Auditor.

The Town Clerk must not record this order within thirty days after filing, and not then, if an appeal has been taken, until the order is confirmed on appeal. But if no appeal is taken, or if on appeal this order is confirmed, it, together with the award, must be recorded and then transmitted to the County Auditor, to be filed and preserved by him. *State of Minnesota - General Laws 1888, Chapter 29, as amended. Laws 1890, Chapter 188, Chapter 189, Chapter 190, Chapter 191, Chapter 192, Chapter 193, Chapter 194, Chapter 195, Chapter 196, Chapter 197, Chapter 198, Chapter 199, Chapter 200, Chapter 201, Chapter 202, Chapter 203, Chapter 204, Chapter 205, Chapter 206, Chapter 207, Chapter 208, Chapter 209, Chapter 210, Chapter 211, Chapter 212, Chapter 213, Chapter 214, Chapter 215, Chapter 216, Chapter 217, Chapter 218, Chapter 219, Chapter 220, Chapter 221, Chapter 222, Chapter 223, Chapter 224, Chapter 225, Chapter 226, Chapter 227, Chapter 228, Chapter 229, Chapter 230, Chapter 231, Chapter 232, Chapter 233, Chapter 234, Chapter 235, Chapter 236, Chapter 237, Chapter 238, Chapter 239, Chapter 240, Chapter 241, Chapter 242, Chapter 243, Chapter 244, Chapter 245, Chapter 246, Chapter 247, Chapter 248, Chapter 249, Chapter 250, Chapter 251, Chapter 252, Chapter 253, Chapter 254, Chapter 255, Chapter 256, Chapter 257, Chapter 258, Chapter 259, Chapter 260, Chapter 261, Chapter 262, Chapter 263, Chapter 264, Chapter 265, Chapter 266, Chapter 267, Chapter 268, Chapter 269, Chapter 270, Chapter 271, Chapter 272, Chapter 273, Chapter 274, Chapter 275, Chapter 276, Chapter 277, Chapter 278, Chapter 279, Chapter 280, Chapter 281, Chapter 282, Chapter 283, Chapter 284, Chapter 285, Chapter 286, Chapter 287, Chapter 288, Chapter 289, Chapter 290, Chapter 291, Chapter 292, Chapter 293, Chapter 294, Chapter 295, Chapter 296, Chapter 297, Chapter 298, Chapter 299, Chapter 300, Chapter 301, Chapter 302, Chapter 303, Chapter 304, Chapter 305, Chapter 306, Chapter 307, Chapter 308, Chapter 309, Chapter 310, Chapter 311, Chapter 312, Chapter 313, Chapter 314, Chapter 315, Chapter 316, Chapter 317, Chapter 318, Chapter 319, Chapter 320, Chapter 321, Chapter 322, Chapter 323, Chapter 324, Chapter 325, Chapter 326, Chapter 327, Chapter 328, Chapter 329, Chapter 330, Chapter 331, Chapter 332, Chapter 333, Chapter 334, Chapter 335, Chapter 336, Chapter 337, Chapter 338, Chapter 339, Chapter 340, Chapter 341, Chapter 342, Chapter 343, Chapter 344, Chapter 345, Chapter 346, Chapter 347, Chapter 348, Chapter 349, Chapter 350, Chapter 351, Chapter 352, Chapter 353, Chapter 354, Chapter 355, Chapter 356, Chapter 357, Chapter 358, Chapter 359, Chapter 360, Chapter 361, Chapter 362, Chapter 363, Chapter 364, Chapter 365, Chapter 366, Chapter 367, Chapter 368, Chapter 369, Chapter 370, Chapter 371, Chapter 372, Chapter 373, Chapter 374, Chapter 375, Chapter 376, Chapter 377, Chapter 378, Chapter 379, Chapter 380, Chapter 381, Chapter 382, Chapter 383, Chapter 384, Chapter 385, Chapter 386, Chapter 387, Chapter 388, Chapter 389, Chapter 390, Chapter 391, Chapter 392, Chapter 393, Chapter 394, Chapter 395, Chapter 396, Chapter 397, Chapter 398, Chapter 399, Chapter 400, Chapter 401, Chapter 402, Chapter 403, Chapter 404, Chapter 405, Chapter 406, Chapter 407, Chapter 408, Chapter 409, Chapter 410, Chapter 411, Chapter 412, Chapter 413, Chapter 414, Chapter 415, Chapter 416, Chapter 417, Chapter 418, Chapter 419, Chapter 420, Chapter 421, Chapter 422, Chapter 423, Chapter 424, Chapter 425, Chapter 426, Chapter 427, Chapter 428, Chapter 429, Chapter 430, Chapter 431, Chapter 432, Chapter 433, Chapter 434, Chapter 435, Chapter 436, Chapter 437, Chapter 438, Chapter 439, Chapter 440, Chapter 441, Chapter 442, Chapter 443, Chapter 444, Chapter 445, Chapter 446, Chapter 447, Chapter 448, Chapter 449, Chapter 450, Chapter 451, Chapter 452, Chapter 453, Chapter 454, Chapter 455, Chapter 456, Chapter 457, Chapter 458, Chapter 459, Chapter 460, Chapter 461, Chapter 462, Chapter 463, Chapter 464, Chapter 465, Chapter 466, Chapter 467, Chapter 468, Chapter 469, Chapter 470, Chapter 471, Chapter 472, Chapter 473, Chapter 474, Chapter 475, Chapter 476, Chapter 477, Chapter 478, Chapter 479, Chapter 480, Chapter 481, Chapter 482, Chapter 483, Chapter 484, Chapter 485, Chapter 486, Chapter 487, Chapter 488, Chapter 489, Chapter 490, Chapter 491, Chapter 492, Chapter 493, Chapter 494, Chapter 495, Chapter 496, Chapter 497, Chapter 498, Chapter 499, Chapter 500, Chapter 501, Chapter 502, Chapter 503, Chapter 504, Chapter 505, Chapter 506, Chapter 507, Chapter 508, Chapter 509, Chapter 510, Chapter 511, Chapter 512, Chapter 513, Chapter 514, Chapter 515, Chapter 516, Chapter 517, Chapter 518, Chapter 519, Chapter 520, Chapter 521, Chapter 522, Chapter 523, Chapter 524, Chapter 525, Chapter 526, Chapter 527, Chapter 528, Chapter 529, Chapter 530, Chapter 531, Chapter 532, Chapter 533, Chapter 534, Chapter 535, Chapter 536, Chapter 537, Chapter 538, Chapter 539, Chapter 540, Chapter 541, Chapter 542, Chapter 543, Chapter 544, Chapter 545, Chapter 546, Chapter 547, Chapter 548, Chapter 549, Chapter 550, Chapter 551, Chapter 552, Chapter 553, Chapter 554, Chapter 555, Chapter 556, Chapter 557, Chapter 558, Chapter 559, Chapter 560, Chapter 561, Chapter 562, Chapter 563, Chapter 564, Chapter 565, Chapter 566, Chapter 567, Chapter 568, Chapter 569, Chapter 570, Chapter 571, Chapter 572, Chapter 573, Chapter 574, Chapter 575, Chapter 576, Chapter 577, Chapter 578, Chapter 579, Chapter 580, Chapter 581, Chapter 582, Chapter 583, Chapter 584, Chapter 585, Chapter 586, Chapter 587, Chapter 588, Chapter 589, Chapter 590, Chapter 591, Chapter 592, Chapter 593, Chapter 594, Chapter 595, Chapter 596, Chapter 597, Chapter 598, Chapter 599, Chapter 600, Chapter 601, Chapter 602, Chapter 603, Chapter 604, Chapter 605, Chapter 606, Chapter 607, Chapter 608, Chapter 609, Chapter 610, Chapter 611, Chapter 612, Chapter 613, Chapter 614, Chapter 615, Chapter 616, Chapter 617, Chapter 618, Chapter 619, Chapter 620, Chapter 621, Chapter 622, Chapter 623, Chapter 624, Chapter 625, Chapter 626, Chapter 627, Chapter 628, Chapter 629, Chapter 630, Chapter 631, Chapter 632, Chapter 633, Chapter 634, Chapter 635, Chapter 636, Chapter 637, Chapter 638, Chapter 639, Chapter 640, Chapter 641, Chapter 642, Chapter 643, Chapter 644, Chapter 645, Chapter 646, Chapter 647, Chapter 648, Chapter 649, Chapter 650, Chapter 651, Chapter 652, Chapter 653, Chapter 654, Chapter 655, Chapter 656, Chapter 657, Chapter 658, Chapter 659, Chapter 660, Chapter 661, Chapter 662, Chapter 663, Chapter 664, Chapter 665, Chapter 666, Chapter 667, Chapter 668, Chapter 669, Chapter 670, Chapter 671, Chapter 672, Chapter 673, Chapter 674, Chapter 675, Chapter 676, Chapter 677, Chapter 678, Chapter 679, Chapter 680, Chapter 681, Chapter 682, Chapter 683, Chapter 684, Chapter 685, Chapter 686, Chapter 687, Chapter 688, Chapter 689, Chapter 690, Chapter 691, Chapter 692, Chapter 693, Chapter 694, Chapter 695, Chapter 696, Chapter 697, Chapter 698, Chapter 699, Chapter 700, Chapter 701, Chapter 702, Chapter 703, Chapter 704, Chapter 705, Chapter 706, Chapter 707, Chapter 708, Chapter 709, Chapter 710, Chapter 711, Chapter 712, Chapter 713, Chapter 714, Chapter 715, Chapter 716, Chapter 717, Chapter 718, Chapter 719, Chapter 720, Chapter 721, Chapter 722, Chapter 723, Chapter 724, Chapter 725, Chapter 726, Chapter 727, Chapter 728, Chapter 729, Chapter 730, Chapter 731, Chapter 732, Chapter 733, Chapter 734, Chapter 735, Chapter 736, Chapter 737, Chapter 738, Chapter 739, Chapter 740, Chapter 741, Chapter 742, Chapter 743, Chapter 744, Chapter 745, Chapter 746, Chapter 747, Chapter 748, Chapter 749, Chapter 750, Chapter 751, Chapter 752, Chapter 753, Chapter 754, Chapter 755, Chapter 756, Chapter 757, Chapter 758, Chapter 759, Chapter 760, Chapter 761, Chapter 762, Chapter 763, Chapter 764, Chapter 765, Chapter 766, Chapter 767, Chapter 768, Chapter 769, Chapter 770, Chapter 771, Chapter 772, Chapter 773, Chapter 774, Chapter 775, Chapter 776, Chapter 777, Chapter 778, Chapter 779, Chapter 780, Chapter 781, Chapter 782, Chapter 783, Chapter 784, Chapter 785, Chapter 786, Chapter 787, Chapter 788, Chapter 789, Chapter 790, Chapter 791, Chapter 792, Chapter 793, Chapter 794, Chapter 795, Chapter 796, Chapter 797, Chapter 798, Chapter 799, Chapter 800, Chapter 801, Chapter 802, Chapter 803, Chapter 804, Chapter 805, Chapter 806, Chapter 807, Chapter 808, Chapter 809, Chapter 810, Chapter 811, Chapter 812, Chapter 813, Chapter 814, Chapter 815, Chapter 816, Chapter 817, Chapter 818, Chapter 819, Chapter 820, Chapter 821, Chapter 822, Chapter 823, Chapter 824, Chapter 825, Chapter 826, Chapter 827, Chapter 828, Chapter 829, Chapter 830, Chapter 831, Chapter 832, Chapter 833, Chapter 834, Chapter 835, Chapter 836, Chapter 837, Chapter 838, Chapter 839, Chapter 840, Chapter 841, Chapter 842, Chapter 843, Chapter 844, Chapter 845, Chapter 846, Chapter 847, Chapter 848, Chapter 849, Chapter 850, Chapter 851, Chapter 852, Chapter 853, Chapter 854, Chapter 855, Chapter 856, Chapter 857, Chapter 858, Chapter 859, Chapter 860, Chapter 861, Chapter 862, Chapter 863, Chapter 864, Chapter 865, Chapter 866, Chapter 867, Chapter 868, Chapter 869, Chapter 870, Chapter 871, Chapter 872, Chapter 873, Chapter 874, Chapter 875, Chapter 876, Chapter 877, Chapter 878, Chapter 879, Chapter 880, Chapter 881, Chapter 882, Chapter 883, Chapter 884, Chapter 885, Chapter 886, Chapter 887, Chapter 888, Chapter 889, Chapter 890, Chapter 891, Chapter 892, Chapter 893, Chapter 894, Chapter 895, Chapter 896, Chapter 897, Chapter 898, Chapter 899, Chapter 900, Chapter 901, Chapter 902, Chapter 903, Chapter 904, Chapter 905, Chapter 906, Chapter 907, Chapter 908, Chapter 909, Chapter 910, Chapter 911, Chapter 912, Chapter 913, Chapter 914, Chapter 915, Chapter 916, Chapter 917, Chapter 918, Chapter 919, Chapter 920, Chapter 921, Chapter 922, Chapter 923, Chapter 924, Chapter 925, Chapter 926, Chapter 927, Chapter 928, Chapter 929, Chapter 930, Chapter 931, Chapter 932, Chapter 933, Chapter 934, Chapter 935, Chapter 936, Chapter 937, Chapter 938, Chapter 939, Chapter 940, Chapter 941, Chapter 942, Chapter 943, Chapter 944, Chapter 945, Chapter 946, Chapter 947, Chapter 948, Chapter 949, Chapter 950, Chapter 951, Chapter 952, Chapter 953, Chapter 954, Chapter 955, Chapter 956, Chapter 957, Chapter 958, Chapter 959, Chapter 960, Chapter 961, Chapter 962, Chapter 963, Chapter 964, Chapter 965, Chapter 966, Chapter 967, Chapter 968, Chapter 969, Chapter 970, Chapter 971, Chapter 972, Chapter 973, Chapter 974, Chapter 975, Chapter 976, Chapter 977, Chapter 978, Chapter 979, Chapter 980, Chapter 981, Chapter 982, Chapter 983, Chapter 984, Chapter 985, Chapter 986, Chapter 987, Chapter 988, Chapter 989, Chapter 990, Chapter 991, Chapter 992, Chapter 993, Chapter 994, Chapter 995, Chapter 996, Chapter 997, Chapter 998, Chapter 999, Chapter 1000.*

Entered according to Act of Congress in the year 1880, by

WALTER S. BOOTH,

In the Office of the Librarian of Congress at Washington
WALTER S. BOOTH & SON, TOWNSEND AND LAW BUILDING, PHILADELPHIA, MINN.
7-02-2000

OWNERSHIP AND DESCRIPTION OF LANDS AS GIVEN IN THE PETITION.

OWNERS OF LANDS	DESCRIPTION OF LANDS	SECTION	TOWN	RANGE
J. E. Munges	1/2 SW 1/4	21	136	29
Olaf J. Skofen	1/2 SW 1/4	21	136	29
M. C. Anderson	1/2 SW 1/4	21	136	29
Mrs. Erickson	1/2 SW 1/4	21	136	29
Erick E. Wallin	1/2 SW 1/4	21	136	29
John Bauch	1/2 SW 1/4	21	136	29
Peter E. Wallin	1/2 SW 1/4	21	136	29
Alfred Soder	1/2 SW 1/4	21	136	29
State School Land	All of Section 16	16	136	29
Over Knutson	1/4 SW 1/4 NW 1/4	9	136	29
Ludvig Matheson	1/4 SW 1/4 SW 1/4	9	136	29
unt. now	1/4 SW 1/4	9	136	29

The names of the Petitioners, the places where, and the time when the copies of the Petition and of the Supervisors' Notice of Hearing were posted; and the names of persons served with the Supervisors' Notice, and how served (personally or "by copy") are as follows, viz:

NAMES OF PETITIONERS	PETITION AND NOTICES, WHEN AND WHERE POSTED	SUPERVISORS' NOTICE, ON WHOM SERVED	HOW SERVED
Erick E. Wallin Mads C. Anderson Ludvig Matheson Peter Gordon Olaf J. Skofen John Bauch E. H. Erickson	on Stony Brook Road between ^{1/2} 28 and 21 at Commencement of Road. at Centre of Section also in Twp 136.29 and at Town Clerk's Office in sec. 9. 136-29.		
	All the above notices posted on 11 ¹² Sept A. D. 1902		

State of Minnesota, County of Lacs Town of Loom Lake SS:

Whereas, Upon the petition of Steven (7) legal voters who own real estate or who occupy real estate under the homestead or pre-emption laws of the United States, or under contract from the State of Minnesota, within two (2) miles

of the ^{cutway} ~~road~~ proposed in said petition to be ~~surveyed, laid out and opened for public travel~~ ^{public travel}; which said petition was filed with the Town Clerk previous to the time of posting copies thereof, and copies of said petition having been first duly posted up in three of the most public places of said Town, at least twenty days before any action was had in relation thereto, proof of which posting was duly shown to us by affidavit; which said proposed Cutway is set forth and described in said petition as follows, viz: Beginning

on the Stony Brook Road at a point (A.P. 1) which is a distance of ch. 38.22 East (2522.52') (Vⁿ. 9° 15') from the section corner post between sections 20, 21, 28 and 29, Twp. 136 R. 29, Cass Co. Minn., and running north from said point (Vⁿ. 9° 50') to the North 1/4 sec. Post between sec. 16 and 21, a distance of ch. 81.77 (5396.82)'. Thence north (Vⁿ. 9° 06') to the North 1/4 sec. Post between sec. 9 and 16 making a detour or jog as appears on Plat of this cutway on file in the Town Clerk's office of Loom Lake Twp. and also on record a file at Cass Co. Auditor's office - Walker Minn. Thence (Vⁿ. 9° 07') north to the center of section 9, a distance of ch. 41.16 (2716.56') and thence connecting with the Mayo Brook Road.

And Whereas, Upon receiving said petition, we did, within thirty days thereafter, make out a notice and fix therein a time and place at which we would meet and decide upon such application, to-wit: On the 30 day of Sept A. D. 1902 at Town Clerk's office of Loom Lake Twp.

causing copies of such notice to be posted in three public places in said Town, at least ten days previous to such meeting; and having met at such time and place as above named in said notice, and being satisfied that the applicant had, at least ten days previous to said time, caused said notice of time and place of hearing to be given to all the occupants of the land through which such highway might pass, by serving the same personally or by copy left at the usual place of abode of each of said occupants, proof of which was shown by affidavit, we proceeded to examine personally such highway, and heard any and all reasons for or against the

the same, and being of opinion that such Cutway was necessary and proper, and that the public interest would be promoted thereby, we granted the prayer of said petitioners and determined to ~~survey, lay out and open for public travel~~ ^{surveyed, laid out for} said road, and caused a survey thereof to be made according to the report and plat herewith accompanying, the description of which as so surveyed, laid out for is as follows, to-wit: Beginning

on the Stony Brook Road at a Point (A.P. 1) which is a distance of ch. 38.22 East (2522.52') (Vⁿ. 9° 15') from the section corner post between sections 20, 21, 28 and 29, Twp. 136 R. 29, Cass Co. Minn., and running north from said point (Vⁿ. 9° 50') to the North 1/4 sec. Post between sec. 16 and 21 a distance of ch. 81.77 (5396.82)'. Thence north (Vⁿ. 9° 06') to the North 1/4 sec. Post between sec. 9 and 16 making a detour or jog as appears on Plat of this cutway on file in the Town Clerk's office of Loom Lake Twp. and also on record a file at Cass Co. Auditor's office Walker Minn. Thence (Vⁿ. 9° 07') north to the center of section 9, a distance of ch. 41.16 (2716.56') and thence connecting with the Mayo Brook Road.

It is Therefore Ordered and Determined, That a road be, and the same is hereby surveyed, laid out and opened for public travel and established according to the description last aforesaid, and the report and plat herewith accompanying, which is hereby made a part of this Order, and it is declared to be a public highway 100 (2) rods wide, the said description above given being the center of said road.

Given under our hands, this 30 day of Sept. A. D. 1902

John Oberleiter
Ericks E. Wallis
Fred Hanson } Supervisors.

To the Board of Supervisors of the Town of Lyon Lake County of Cass and State of Minnesota:

The undersigned, having been employed by you to make a survey of a road in said Town, would report that the following is a correct survey of the line thereof, as made by me under your directions, to-wit: Beginning at a point (A.P. 1) on the Stony Brook Road between Sections 21 and 25 Township 136 Range 29 thence running as follows, with a variation of as follows degrees and minutes:

STATION	BEARING	DISTANCE	REMARKS
A.P. 1.	North $V^{\circ} 9' 10''$	ch. 81.77 (5396.82) ^{between sec 16 & 21} $\frac{1}{4}$ sec stake	N.B. This cartway is two road wide (i.e. 2 rods on either side of centerline).
A.P. 2	North $39^{\circ} 24' W$	ch. 2.97 (196.02)	Total distance of cartway from A.P. 1. on Stony Brook Road to terminus on Mayo Brook Road - is as follows:
A.P. 3	N $13^{\circ} 54' E$	ch. 3.05 (201.30)	A.P. 1 to $\frac{1}{4}$ sec stake between sec. 16 & 21. ch. 81.77 (5396.82')
A.P. 4	N $49^{\circ} 36' E$	ch. 3.60 (237.12)	From said $\frac{1}{4}$ stake to $\frac{1}{4}$ stake between sec. 9 & 16 ch. 81.92 (5406.72')
			From latter stake to terminus of road - 253' at center of section 9. = ch. 44.16' (2716.36')
			(See enlarged Plat on file of this cartway in Auditor's office.)

and that below is a correct plat of said road according to said survey.
 Dated at Pegroot, Minn. this 19th day of August A. D. 1905
W. H. Luffman Surveyor.

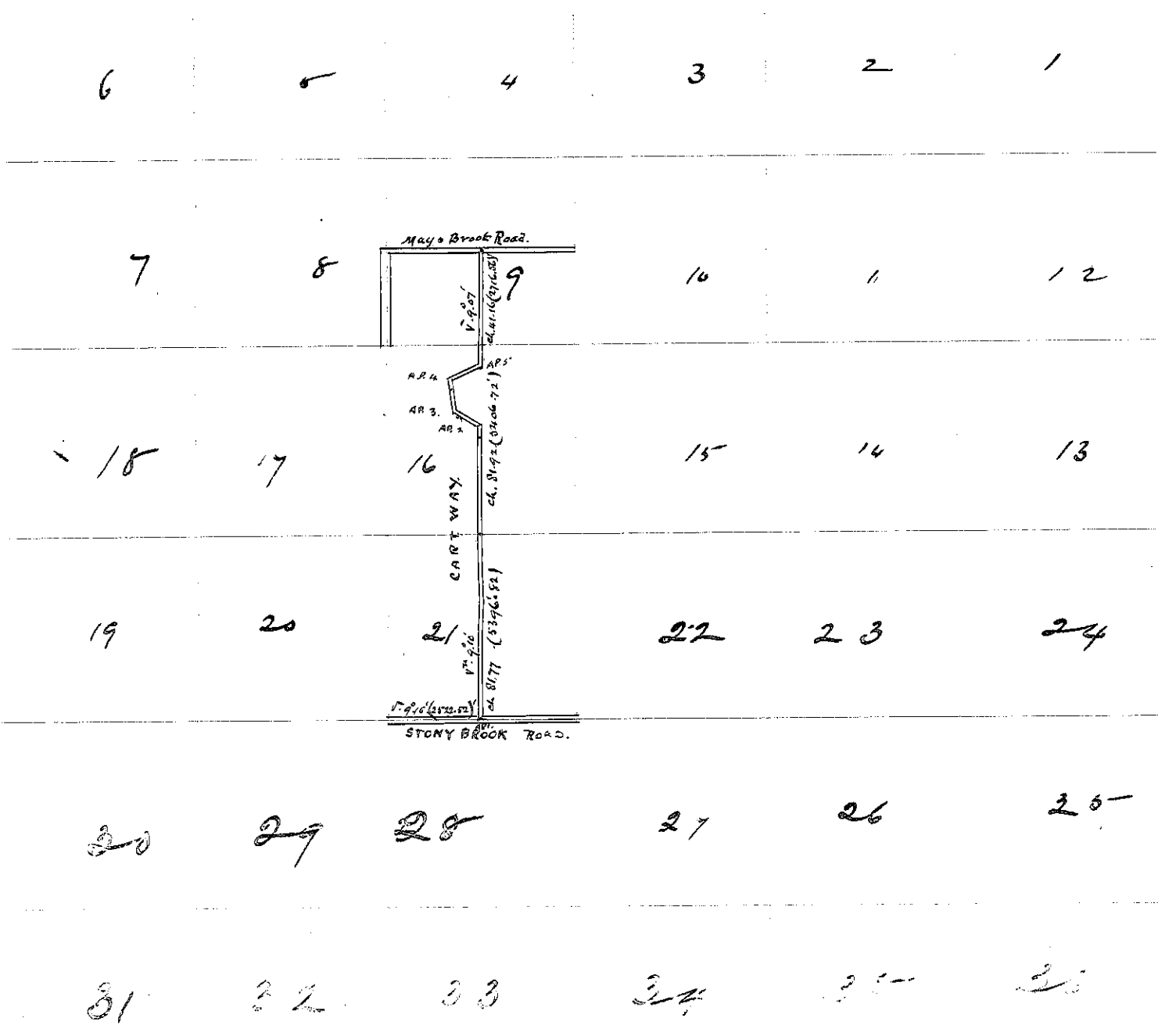

State of Minnesota, County of Cass Town of Loom Lake SS:

Whereas, A road was laid out on the 19th day of August A. D. 1904, by us, the Supervisors of the said Town of Loom Lake on the petition of seven (7) legal voters who own real estate or who occupy real estate under the homestead or pre-emption laws of the United States, or under contract from the State of Minnesota, within two (2) miles*

entirely of said ~~road~~, which said ~~road~~ entirely is set forth and described in the foregoing Supervisors' Order, made by us, and,

Whereas, A part of the damages sustained by reason of the laying out entirely said road has been ascertained by the agreement of the owners of the lands through which said road passes, with us, and a part of the owners of the said lands have in writing released all claims to damages; but not being able to agree with the owners of the following described lands, claiming damages by reason of said highway passing through, and the owners of some of the said lands being unknown, we have assessed the damages to each of such individual claimants with whom we could not agree, and awarded damages to the owners of such lands through which such highway passes as are unknown, at what we deemed just and right; taking into account and estimating the advantages and benefits the road will confer on the claimants and owners, as well as the disadvantages. We have assessed and awarded damages as follows:

OWNERS OF LANDS	DESCRIPTION OF LANDS	SECTION	TOWN	RANGE	DAMAGES
-----------------	----------------------	---------	------	-------	---------

No damages claimed

And in case of the following lands and claimants for damages, we estimate that the advantages and benefits said road will confer on them are equal to all damages sustained by them by reason of laying out said entirely ~~said road~~ to-wit:

OWNERS OF LANDS	DESCRIPTION OF LANDS	SECTION	TOWN	RANGE
-----------------	----------------------	---------	------	-------

J. E. Munger	R 1/2 S 8 1/4	21	136	29
Joe J. Skojen	R 1/2 S 8 1/4	21	136	29
Mrs. Anderson	S 1/2 SW 1/4	21	136	29
Mrs. Erickson	R 1/2 SW 1/4	21	136	29
Erick B. Wallin	S 1/2 SW 1/4	21	136	29
John Branch	R 1/2 SW 1/4	21	136	29
Peter B. Wallin	R 1/2 R 8 1/4	21	136	29
Alfred Loder	R 1/2 R 8 1/4	21	136	29
Plak School Land	all 1/2 Section 14	16	136	29