

CERTIFICATE OF LOCATION OF GOVERNMENT CORNER

EAST 1/4 Corner of Section 17, Township 140 N, Range 27 W, 5th P.M.
County of Cass, State of Minnesota

At the corner location shown on the sketch:

- On _____ found _____
- left monument as found lowered monument removed monument (explain)
- On 5/16/23 set 1 inch diameter by 32 inch alum pipe with a 3-1/4 inch diameter aluminum cap.

SKETCH OF REFERENCE TIES (NOT TO SCALE)

WOODED

WOODED

DBL NAIL & WASHER
E FACE 14" BALSAM



S83dW
20.77

DBL NAIL & WASHER
N FACE 14IN BALSAM

WOODED



S10dE
16.80

S16-T140N-R27W
S17-T140N-R27W

DBL NAIL & WASHER
W FACE 12" BALSAM

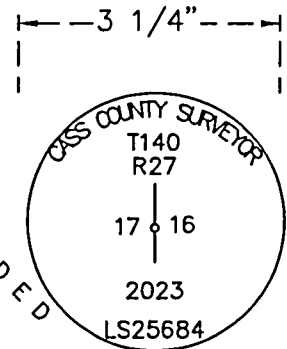

Cap Stamping Detail

Cass County Coordinates
(South Zone, 2011 Adj.)
N: 150323.91
E: 525688.47

Statement of evidence relative to this corner location is on the back of this page

I hereby certify that this survey, plan, or report was prepared by me or under my direct supervision and that I am a duly Licensed Land Surveyor under the laws of the state of Minnesota.

Daniel J. McAninch
Cass County Surveyor
MN License No. 25684

22 May 2024
Date

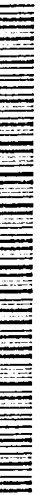

STATEMENT OF EVIDENCE:

EAST QUARTER CORNER OF SECTION 17
TOWNSHIP 140 NORTH, RANGE 27 WEST,
TRELIPE TWP. , CASS COUNTY MINNESOTA

1870 During the original survey a wood post was set, by a GLO crew under Findall G. Winston, to mark the corner. The bearing ties were set. Copies on file in the Cass County Highway Department/Surveyors office. (CCHD/SO).

8" Jack Pine	N89d30'E	28 links (16.5')
6" Cedar	S41dW	54 links (35.6')

2023 A Cass County Survey crew conducted a thorough search for physical evidence. Finding none, they set a monument at a position determined by single proportion between a the monumented Southeast Corner of Section 17 and a found iron pipe marking the Northeast Corner of Section 17.

CASS COUNTY COORDINATES (NAD 83 2011 ADJUSTMENT)

N-150323.908
E-525688.470

General Land Office Information on file in the MN historical Society, St. Paul MN. Copies on file in the Cass County Highway Department/Surveyors Office (CCHD/SO).

For additional information contact:
Cass County Highway Department
County Surveyor's Office
8045 County Road 12
Walker, MN 56484
218-547-1211



A000702939

OFFICE OF THE COUNTY RECORDER
CASS COUNTY, MINNESOTA
CERTIFIED, FILED, AND/OR
RECORDED ON

5/22/2024 9:36:15 AM

AS DOC #: A000702939

PAGES: 2

REC FEES: 0.00

BY CF Dep TX#: 196682