



A000673889

OFFICE OF THE COUNTY RECORDER
 CASS COUNTY, MINNESOTA
 CERTIFIED, FILED, AND/OR
 RECORDED ON

6/25/2021 10:25:42 AM

AS DOC #: A000673889

PAGES: 2

REC FEES: 0.00

KATHRYN M. NORBY
 CASS COUNTY RECORDER

BY NG Dep TX#: 172922

Index No. N.0-17.0

CERTIFICATE OF LOCATION OF GOVERNMENT CORNER

NE Corner of Section 22, Township 143 N, Range 30 W, 5th P.M.
 County of Cass, State of Minnesota

At the corner location shown on the sketch :

- On June 21, 2021 found 2" iron pipe, up 12" with GLO iron post monument
 alongside north.
- left monument as found lowered monument removed monument (explain)
- On _____ set _____

**SKETCH OF REFERENCE TIES
 (NOT TO SCALE)**

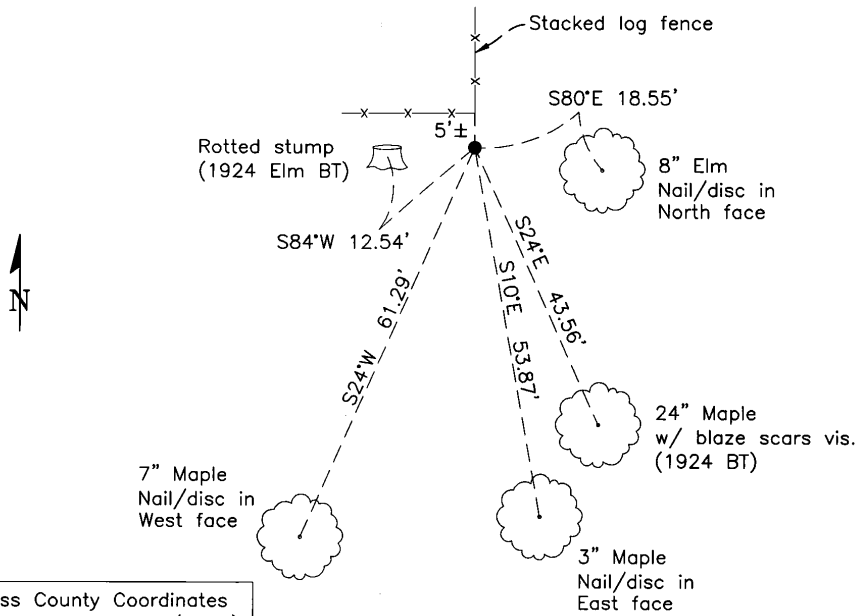

Statement of evidence relative to this corner location is on the back of this page

I hereby certify that this survey, plan, or report was prepared by me or under my direct supervision and that I am a duly Licensed Land Surveyor under the laws of the state of Minnesota.

[Signature]

Aaron J. Skattum
 Cass County Surveyor
 MN License No. 54139

6-24-2021
 Date

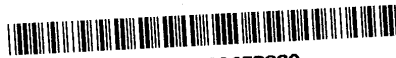

Index No. N.0-17.0

STATEMENT OF EVIDENCE

Northeast Corner of Sec. 22, T.143N., R.30W., 5th P.M., Cass County, MN

1875 B.C. Baldwin, U.S. General Land Office (GLO), originally established this corner while surveying the subdivision lines of this township, and set a wood post to mark the corner position with the following witnesses:

14" Maple	N73.5°E	40 links (26.40')
15" Maple	N14.5°W	57 links (37.62')
6" Elm	S80°W	19 links (12.54')
10" Maple	S78°E	22 links (14.52')

Information on file at the MN Historical Society, St. Paul, MN. Copies filed with the Cass County Surveyor's Office (CCSO).

1916 J.W. Curo (Curo Book 55, Page 23, CCSO Records) found all four bearing trees plainly marked, except for the SE BT, which was a stump, and also found the point of the old stake. A new hub was set and bearing trees were checked and found to be accurate. The hub was later replaced during this survey with a 2"x48" iron pipe monument.

1924 E.G. Harrington, U.S. General Land Office, during a dependent resurvey of this township found a 2" galvanized iron pipe, 12" above ground and set an iron post monument north and alongside iron pipe, with the following ties noted:

40" Maple	N72°45'E	26.4'	1875 BT
30" Maple	N12°15'W	37.62'	1875 BT
30" Elm	S84°00'W	12.54'	1875 BT
20" Maple stump	S80°45'E	14.52'	1875 BT
8" Maple	S24°00'E	43.56'	New BT

Information on file at the MN Historical Society, St. Paul, MN. Copies filed with the Cass County Surveyor's Office (CCSO).

2002 T. Freeman, on the plat of NI GIG WAH NOE SHORES (Doc. A000459898, Cass County Recorder's Office), indicates a brass cap monument found at this corner.

2007 B. Skipton, on the plat of NI GIG WAH NOE SHORES FIRST ADDITION (Doc. A000529829, Cass County Recorder's Office), indicates a GLO brass monument found at this corner.

2021 A. Skattum, Cass County Surveyor, (CCSO Project #2021.025) found a 2" o.d. iron pipe, up 12", with a GLO iron post and brass cap alongside north. Both monuments were in good condition and as described in the 1924 GLO notes. The uncapped pipe was accepted as being a direct perpetuation of the original GLO corner, and the following ties were noted:

40" Maple	N72°45'E	26.4'	1875 BT, no evidence found
30" Maple	N12°15'W	37.62'	1875 BT, no evidence found
30" Elm	S84°00'W	12.54'	1875 BT, found decayed wood fragments
20" Maple stump	S80°45'E	14.52'	1875 BT, no evidence found
8" Maple	S24°00'E	43.56'	1924 BT, now 24" with scars visible
3" Maple	S10°E	53.87'	New BT, nail & disc in east face
8" Elm	S80°E	18.55'	New BT, nail & disc in north face
7" Maple	S24°W	61.29'	New BT, nail & disc in west face