



A000608481

OFFICE OF THE COUNTY RECORDER  
CASS COUNTY, MINNESOTA  
CERTIFIED, FILED, AND/OR  
RECORDED ON

12/26/2014 9:18:28 AM

AS DOC #: A000608481

PAGES: 2

REC FEES: 0.00

KATHRYN M. NORBY  
CASS COUNTY RECORDER

BY SR Dep TX#: 120142

Page 1 of 2 A000608481

### CERTIFICATE OF LOCATION OF GOVERNMENT CORNER

I hereby certify that this survey, plan, or report was prepared by me or under my direct supervision and that I am a duly Licensed Land Surveyor under the laws of the State of Minnesota.

*Patrick A. Prother*

Date: 12-16-14 License No: 41002

East Quarter Corner of Section 12, Township 140 N, Range 26 W, 5<sup>th</sup> P.M.

On 5-16-14 found a 1/2" iron pipe, 0'± below grade, 2'± south of centerline of County Road 161

left monument as found,  lowered monument,  removed monument (explain)

On \_\_\_\_\_ placed a \_\_\_\_\_

### SKETCH OF REFERENCE TIES

Not to Scale

Corner Index:

G-25

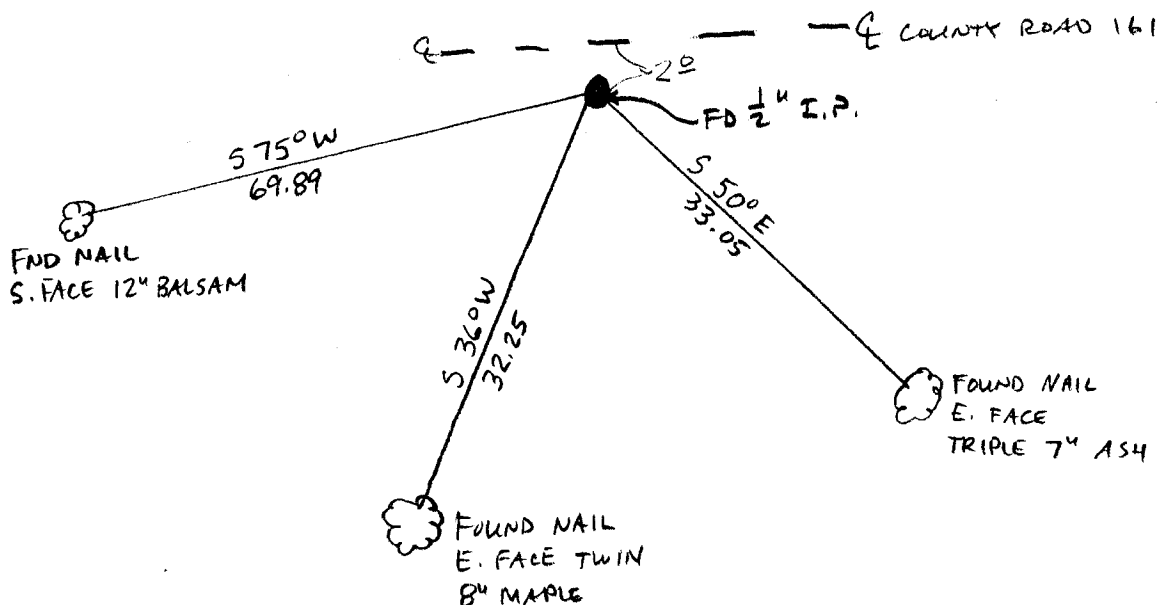

Statement of evidence for this corner position is on the back of this page



**Statement of Evidence**

**East quarter corner, Section 12, Township 140 North, Range 26 West, 5<sup>th</sup> Principal Meridian, Cass County, Minnesota**

1864 – Original U.S. Government Survey establishing this corner was performed. A wood post was set marking its location from which the following witnesses were established:

7" Fir	N 24° E	16 links
8" Cedar	N 53° W	28 links

1916 – Alois Nowak, in County Survey Record Book B, pages 328-333, and in Curo Book 55, pages 61 and 76, denotes the original fir bearing tree has disappeared. Finds the cedar stump B.T., from which he sets by original bearing and distance a 3x3 birch post as the true corner and establishes two additional witnesses:

18" W. Pine stump	N 48° W	18.70 feet
20" W. Pine stump	NORTH	23 feet

1937 – CCC-Washburn Lake field book 1, page 39; field book 3, page 70; field book 4, page 30 all indicate an existing 2" iron pipe in place in township road.

1998 – CCSO staff found a ½" iron pipe lying 2 feet south of centerline of a township road. Established the following witnesses:

7" Tri. Ash	S 50° E	33.05 feet
8" Twin Maple	S 36° W	32.25 feet
12" Balsam	S 75° W	69.89 feet
6" Ash	N 38° E	80.75 feet

\* double headed nails were set in each tree

2014 – Patrick Trottier, PLS 41002, found and accepted as corner a ½" iron pipe. Found the SE and both SW witnesses from 1998.

County Coordinates (Cass County North)  
Northing 155381.12  
Easting 578768.45