



A000602211

OFFICE OF THE COUNTY RECORDER
CASS COUNTY, MINNESOTA
CERTIFIED, FILED, AND/OR
RECORDED ON

5/8/2014 11:38:22 AM

AS DOC #: A000602211

PAGES: 2

REC FEES: 0.00

KATHRYN M. NORBY
CASS COUNTY RECORDER

BY SR _____ Dep

Page 1 of 2
A000602211

Twp 140 Rge 28 Index No. J.0-15.0

CERTIFICATE OF LOCATION OF GOVERNMENT CORNER

North Quarter corner of Section 15, Township 140 N., Range 28 W., 5th P.M.

State of Minnesota, County of Cass

At the corner location shown on the sketch:

On 5 Sept. 2007 found a 2 inch outside diameter iron pipe, up 2.9 feet,
in woven wire fence East to West.

left monument as found lowered monument removed monument (explain)

On _____ placed _____

SKETCH OF REFERENCE TIES NOT TO SCALE

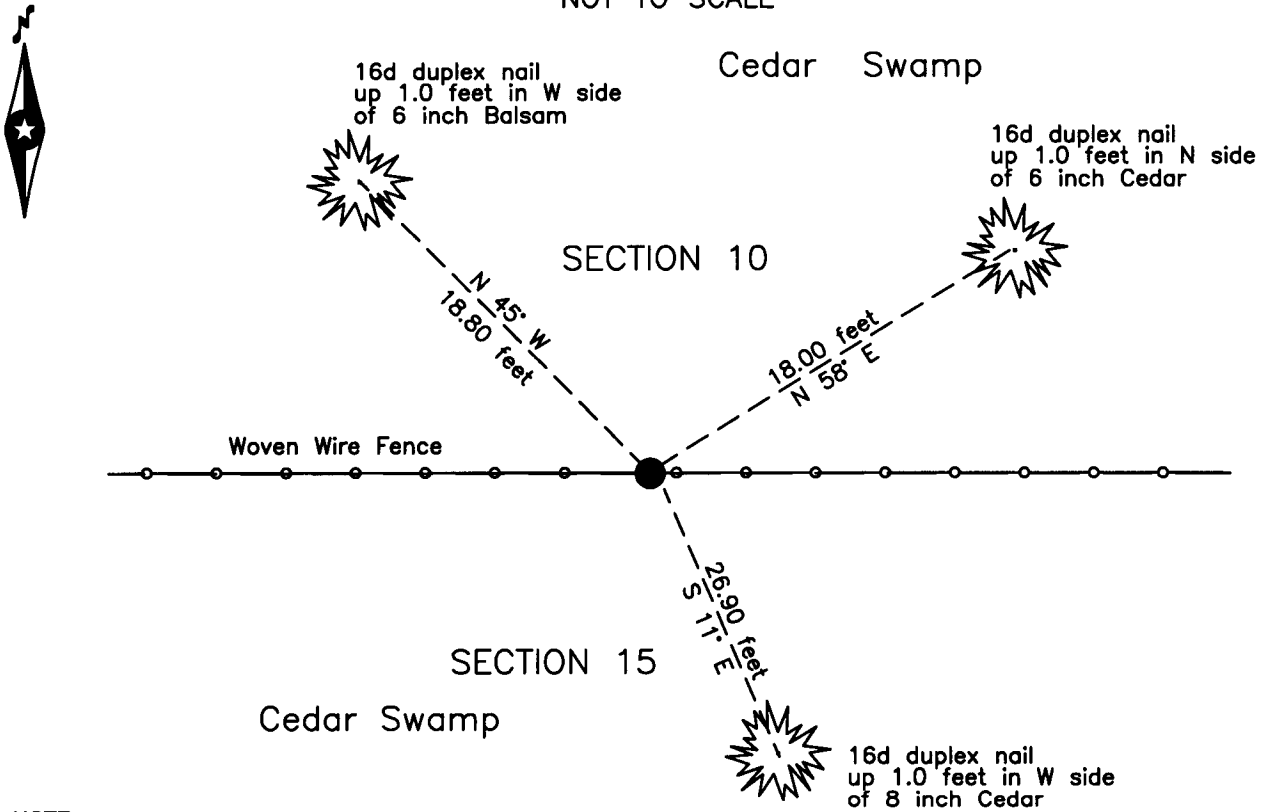

NOTE:
All bearings are true

Statement of evidence relative to this corner location is on the back of this page.

I hereby certify that this survey, plan or report was prepared by me or under my direct supervision and that I am a duly Licensed Land Surveyor under the laws of the State of Minnesota.

Terry L. Freeman, Cass County Surveyor
Date 5/7/14 MN License No. 21367



Statement of Evidence

North Quarter corner section 15, Township 140 North, Range 28 West, 5th Principal Meridian.

- Jan. 1870 O. Smith, General Land Office (GLO) Deputy Surveyor, notes for the subdivision of Township 140 North, Range 28 West, set a post for the original corner and referenced it as follows:
 4" Cedar N 5° W 5 links (3.30 feet) 7" Cedar S 5° E 4 links (2.64 feet)
 The above record is on file with the Minnesota Historical Society in St. Paul, Minnesota, copies are filed with the Cass County Highway Department, Surveyor's Office (CCHD/SO).
- April 1917 Ben Clark, LS 231, Cass County Deputy Surveyor, Survey Record No. 387, Book C, page 67 and Curo Book 156, page1, on file in the CCHD/SO, notes the GLO witnesses and states "thence set a cedar post 4 in."
- Aug. 1919 Ben Clark, LS 231, Cass County Deputy Surveyor, Survey Record No. 422, Book C, page 199 and Curo Book 177A, pages 69, 73 and 75, on file in the CCHD/SO, states "the ¼ sec. cor. sec. 10-15 found a cedar post 4 ft long and 4 in. squ. Marked ¼ S with a scribe iron. Found a cedar tree down marked ¼ S. B.T. a cedar stump B.T. These are the witness trees for the corner." On page 200 states "Set a iron pipe 4 ft. long and 2 in. in dia. From the old witness trees" and witnessed as follows:
 7" Cedar S 15° W 8.2 feet 12" White Birch N 2° E 11.5 feet
- Feb. 1946 W.J. Spain, LS 2003, Spain Book 1938, page 78, on file in the CCHD/SO, indicates he found the subject corner.
- Aug. 1966 Cass County Highway Department (CCHD) S.A.P. 11-654-01, plan on file in the CCHD, indicates a 2 " I.P., East of centerline Station 175+30.
- Dec. 1998 R. Mustonen, LS 11946, Certificate of Survey for YMCA Camp Olson, on file at AMI Surveyors & Mappers, a copy on file in the CCHD/SO, indicates a monument found at the subject corner.
- Sept. 2007 B. Hippen, technician, records of the CCHD/SO, found a 2" ODIP, up 2.9 feet, in a woven wire fence running East and West, in a Cedar Swamp and witnessed as follows:
 6" Balsam N 45° W 18.80 feet 6" Cedar N 58° E 18.00 feet
 8" Cedar S 11° E 26.90 feet
- May 2014 B. Hippen, technician, records of the CCHD/SO, found the monument and witnesses from 2007. The monument, recovered and established references for the position are shown on the face of this document.

Analysis of the recovered record data, field evidence and survey measurements, indicates that the monument recovered by CCHD/SO in 2007 is the correct perpetuation of this corner.

County Coordinates (Cass County North)

Northing 153203.50
Easting 502982.14