

CERTIFICATE OF LOCATION OF GOVERNMENT CORNER

North Quarter Corner of Section 11
Township 138 N, Range 31 W, 5th P.M.
STATE OF MINNESOTA, COUNTY OF Cass



A000599914

OFFICE OF THE COUNTY RECORDER
CASS COUNTY, MINNESOTA
CERTIFIED, FILED, AND/OR
RECORDED ON

1/27/2014 10:38:25 AM

AS DOC #: A000599914

PAGES: 2

REC FEES: 0.00

KATHRYN M. NORBY
CASS COUNTY RECORDER

BY SR Dep

Page 1 of 2 A000599914

On 10/30/2012, found a(n): 2" Capped Iron Pipe up 0.3'
in Good Condition.

- left monument as found
- removed monument (explain)
- lowered monument
- raised monument

On _____, set a(n): _____
DATE

See "Statement of Evidence" for further details (on back)

(reserved for recording data)

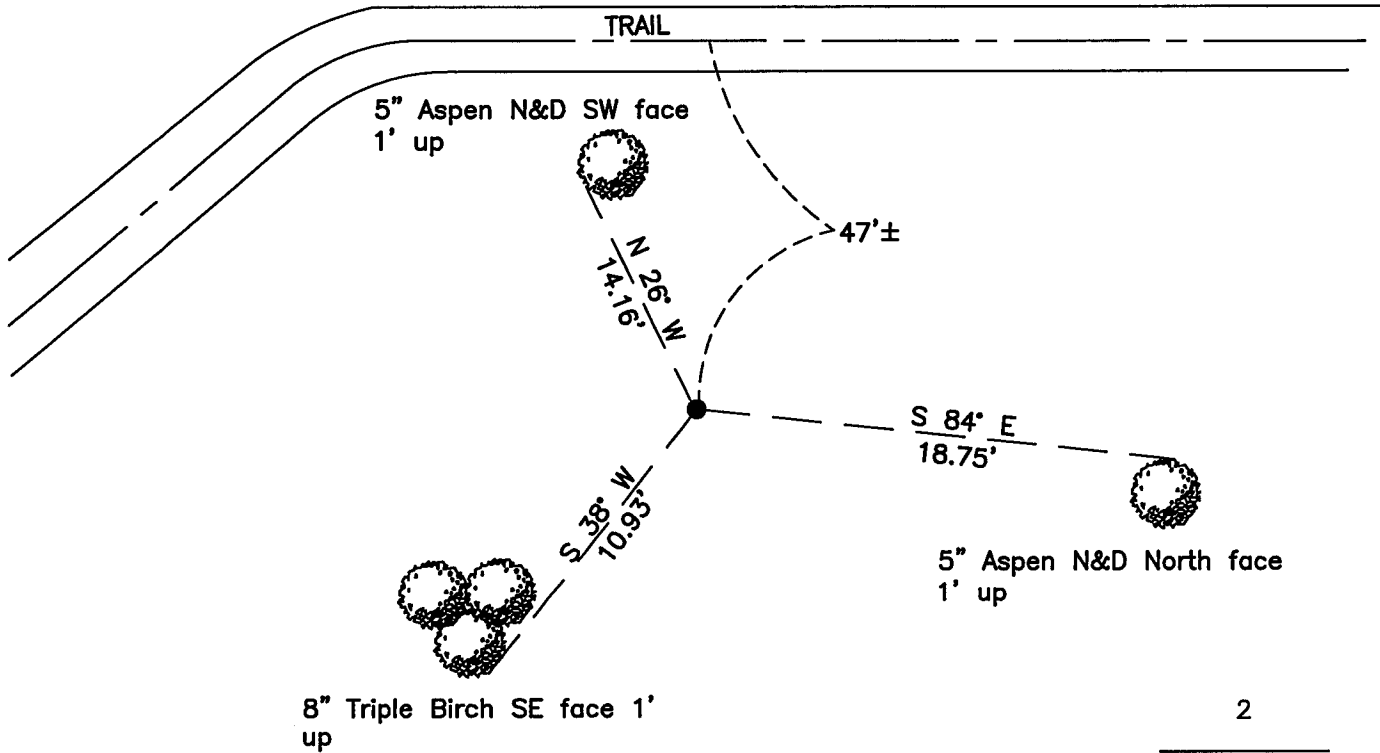

2

11

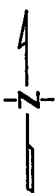

"SKETCH OF REFERENCE TIES" (not to scale - bearings are magnetic)

Ties are measured to center of monument unless otherwise noted.

UNITS = Metric English

CASS COUNTY SOUTH COORDINATES

Northing: 331458.242

Easting: 475079.124

NAD 83/2007 Adjustment.

Obtained by RTK GPS observations.

I hereby certify that this survey, plan, or report was prepared by me or under my direct supervision, and that I am a duly Licensed Land Surveyor under the laws of the State of Minnesota.

signature
Jarrett M. Leas, Minnesota License No. 42619

1-14-14
date

Statement of Evidence**North Quarter corner of Section 11, Township 138 North, Range 31 West, 5th Principal Meridian.**

- Nov. 1870 T.B.Walker, General Land Office (GLO) Deputy Surveyor set a post for the original corner and referenced it as follows:
16" W. Pine S 03° W 40 links
6" Linden N 33° 30' E 28 links
Said records are on file at the Minnesota Historical Society, St. Paul, Minnesota, copies are filed with the Cass County Surveyor's Office (CCSO).
- May 1915 J.W. Curo, Cass County Surveyor, LS 1428, County Surveyor, County Resurvey, on file at the Cass County Records Office, in cabinet E, sheet 47 indicates a 2 1/4"X4' Iron Monument was set.
- Nov. 1919 J.W. Curo, LS 1428, Book 26, Page 25, Curo commences cutting a line south at said corner.
- Oct. 2012 A KLJ survey crew found a 2" capped Iron Pipe, and is witnessed with the ties shown on the front of this certificate. Jarrett Leas, RLS #42619, after analysis of record and survey information accepts this monument as the correct perpetuation of the corner.