



A000583951

OFFICE OF THE COUNTY RECORDER
CASS COUNTY, MINNESOTA
CERTIFIED, FILED, AND/OR
RECORDED ON

9/10/2012 9:08:50 AM

AS DOC #: A000583951

PAGES: 2

REC FEES: 0.00

KATHRYN M. NORBY
CASS COUNTY RECORDER

BY SR _____ Dep

Index Number A.6-25.0

CERTIFICATE OF LOCATION OF GOVERNMENT CORNER

MC #27 EAST LINE Corner of Section 1, Township 140, Range 29
5TH Principal Meridian, State of Minnesota, County of Cass

At the corner location shown on the sketch:

On 1-25-11 found a Telspar Monument

left monument as found lowered monument removed monument (explain)

On _____ placed an _____

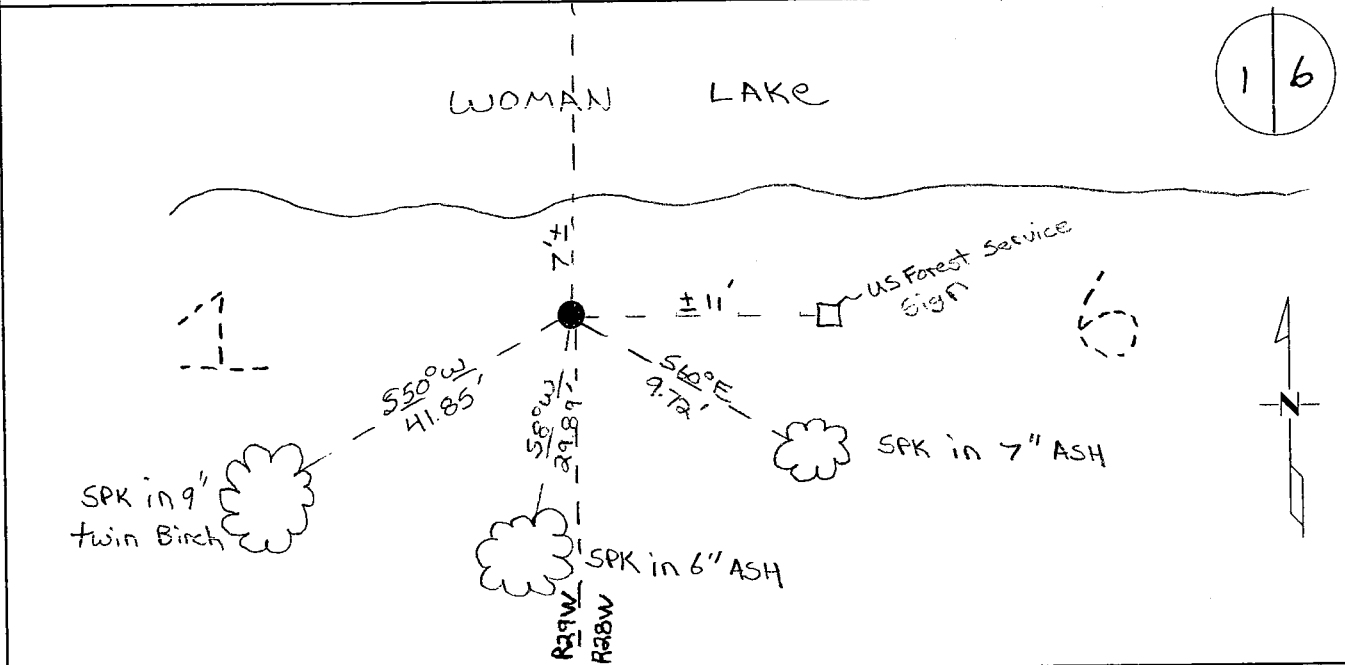

Statement of evidence for this corner location is on back of this page.

I hereby certify that this document was researched and prepared by me or under my direct supervision and that I am a licensed Land Surveyor under the laws of the State of Minnesota.

Signature Chris Hoglund
Chris Hoglund, PS
License No. 43932

Date: 7/19/12





Statement of Evidence:

Meander Corner #27 on the East line of Section 1, Township 140 North, Range 29 West, Woodrow Township, 5th Principal Meridian, Cass County, Minnesota.

1864 Original US General Land Office survey by Johnson and Thornton, set a wood post and bearing trees noted as:

6" Willow	S 17° E	22 links
8" Cedar	S 53° W	40 links

1969 Survey notes of Robert F. Schneider, RLS 5740, showed a 1 ¼" iron pipe found on the shore of Woman Lake. Mr. Schneider's records contained a survey by Harold Curo, RLS No. 3417, dated March 8, 1961 which showed an iron monument at this location. Curo's survey also shows an iron at the North 1/16th corner of Section 1 and Section 6. Mr. Schneider extended these irons north to intersect the 10th Standard Parallel and found this computed position to fit very well with the GLO distances. The distance from the Southwest Standard Corner of Section 31, Township 141, Range 28 to the computed intersection was found to be 757.75 feet compared to GLO distance of 759.0 feet. Intersection to iron found at Meander Corner #27 was found to be 858.61 feet compared to GLO distance of 858.0 feet. Mr. Schneider accepted the in-place iron as marking the meander corner position and based metes and bounds surveys in Government Lot 10, Section 6, Township 140, Range 28 on the found iron monument. In 1971, Mr. Schneider conducted additional surveys in Section 6 involving the Subdivision of Section 6. (Entry derived from Corner Certificate No. 302547)

1977 Walt Curo shows corner in place on sketch, filed in Curo Book 258, Page 156.

1988 Gary Stevenson, Registered Land Surveyor Number 12684, found 1 ½" I.P. Set 2x2x36" monument with aluminum cap. Steel sign post north 1.25', filed Corner Certificate No. 302547, dated February 3, 1988. Reference ties:

9" Twin Birch	S 50° W	41.85 feet
11" Balsam	S 15° E	5.80 feet
7" Basswood	S 60° E	9.72 feet

2003 County Surveyors Office found 1988 Alum. Cap and witnesses, added the following reference tie:

6" Ash	S 8° W	29.89 feet
--------	--------	------------

No Date Coordinates as follows from Cass County North 1996 adjustment:
N: 163172.996 E: 484603.519

2011 Westwood Professional Services, Inc. found 1988 aluminum capped monument and two 1988 Stevenson Reference Ties. Located found monument with a 20 minute static GPS shot and verified coordinates with VRS GPS observation. Analysis of the recovered data, field evidence and survey measurements, indicates that the monument found by Westwood Professional Services, Inc is the best available evidence for this corner.

Cass County Coordinates South Zone obtained by static GPS (NAD 83, 1996 Adj)
N: 163172.90
E: 484602.79

Central State Plane Coordinate
N: 1048948.95
E: 2617591.72