

CERTIFICATE OF LOCATION OF GOVERNMENT CORNERQUARTER _____ Corner of Section 2/11, Township 141N, Range 26W, 5th P.M.STATE OF MINNESOTA, County of CASS

At the corner location shown on the sketch:

- On 4/12/02 found a 1 1/2" x 36" Iron pipe - 2' high
DATE
- left monument as found, lowered monument, removed monument (explain)
- On _____ placed a _____
DATE

SKETCH OF REFERENCE TIES

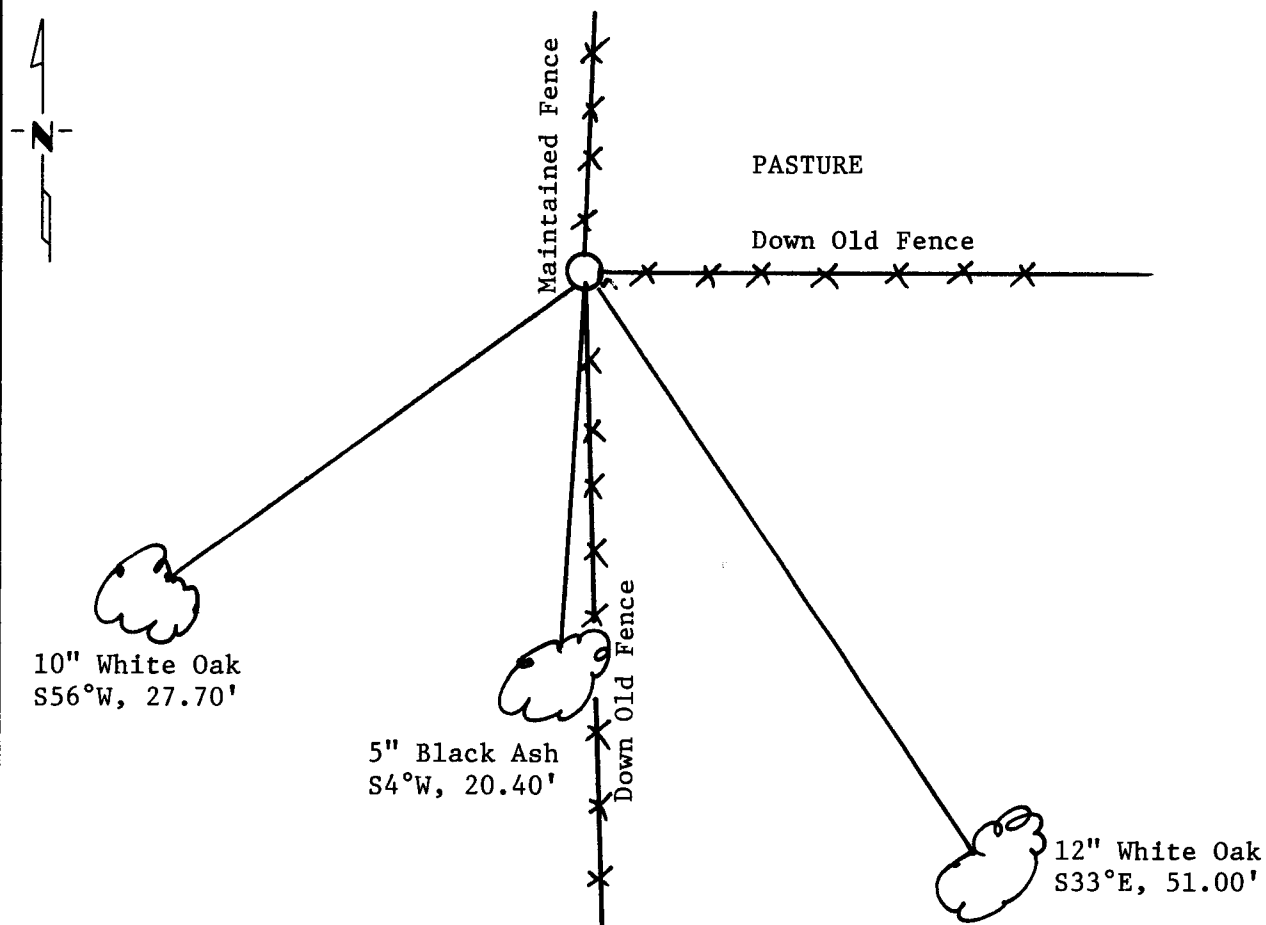

Statement of evidence relative to this corner location is on back of page.



I hereby certify that this document and the data contained herein was prepared by me or under my direct supervision.

Milo E. Stefan 2/11/05
SIGNATURE DATE

Registration No. 12261

- Land Surveyor
 County Surveyor

OFFICE OF THE COUNTY RECORDER

County of _____

I hereby certify that this document was filed in the Co. Recorders office at _____ .M. on the _____ day of _____ A.D., 19 _____

County Recorder _____

By _____, Deputy

DOCUMENT NO. _____

Statement of Evidence:

ORIGINAL SURVEY

May 1871 - William Allen and Edgar Putnam set wood post at 40.05 chains for
Quarter Corner with two bearing trees:
8" Cedar, N15°E, 10 Links) Notes hard to read
20" White Pine, 362°W, 20 Links)

SUBSEQUENT SURVEYS

1910 - 1920 - Someone used this corner to subdivide section. This is evident
from other very old fencelines North, East and South from the
iron pipe that marks this corner.

I accept this iron pipe as the perpetuated position of the original Quarter
Corner.

Milo E. Stefan



A000496587

OFFICE OF COUNTY RECORDER
CASS COUNTY MINNESOTA

CERTIFIED, FILED, AND/OR
RECORDED ON
03/29/2005 01:28:46PM

AS DOC #: A000496587
PAGES: 2
REC FEES: \$0.00

KATHRYN M. NORBY
COUNTY RECORDER

BY *Kathryn M. Norby* DEPUTY
HW