

CERTIFICATE OF LOCATION OF GOVERNMENT CORNER

I hereby certify that this survey, plan, or report was prepared by me or under my direct supervision and that I am a duly Licensed Land Surveyor under the laws of the State of Minnesota.

David S. Landecker
 DAVID S. LANDECKER

Date: 8/24/04 License No: 17008
 17008

OFFICE OF THE COUNTY RECORDER
 County of CASS

I hereby certify that this document was filed in the Office of the County Recorder at _____ o'clock _____ M. on the _____ day of _____, 20____ A.D.

County Recorder _____

By: _____, Deputy
 DOCUMENT NO. _____

Northeast _____ Corner of Section 2, Township 133, Range 30, 5th P.M.

On 03/24/04 found a FOUND A 3/8" ROD
 left monument as found, lowered monument, removed monument (explain)

On 6/21/04 placed a PLACED A 1" IRON PIPE WITH PLASTIC CAP #17008 OVER THE EXISTING ROD.

SKETCH OF REFERENCE TIES

CORNER INDEX A-21

Not to Scale

decl:



NOTE: DISTANCES SHOWN AS MEASURED TO NAIL IN SIDE OF FACE.

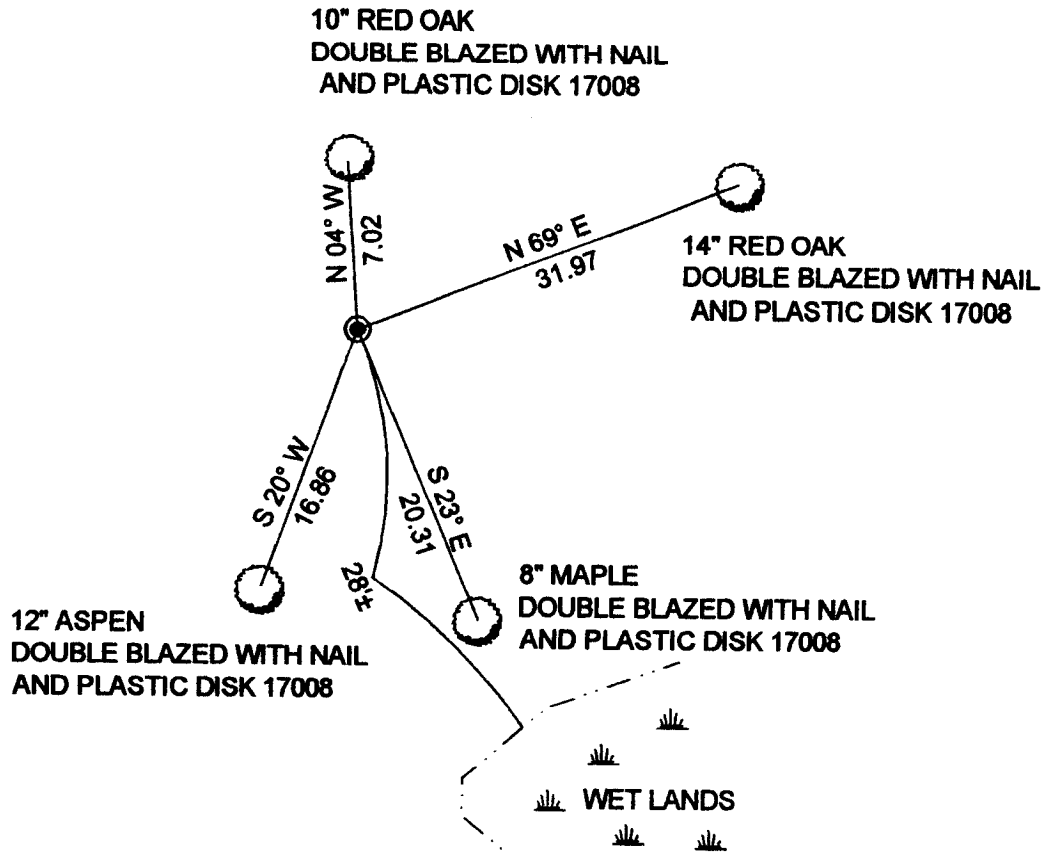

Statement of evidence for this corner position is on the back of this page.

Statement of Evidence: (A-21)

Northeast Corner, Section 2, Township 133 North, Range 30 West, Cass County, Minnesota

1858 - E.N. Darling, deputy U.S. Surveyor, in accordance with U.S. Government contract, surveyed the boundaries of Township 134 North, Range 30 West, 5th Principle Meridian and was subsequently approved by the U.S. Surveyor General. Whereby the referenced Government corner was set from which:

10" Pine	S 86° 15' W	180 Lks
12" Pine	N 83° 15' W	225 Lks

1972 - Robert F. Schneider RLS 5740, Cass County Surveyor, in private practice, made an extensive survey in Sections 25, 26, 35 and 36, T134N, R30W, Cass County, Mn. and in Sections 30 and 31, T134N, R29W, Crow Wing County, Mn.. Consulting with, then Crow Wing County Surveyor, Dean Anderson, RLS 3091 and referring to the records of both offices.

Notes of the field work and Corner ties are recorded Schneider's field book #33 pages 6, 9, 18, 19, 30, 31, 32 and 37. The field book, composite drawings of Section breakdowns and much of the materials used in said surveys are also on file in the Walker office of Landecker & Associates Inc..

2004 - Mark Crenshaw, surveyor with Landecker and Associates Inc., under the direction of David S. Landecker, Licensed Land Surveyor # 17008, searched extensively for evidence of the original corner and bearing trees for said Corner. Found a 3/8" iron rod in the location indicated by Schneider above, placed a 1 inch iron pipe with plastic cap 17008 over the existing monument and the following witnesses established:

10" Red Oak	N 04° W	7.02 Feet
14" Red Oak	N 69° W	31.97 Feet
12" Aspen	S 20° W	16.86 Feet
8" Maple	S 23° E	20.31 Feet

A000488141
OFFICE OF COUNTY RECORDER
CASS COUNTY MINNESOTA

CERTIFIED, FILED, AND/OR
RECORDED ON
08/24/2004 12:29:59PM

AS DOC #: A000488141
PAGES: 2
REC FEES: \$0.00

KATHRYN M. NORBY
COUNTY RECORDER
BY Kathryn M. Norby DEPUTY