

CERTIFICATE OF LOCATION OF GOVERNMENT CORNER

Special Meander Corner on West 1/16 line between Government Lot 2 and Government Lot 12, Section 6, Township 141 North, Range 29 West, of the 5th Principal Meridian. This corner, a 1" x 36" iron pipe with brass cap, is accepted as the original SMC set by the GLO Resurvey in 1918.

SKETCH OF REFERENCE TIES
Sec. 6, T 141 N, R 29 W



NOT TO SCALE

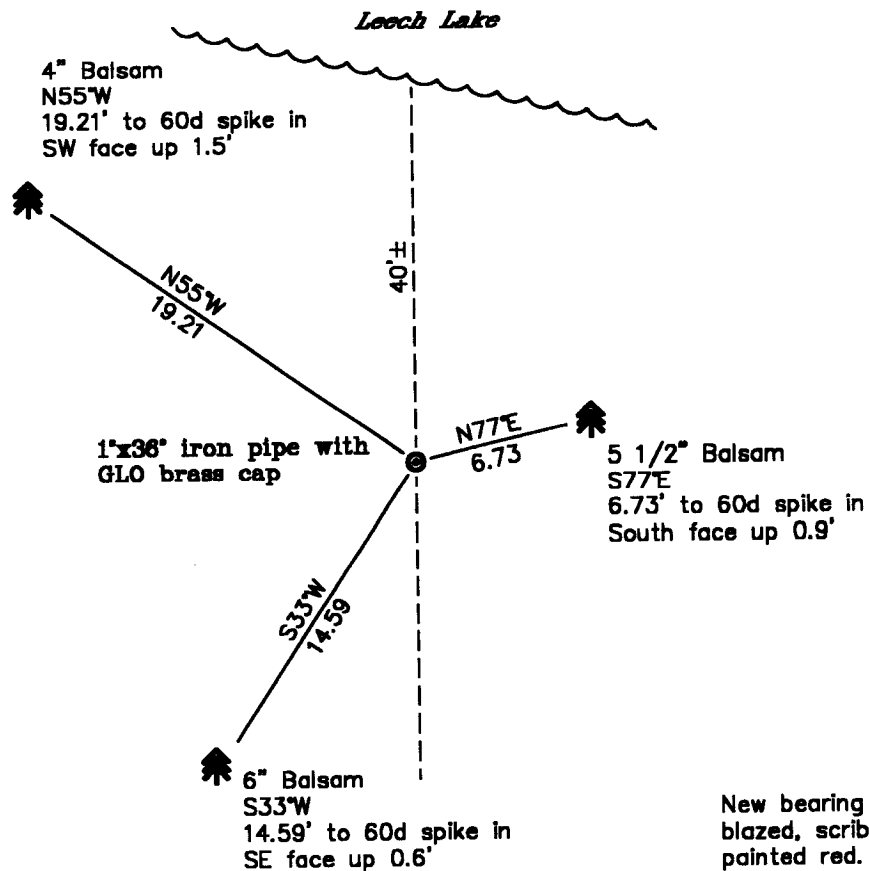
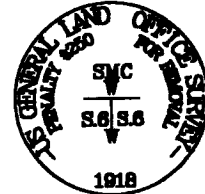

Bearings are Grid North, Minnesota Central Zone, measured with a hand compass adjusted to 3° East declination.

Abstract Document #480062

New bearing trees were blazed, scribed and painted red. A location tag was affixed to the tree. A 60 d spike was placed in the tree. The horizontal distance was measured from the monument to the spike.

Statement of evidence relative to this corner location is on the back of this page

I hereby certify that this survey, plan, or report was prepared by me or under my direct supervision and that I am a duly Licensed Land Surveyor under the laws of the State of Minnesota.

LaVerne Leuelling
LaVerne Leuelling Date 2-11-04
Licensed Land Surveyor No. 16089
Northern Lights Surveying & Mapping, Inc.

OFFICE OF THE COUNTY RECORDER
County of Cass

I hereby certify that this document was filed in the Recorder's office.

Time: 9:35 A.M. Date: 2-12-04
Recorder Raymond M. Deuby
By HV Deputy
DOCUMENT NO. 480062

Statement of Evidence

Page 2 of 2

Special Meander Corner on West 1/16 line between Government Lot 2 and Government Lot 12, Section 6, Township 141 North, Range 29 West, of the 5th Principal Meridian.

1918: Earl G. Harrington, US Surveyor, set a 1"x36" iron pipe with a brass cap from which he made the following BT's:

5" Birch	12" Poplar
S38°30'E	N73°30'W
50 lks (33.00')	48 lks (31.68')

Notes of G.L.O. Resurvey of 1918, Page 185. Said notes are on file with the Secretary of State, Saint Paul, Minnesota. Copies of these note can be found at the Cass County Surveyor's Office in Walker, Minnesota.

Bearing & Distance to CW 1/16 Sec. 6:
S1°20'W 5.89 chains (388.74')

September 23, 2003: J. Major and B. Thompson of Northern Lights Surveying & Mapping found the GLO 1" X 36" iron pipe with brass cap tipped slightly. They found no evidence of the bearing trees. The monument was straightened and witnessed with the following bearing trees:

4" Balsam	5 1/2" Balsam	6" Balsam
N55°W	S77°E	S33°W
19.21' to 60d spike in SW face up 1.5'	6.73' to 60d spike in South face up 0.9'	14.59' to 60d spike in SE face up 0.6'

Bearing & Distance to CW 1/16 Sec. 6:
S1°32'26"W 388.56'

The original notes are on pages 38-39, Book 1 for contract No. 53-6392-3-2 for the USFS and are on file at the Supervisor's Office of the Chippewa National Forest in Cass Lake, Minnesota. Copies are in the office of Northern Lights Surveying & Mapping in Grand Rapids, MN.

Coordinates by Static GPS :

Cass County North

Northing = 193,541.94'
Easting = 454,188.81'

State Plane Coordinate System
Minnesota Central Zone
NAD 83 (HARN 96)

Y = 1,079,302.47'
X = 2,587,166.47'

Geodetic Coordinates:

Latitude = 47° 03' 35.8983"N
Longitude = 94° 24' 01.6312"W