

CERTIFICATE OF LOCATION OF GOVERNMENT CORNER

Quarter Corner common to Sections 11 and 12, Township 142 North, Range 26 West, of the 5th Principal Meridian, Cass County, Minnesota.

July, 1997, Northern Lights Surveying and Mapping, Inc. monumented the quarter corner "lost" between the corner common to Sections 1, 2, 11, and 12 and the corner common to Sections 11, 12, 13, and 14.

SKETCH OF REFERENCE TIES & EVIDENCE

T.142N., R.26W.

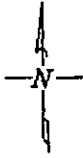

NOT TO SCALE

Bearings are Grid North Minnesota Central Zone, measured with a hand compass adjusts to 3°E East declination.

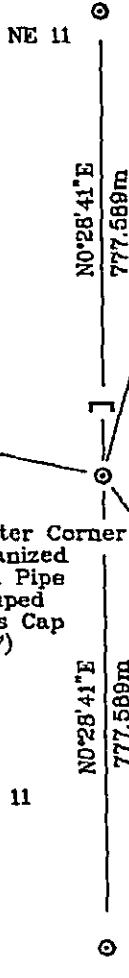

0.213m Maple
 N15°E
 14.692m to 20d nail
 in east face
 up 0.410m
 scribed S12BT
 (1997)

Steel Signpost
 North
 0.780m
 sign 54-2,
 54-9
 (1997)

0.579m Spruce
 N78°W
 9.572m to 20d nail
 in north face
 up 0.570m
 scribe S11BT
 (1997)

Quarter Corner
 Galvanized
 Steel Pipe
 Stamped
 Brass Cap
 (1997)

0.640m Spruce
 S35°E
 5.482m to 20d nail
 in NE face
 up 0.610m
 scribed S12BT
 (1997)

New bearing trees were blazed, scribed & painted red. A tag stating the bearing & distance was affixed to the tree. A nail was placed in the base of the tree and the distance was measured from the monument to the nail.

Section 11

Section 12

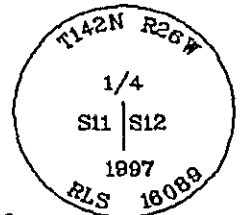

400496

Statement of evidence relative to this corner location is on the back of this page

I hereby certify that this survey, plan, or report was prepared by me or under my direct supervision and that I am a duly Licensed Land Surveyor under the laws of the State of Minnesota.

LaVerne Leuelling
 LaVerne Leuelling Date 5-20-98

Registered Land Surveyor No. 18089
 NORTHERN LIGHTS SURVEYING & MAPPING

OFFICE OF THE COUNTY RECORDER
 County of Cass

I hereby certify that this document was filed in the Recorder's office.

Time: 1:25 P. M. Date: June 1st, 1998
 Recorder Claudine Kaylor

By K.F. Deputy
 DOCUMENT NO. 400496

Statement of Evidence

Quarter Corner common to Sections 11 and 12, Township 142 North, Range 28 West, of the 5th Principal Meridian, Cass County, Minnesota.

1872; General Land Office (G.L.O.) survey notes; Deputy Surveyor E.W. Griffin set a wooden post for the quarter corner and referenced it with the following:

12" White Pine (0.305m)	4" Cedar (0.102m)
S59°E	N75°W
4 Links (0.805m)	14 Links (2.816m)

Said records are on file with the Secretary of State, St. Paul, Minnesota; handwritten copies of these notes are on file with the Cass County Surveyor's Office, Walker, Minnesota.

October 24, 1986; Northern Lights Surveying and Mapping, Inc. cruised to the approximate corner and established two search positions. No evidence of the original corner was found at this time, nor during additional searches in the fall of 1996; it was therefore declared lost.

July 23, 1997; Northern Lights Surveying and Mapping, Inc. crew of Smith and Gerving monumented the quarter corner "lost" between the corner common to Sections 1, 2, 11, and 12 and the corner common to Sections 11, 12, 13, and 14, with a 1.219m long, 0.05m diameter galvanized steel pipe with a 0.083m diameter stamped brass cap, up 0.380m. The crew established the following references:

0.640m Spruce	0.579m Spruce	0.213m Maple	Steel Signpost
S35°E	N78°W	N15°E	North
5.482m to 20d nail	9.572m to 20d nail	14.892m to 20d nail	0.780m
in NE face	in north face	in east face	sign 54-2,
up 0.610m	up 0.570m	up 0.410m	54-9
scribed S12BT	scribed S11BT	scribed S12BT	

Northern Lights Surveying and Mapping, Inc. Slater Township Field Book #2, p. 27.

Coordinates:

Cass County North

Northing = 66,776.09 meters
Easting = 174,618.51 meters

State Plane Coordinate System
Minnesota Central Zone
NAD 83

Northing = 336,769.94 meters
Easting = 824,746.33 meters

Latitude = 47°07'46.90917" North
Longitude = 93°55'25.84211" West